

MAP AND PROFILE
Showing the Change of Grades

64th, 65th, 66th, 67th, 68th, 69th, 70th, 71st, 72nd,
73rd, 74th, 75th, 76th, 77th, 78th and 79th Streets.

— Avenue A and the Exterior Street, East River.

— 80th and 81st Streets, between Avenue B and Exterior Street,
East River;—and on Avenue B, between 79th and 80th Streets.

— Under Authority of Chapter 257, Laws 1880.

J. C. O. W. H. W.
Asst. Supt. P. W.

Note.—Old Grades, shown in Black Lines and Figures.
New Grades, shown in Red Lines and Figures.
Elevations above City Base.
Distances in Lower Grades, shown in Blue.

I, Thomas F. Gilroy, Commissioner of Public Works of the City of New York, do hereby certify that under and in pursuance of the power given unto me by Chapter 257, Laws 1880, I have fixed and established the grades of 64th, 65th, 66th, 67th, 68th, 69th, 70th, 71st, 72nd, 73rd, 74th, 75th, 76th, 77th, 78th and 79th Streets, between Avenue A and the Exterior Street, East River; and the grades of 80th and 81st Streets, between Avenue B and the Exterior Street, East River; and the grades of Avenue B, between 79th and 80th Streets, in the 19th Ward of the City of New York, as shown on this map and profile; and that this map and profile shows the grades of said Streets and Avenues as fixed and established on the original map and profile on file in the Department of Public Works, bearing date the 17th day of December, 1880, of which this is a true copy.

In witness whereof I have hereunto subscribed my name this 17th day of December, 1880.

Thomas F. Gilroy
Commissioner of Public Works

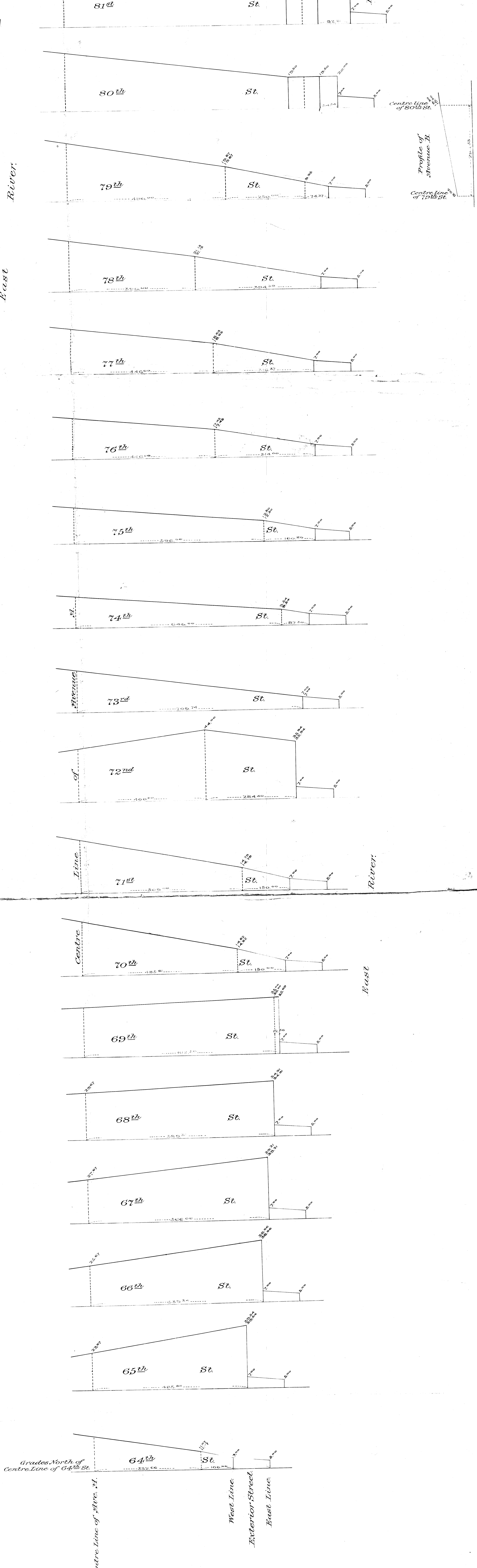
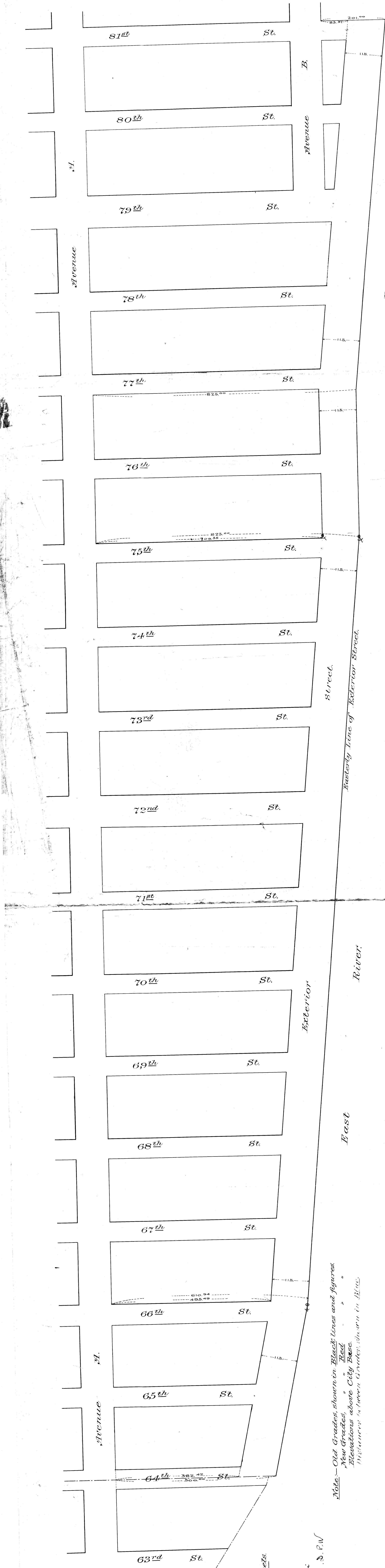

File D 55-21
XD 55-21
No. 2160

4604