

AT-GRADE PLAN SHOWING MODIFICATION TO STREET TREATMENT  
SCALE 1" = 80'

SCALE 1" = 100'

LEGEND

- INDICATES PEDESTRIAN EASEMENT LINE.
INDICATES STREET TREATMENT LINE HEREBY ELIMINATED.
INDICATES EXISTING OR NEW STREET TREATMENT LINE.
INDICATES SEWER EASEMENT LINE.
INDICATES STREET LINE OR MARGINAL STREET, WHARF OR PLACE LINE HERETOFORE ESTABLISHED AND HEREBY RETAINED.
INDICATES STREET LINE HERETOFORE ESTABLISHED AND HEREBY ELIMINATED.
INDICATES STREET LINE HEREBY ESTABLISHED.
420.00' INDICATES DIMENSION HERETOFORE ESTABLISHED AND HEREBY RETAINED.
275.00' INDICATES DIMENSION HEREBY ESTABLISHED.
+249.10' INDICATES DIMENSION HERETOFORE ESTABLISHED AND HEREBY ELIMINATED.
200' INDICATES NEW TIE-IN DIMENSION.
213.33' INDICATES TIE-IN DIMENSION HERETOFORE ESTABLISHED AND HEREBY RETAINED.
-44.42' INDICATES TIE-IN DIMENSION HERETOFORE ESTABLISHED AND HEREBY ELIMINATED.
-26.33' INDICATES STREET TREATMENT DIMENSION HEREBY ELIMINATED.
35.00' INDICATES NEW STREET TREATMENT DIMENSION.
35.00' INDICATES EASEMENT OR STREET TREATMENT DIMENSION.
ELEVATIONS REFER TO DATUM USED BY THE TOPOGRAPHICAL BUREAU, BOROUGH OF MANHATTAN, WHICH IS 2.75 FEET ABOVE THE NATIONAL GEODETIC SURVEY VERTICAL DATUM OF 1929 (UNITED STATES COAST AND GEODETIC SURVEY), MEAN SEA LEVEL, SANDY HOOK, NEW JERSEY.

CITY OF NEW YORK
OFFICE OF THE PRESIDENT BOROUGH OF MANHATTAN
MAP ACC. N° 30143

SHOWING THE ESTABLISHMENT OF AND THE ELIMINATION, DISCONTINUANCE AND CLOSING OF VOLUMES OF THE FRANKLIN DELANO ROOSEVELT DRIVE BETWEEN THE EASTERLY PROLONGATIONS OF EAST 68TH STREET AND EAST 70TH STREET AND THE MODIFICATION OF THE STREET TREATMENT IN THE VICINITY THEREOF

BOROUGH OF MANHATTAN
DATED: AUGUST 14, 1992 SCALE: AS SHOWN

RUTH MESSINGER
BOROUGH PRESIDENT
RICHARD HERSCHLAG, P.E.
BOROUGH ENGINEER

LOIS MCDANIEL, SECRETARY OF THE CITY PLANNING COMMISSION, DO HEREBY CERTIFY THAT THIS IS ONE OF EIGHT SIMILAR MAPS APPROVED BY THE CITY PLANNING COMMISSION ON THE 25TH DAY OF JANUARY, 1993 (CAL. N° 5), WHICH ACTION COMPRISED FINAL APPROVAL, AND THAT THESE MAPS WERE FILED ON THE DATE OF THIS CERTIFICATION AND WILL TAKE EFFECT ON THE FOLLOWING DAY.
DATE: NEW YORK September 24, 1993

NOTE: SEE ACC. N° 27899 FOR LEGAL GRADES AND ADDITIONAL TREATMENT.
NOTE: EASEMENTS ARE SHOWN ON THE CITY MAP FOR INFORMATIONAL PURPOSES ONLY AND ARE NOT FORMALLY PART OF THE OFFICIAL CITY MAP.

- REFERENCE MAPS
ACC. N° 30130 (DCP 910484 MMM)
ACC. N° 30119 (DCP 880670 MMM)
ACC. N° 30081 (DCP 840092 MMM)
ACC. N° 30065 (DCP 800100 MMM)
ACC. N° 30023 (CP - 22062)
ACC. N° 27970 (CP - 1241)
ACC. N° 27899 (CP - 870)

PREPARED BY EARL B. LOVELL - S. P. BELCHER, INC.
Benjamin D. Goldberg
LICENSED LAND SURVEYOR 157 CHAMBERS ST. VICE PRESIDENT NEW YORK, N.Y. 10007

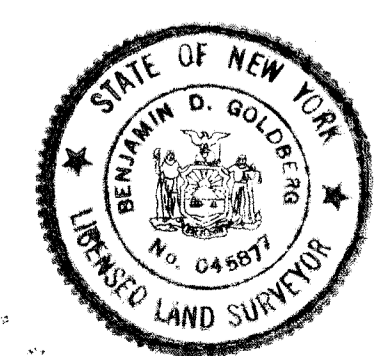

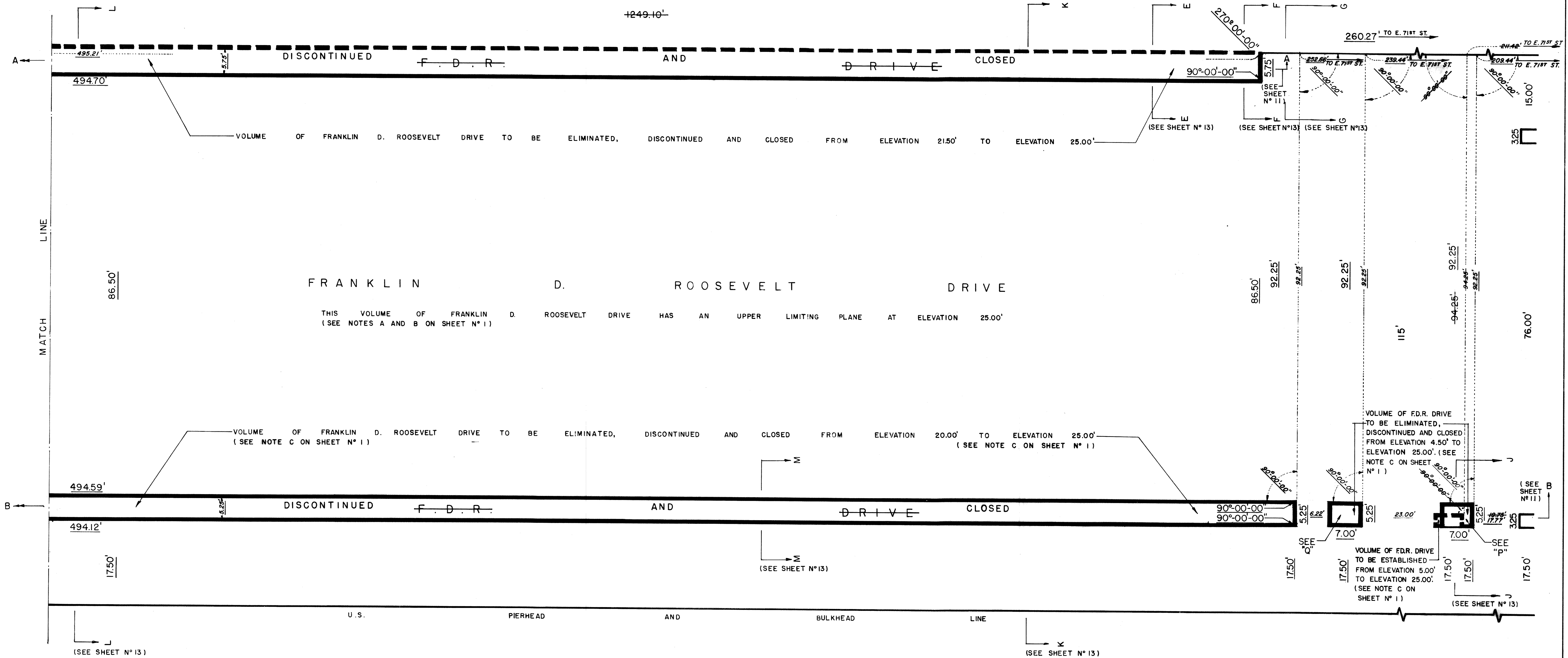

PLAN AT ELEVATION 23.00' SHOWING VOLUMES OF FRANKLIN D. ROOSEVELT DRIVE TO BE ELIMINATED, DISCONTINUED AND CLOSED.  
SCALE : 1" = 10'

