

NOTE: FOR DETAILED TREATMENT AND LEGAL GRADES SEE ACC. No 27899.  
 NOTE: EASEMENTS ARE SHOWN ON THE CITY MAP FOR INFORMATIONAL PURPOSES ONLY.

- REFERENCE MAPS**
- ACC. No 30119 (DCP 880670 MMM)
  - ACC. No 30081 (DCP 840092 MMM)
  - ACC. No 30065 (DCP 800100 MMM)
  - ACC. No 30023 (CP - 22062)
  - ACC. No 27970 (CP - 1241)
  - ACC. No 27899 (CP - 870)

PREPARED BY  
**EARL B. LOVELL - S.P. BELCHER, INC.**  
*Benjamin D. Goldberg*  
 LICENSED LAND SURVEYOR, CITY SURVEYOR, VICE PRESIDENT,  
 157 CHAMBERS ST. NEW YORK, N.Y. 10007

- LEGEND**
- INDICATES PEDESTRIAN EASEMENT LINE
  - INDICATES SEWER EASEMENT LINE
  - INDICATES STREET LINE OR MARGINAL STREET, WHARF OR PLACE LINE HERETOFORE ESTABLISHED AND HEREBY RETAINED.
  - INDICATES STREET LINE HERETOFORE ESTABLISHED AND HEREBY ELIMINATED.
  - INDICATES STREET LINE HEREBY ESTABLISHED.
  - 420.00' INDICATES DIMENSION HERETOFORE ESTABLISHED AND HEREBY RETAINED.
  - 275.00' INDICATES DIMENSION HEREBY ESTABLISHED.
  - 213.33' INDICATES TIE-IN DIMENSION HERETOFORE ESTABLISHED AND HEREBY RETAINED.
  - 200' INDICATES NEW TIE-IN DIMENSION
  - 584.25' INDICATES EASEMENT DIMENSION NOT PREVIOUSLY SHOWN
  - 35.00' INDICATES EASEMENT DIMENSION PREVIOUSLY SHOWN

ELEVATIONS REFER TO DATUM USED BY THE TOPOGRAPHICAL BUREAU, BOROUGH OF MANHATTAN, WHICH IS 2.75 FEET ABOVE THE NATIONAL GEODETIC SURVEY VERTICAL DATUM OF 1929 (UNITED STATES COAST AND GEODETIC SURVEY), MEAN SEA LEVEL, SANDY HOOK, NEW JERSEY.

CERTAIN AREAS SHOWN ON THIS MAP ARE SUBJECT TO THE TERMS OF AN AGREEMENT DATED MARCH 22, 1973, AND RECORDED IN THE OFFICE OF THE REGISTER, COUNTY OF NEW YORK, APRIL 20, 1973 REEL 475 PAGE 1397, AMONG THE CITY OF NEW YORK, THE SOCIETY OF THE NEW YORK HOSPITAL, NEW YORK SOCIETY FOR THE RELIEF OF THE RUPTURED AND CRIPPLED AND THE ROCKEFELLER UNIVERSITY.

- NOTE: MAP INTENDED TO SHOW LIMITS OF AIR RIGHTS AVAILABLE TO ADJUTING INSTITUTIONS AS SHOWN ON PLAN.
- NOTE A: NO CONSTRUCTION PERMITTED ABOVE STREET EXCEPT BY APPROVAL OF THE CITY PLANNING COMMISSION AFTER REVIEW BY CITY AGENCIES.
- NOTE B: MINIMUM VERTICAL CLEARANCE OF 17 FEET TO UNDERSIDE OF PLATFORM IS SUBJECT TO MODIFICATION AS MAY BE NECESSARY IN ORDER TO MEET REQUIRED SIGHT DISTANCES TO HIGHWAY SIGNS.
- NOTE C: CONSTRUCTION OVER PEDESTRIAN WALKWAY IS GOVERNED BY PROVISIONS OF SECTION 10 OF THE THIRD AMENDMENT (DATED AS OF MARCH 17, 1993) WHICH MODIFIES ARTICLE 12 OF THE AGREEMENT DATED MARCH 22, 1973 AMONG THE CITY OF NEW YORK, THE SOCIETY OF THE NEW YORK HOSPITAL, THE NEW YORK SOCIETY FOR THE RELIEF OF THE RUPTURED AND CRIPPLED (THE HOSPITAL FOR SPECIAL SURGERY), AND THE ROCKEFELLER UNIVERSITY.

**CITY OF NEW YORK  
 DEPARTMENT OF CITY PLANNING  
 ALTERATION TO THE CITY MAP  
 No 910484 MMM**

SHOWING  
 THE ELIMINATION, DISCONTINUANCE AND CLOSING  
 OF VOLUMES OF FRANKLIN D. ROOSEVELT DRIVE  
 BETWEEN EAST 71<sup>ST</sup> STREET AND THE PROLONGATION  
 OF EAST 70<sup>TH</sup> STREET

BOROUGH OF MANHATTAN  
 DATED: SEPTEMBER 23, 1991 SCALE: AS SHOWN  
 REVISED: JANUARY 23, 1992  
*Andrew B. Kern, P.E.*  
 CONSULTING ENGINEER  
*Paul M. Kelly*  
 DIRECTOR OF CITY PLANNING

SEWER EASEMENT

A

B

(SEE SHEET 5)

(SEE SHEET 5)

(SEE SHEET 5)

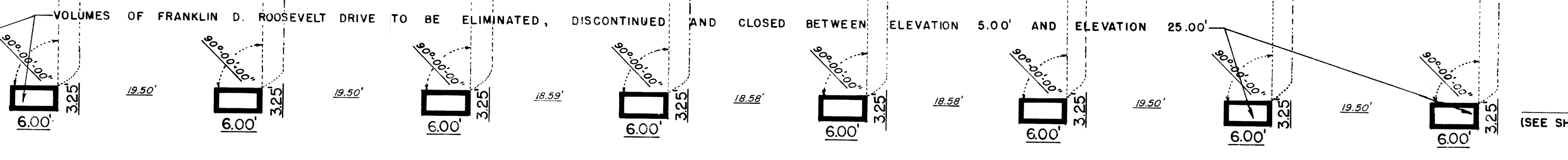
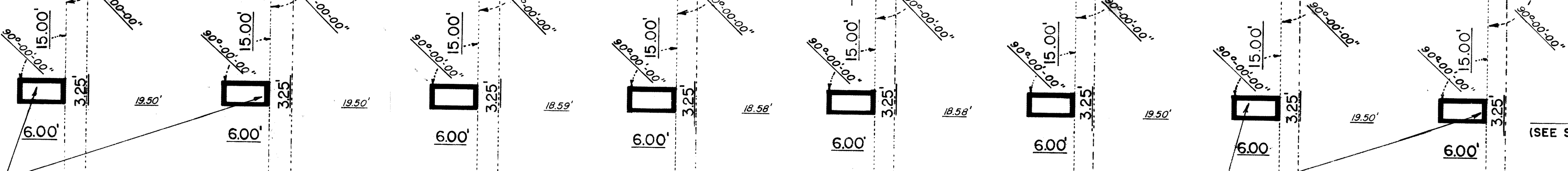

FRANKLIN D. ROOSEVELT DRIVE

THIS VOLUME OF FRANKLIN D. ROOSEVELT DRIVE HAS AN UPPER LIMITING PLANE AT ELEVATION 25.00'

U.S. PIERHEAD AND BULKHEAD LINE

PLAN AT ELEVATION 15.00' SHOWING VOLUMES OF FRANKLIN D. ROOSEVELT DRIVE TO BE ELIMINATED, DISCONTINUED AND CLOSED

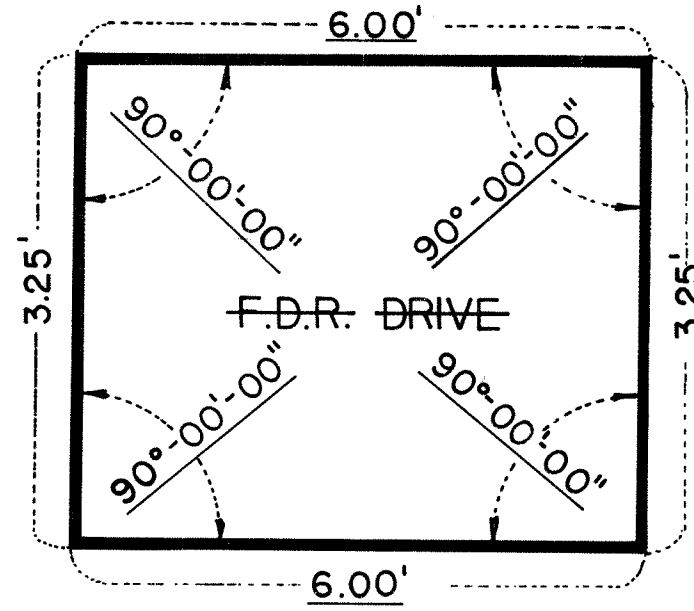

TRUE NORTH

SCALE 1" = 10'

SEWER  
EASEMENT

EAST 71<sup>ST</sup>  
STREET

611.74' TO YORK AVE.

606.39' TO YORK AVE.

TO A PT. 1249.10'

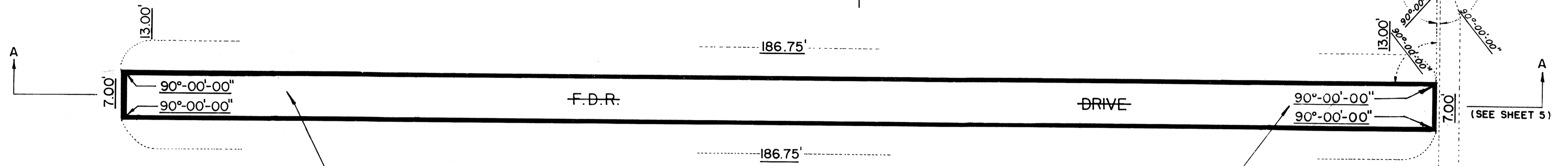

VOLUME OF FRANKLIN D. ROOSEVELT DRIVE TO BE ELIMINATED, DISCONTINUED AND CLOSED BETWEEN ELEVATION -1.33' AND ELEVATION 6.67'

FRANKLIN D. ROOSEVELT DRIVE

THIS VOLUME OF FRANKLIN D. ROOSEVELT DRIVE HAS AN UPPER LIMITING PLANE AT ELEVATION 25.00

VOLUME OF FRANKLIN D. ROOSEVELT DRIVE TO BE ELIMINATED, DISCONTINUED AND CLOSED BETWEEN ELEVATION -3.00 AND ELEVATION 5.00

F.D.R. DRIVE

U.S. PIERHEAD AND BULKHEAD LINE

PLAN AT ELEVATION 0.00' SHOWING VOLUMES OF FRANKLIN D. ROOSEVELT DRIVE TO BE ELIMINATED, DISCONTINUED AND CLOSED

TRUE NORTH

SCALE 1" = 10'

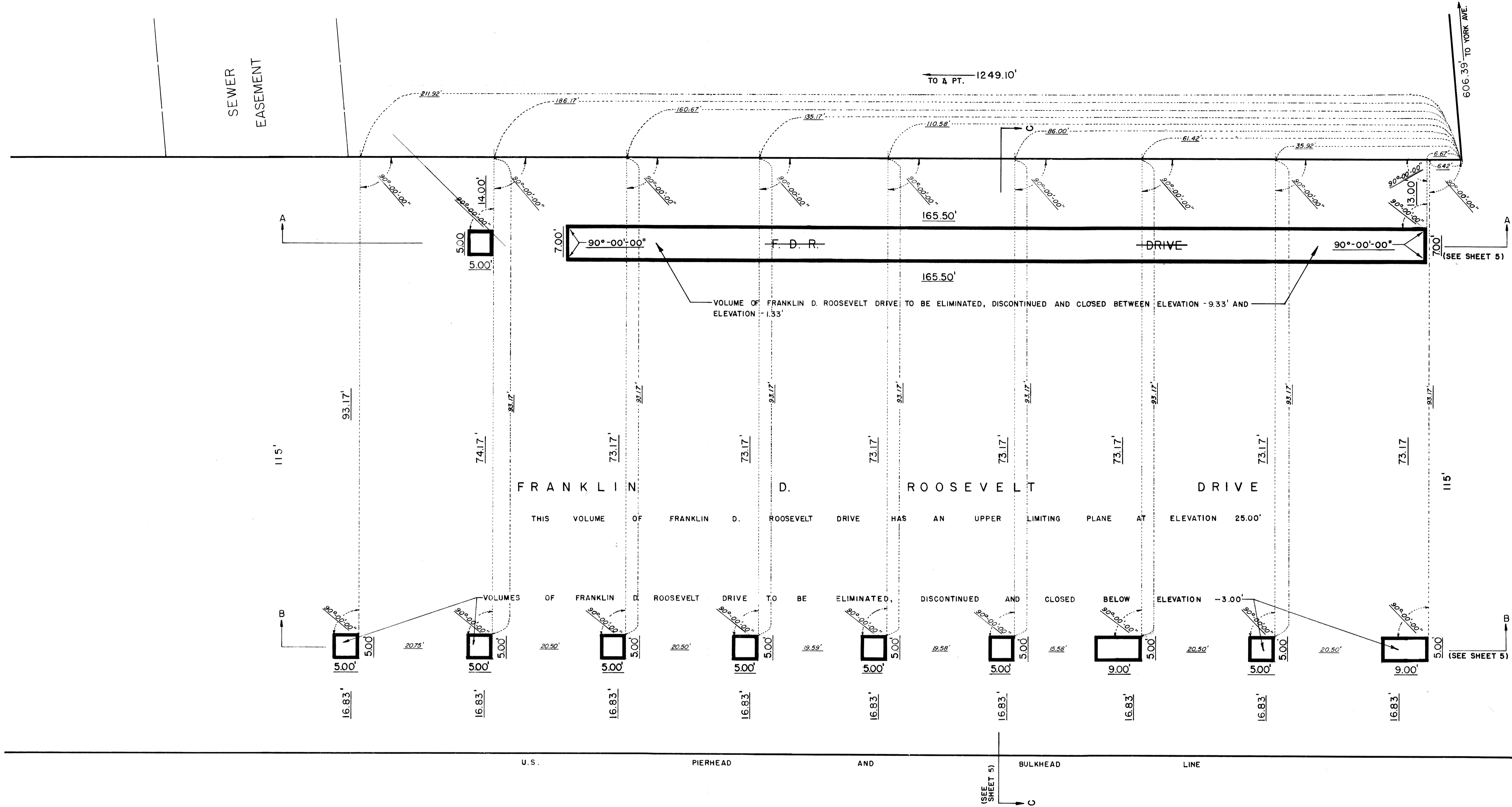

PLAN AT ELEVATION -9.00' SHOWING VOLUMES OF FRANKLIN D. ROOSEVELT DRIVE TO BE ELIMINATED, DISCONTINUED AND CLOSED

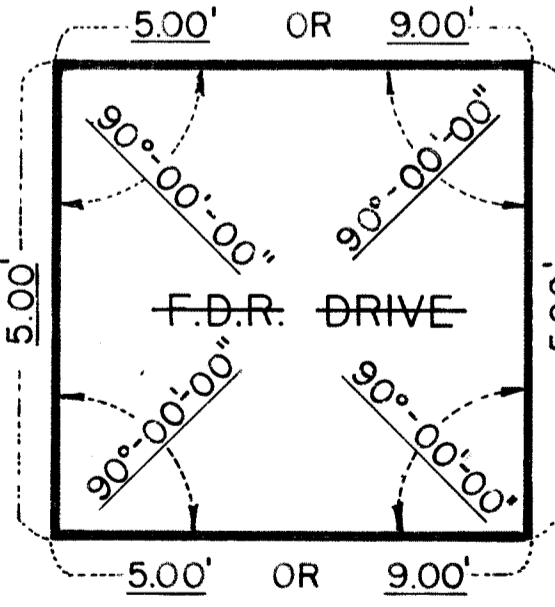

TYPICAL DETAIL (NOT TO SCALE)

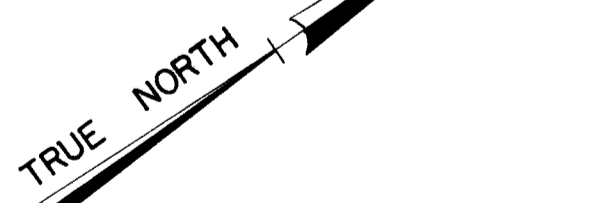

SCALE 1" = 10'

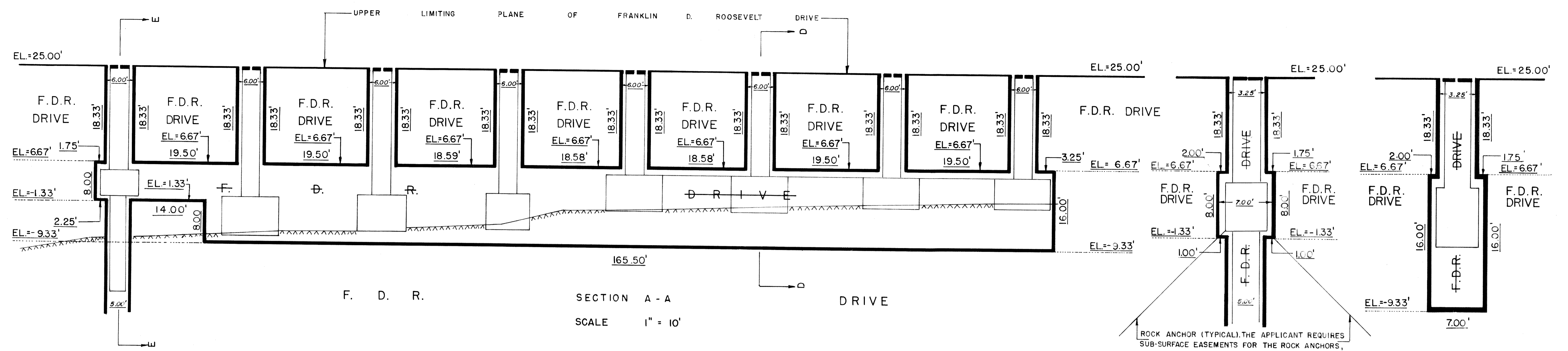

SECTION A - A  
SCALE 1" = 10'

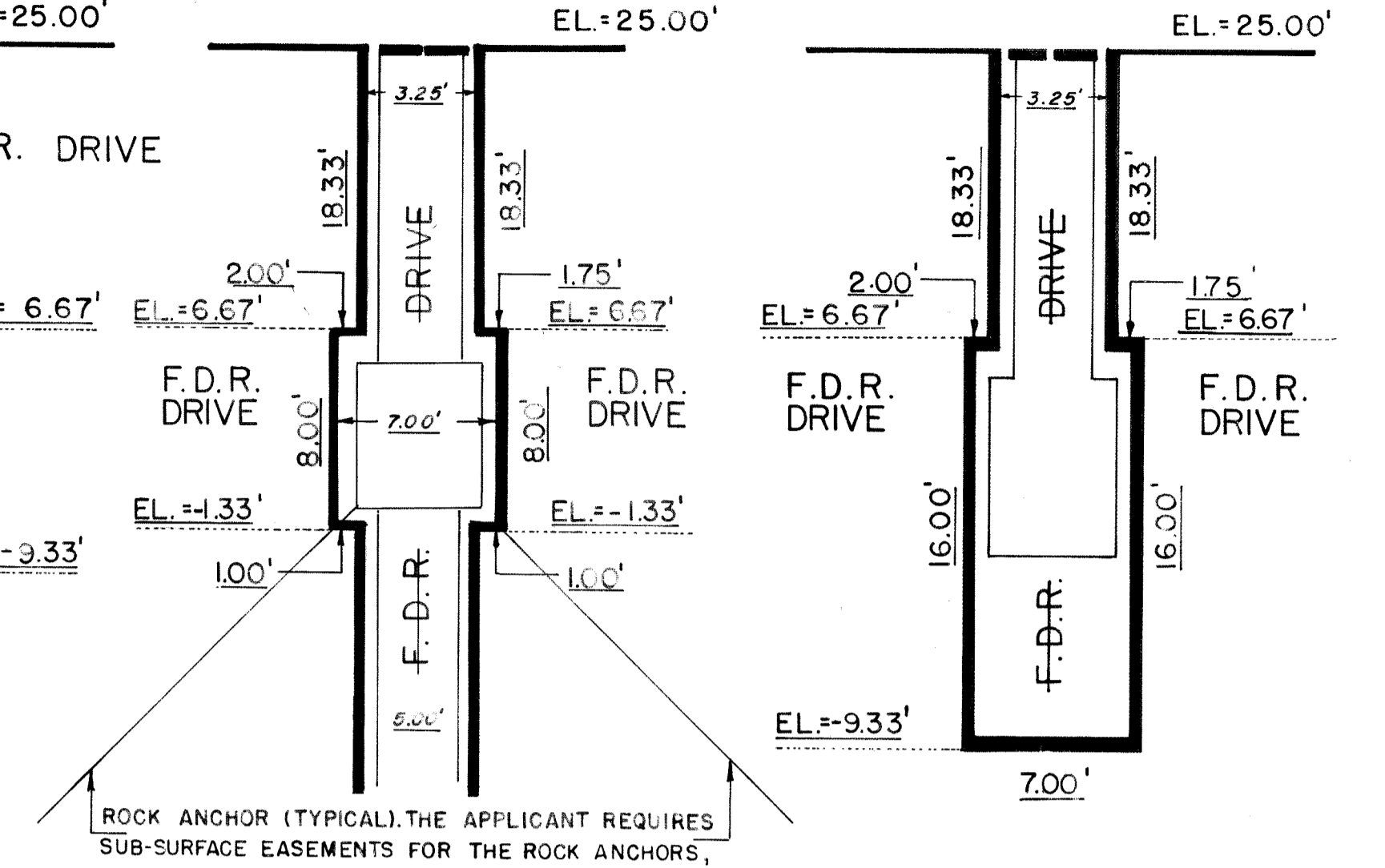

SECTION E-E  
SECTION D-D  
NOT TO SCALE

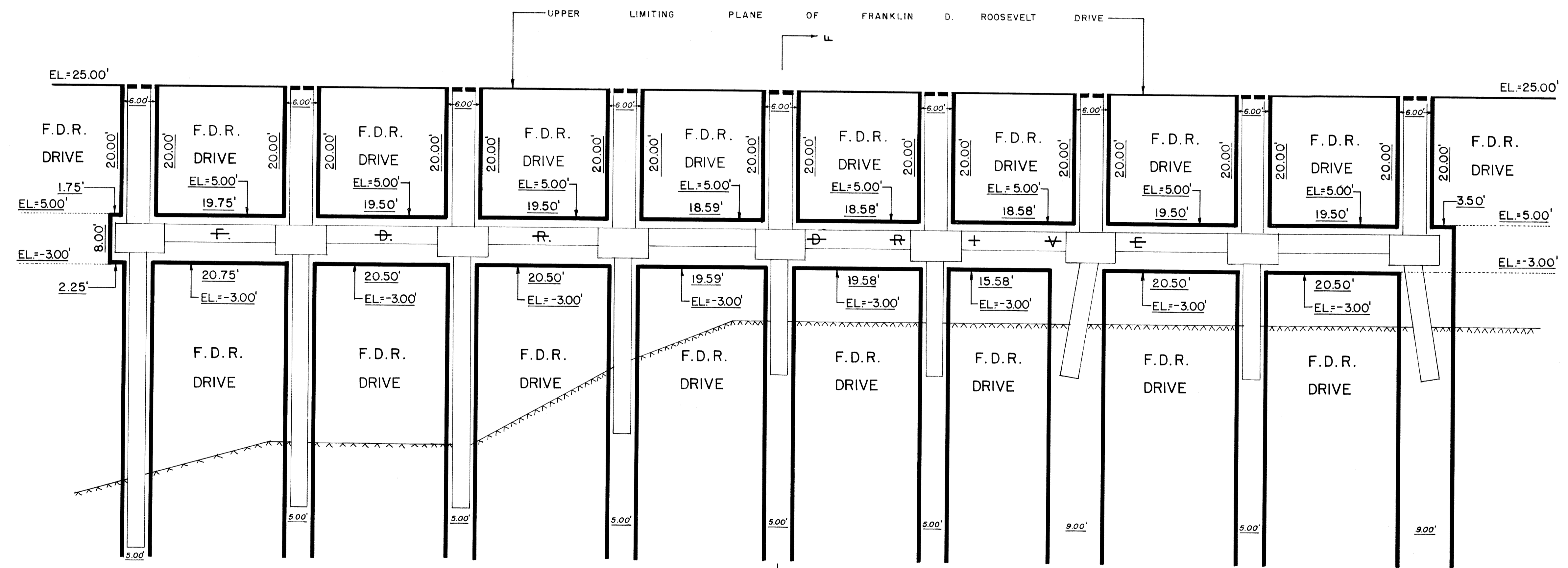

SECTION B - B  
SCALE 1" = 10'

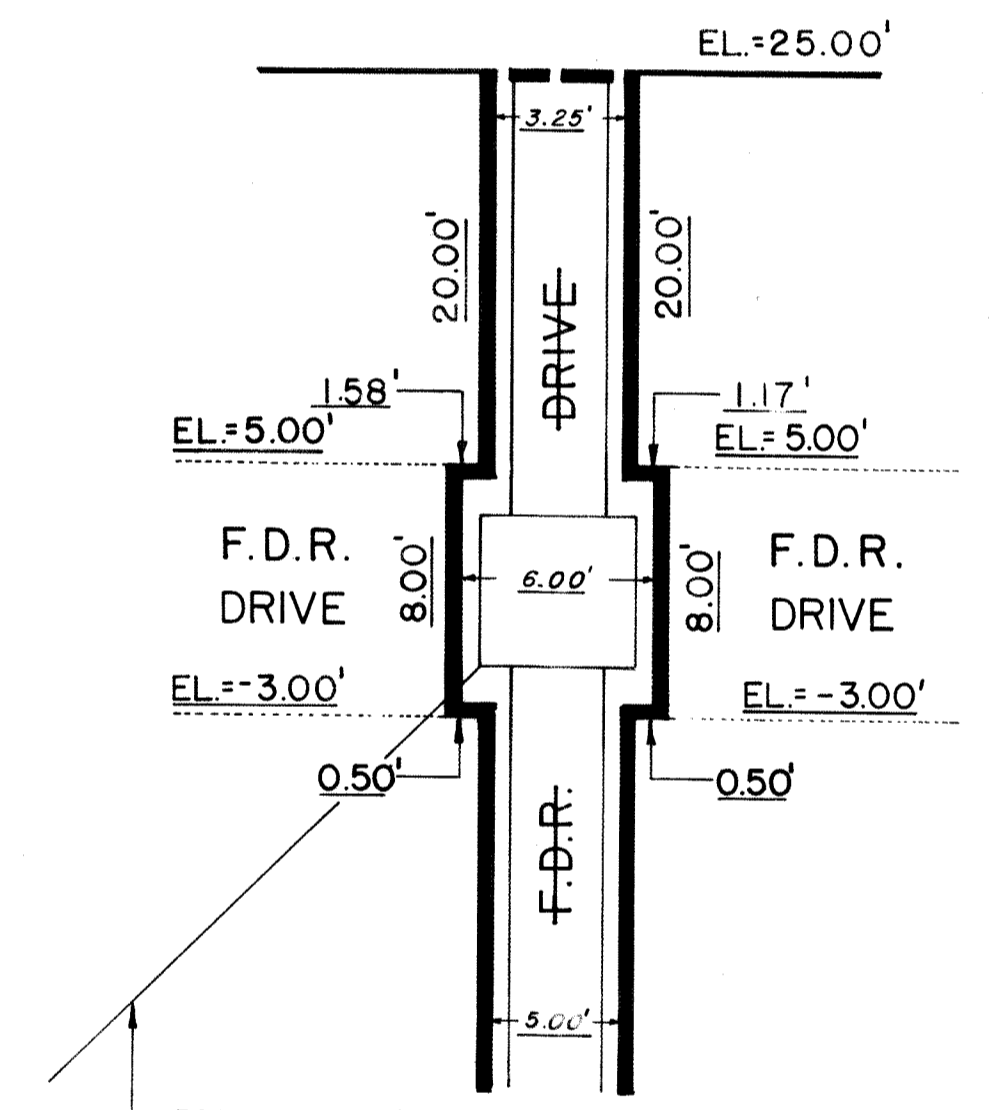

SECTION F - F  
NOT TO SCALE

NOTE:  
ALL ANGLES ARE 90°-00'-00" OR 270°-00'-00" UNLESS OTHERWISE NOTED.

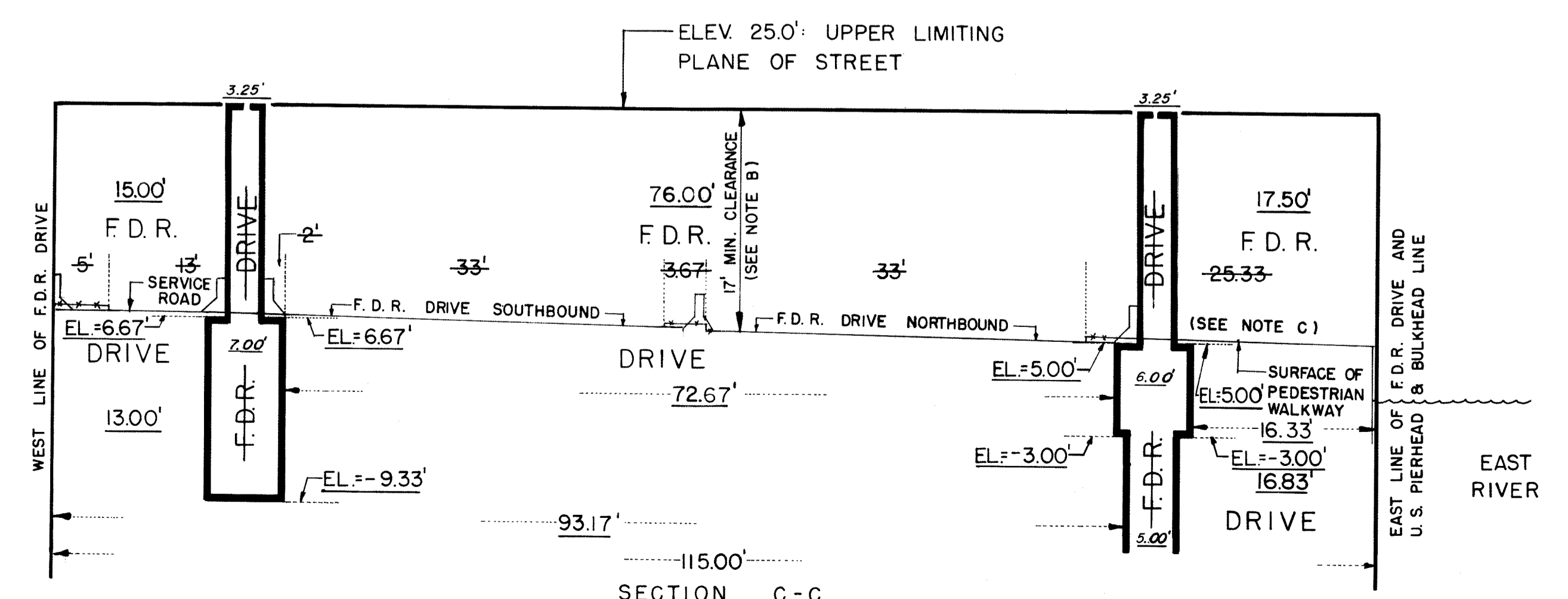

SECTION C - C  
SCALE 1" = 10'