

**NOTES**

- INDICATES STREET LINE HERETOFORE ESTABLISHED AND HEREBY RETAINED.
- INDICATES STREET LINE HERETOFORE ESTABLISHED AND HEREBY ELIMINATED.
- 100' INDICATES DIMENSION HERETOFORE ESTABLISHED AND HEREBY RETAINED.
- 145-00' INDICATES DIMENSION HERETOFORE ESTABLISHED AND HEREBY ELIMINATED.
- 150-00' INDICATES DIMENSION HEREBY ESTABLISHED
- [Hatched Box] INDICATES PARK HEREBY ESTABLISHED

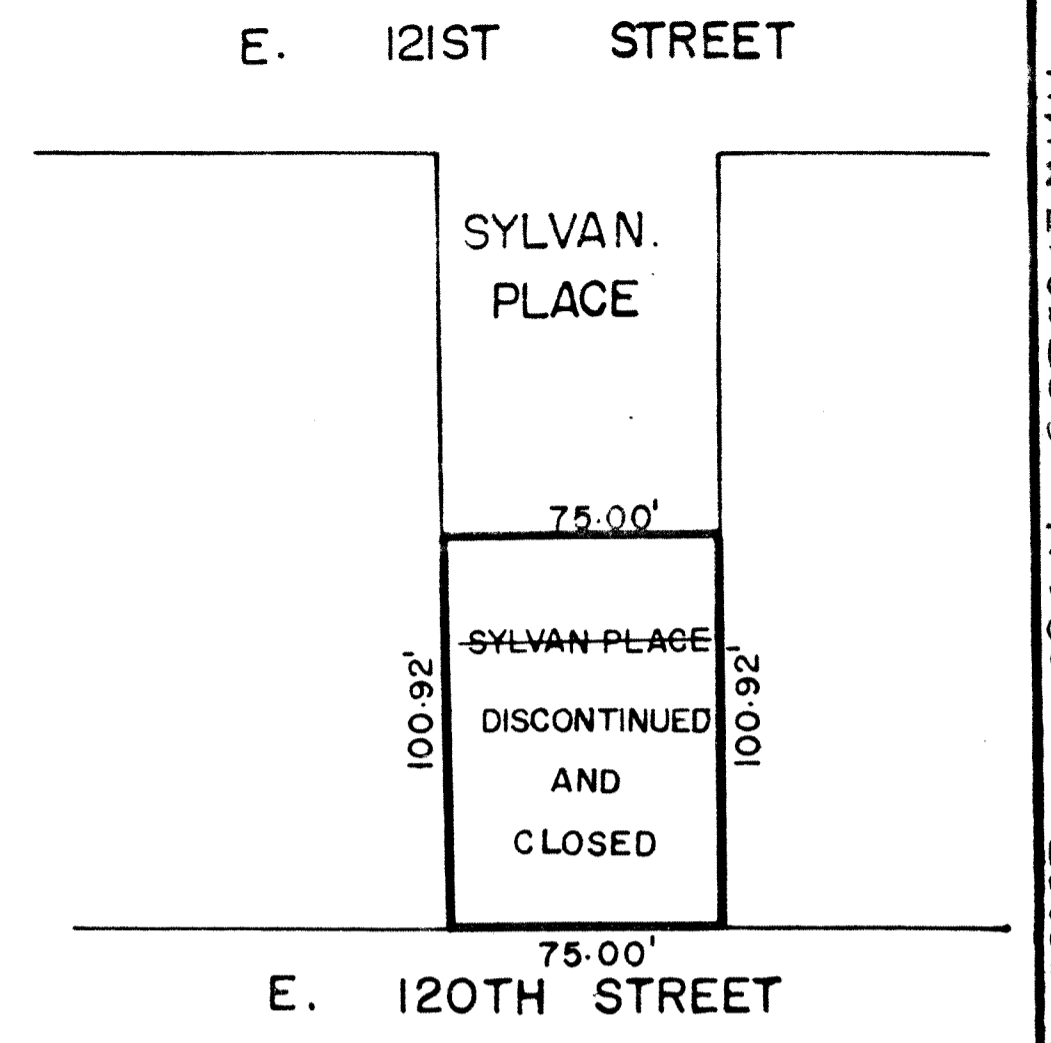
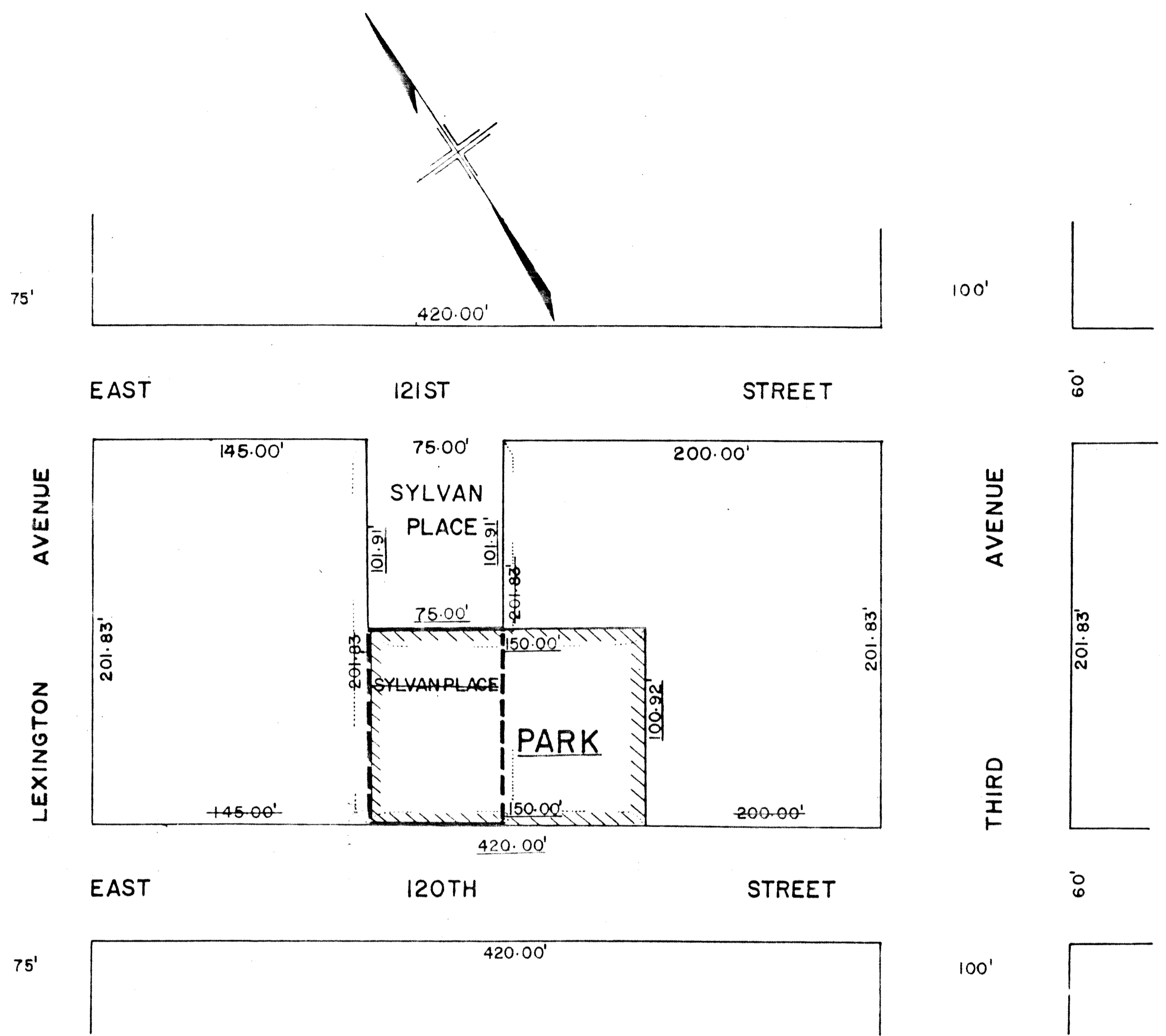

PLAN SHOWING LIMITS OF SYLVAN PLACE TO BE DISCONTINUED AND CLOSED.

CITY OF NEW YORK  
OFFICE OF THE PRESIDENT BOROUGHS OF MANHATTAN  
TOPOGRAPHICAL BUREAU

**MAP ACC. NO. 30083**  
SHOWING A CHANGE IN THE CITY MAP  
BY  
ELIMINATING, DISCONTINUING AND CLOSING  
A PORTION OF SYLVAN PLACE AS STREETS LANDS  
AND BY LAYING OUT A PARK  
IN THE AREA GENERALLY BOUNDED  
BY EAST 121 ST STREET, EAST 120TH STREET  
LEXINGTON AVENUE AND THIRD AVENUE  
BOROUGH OF MANHATTAN

I, LOIS MCDANIEL, SECRETARY OF THE CITY PLANNING COMMISSION DO HEREBY CERTIFY THAT THIS MAP IS ONE OF EIGHT SIMILAR MAPS ADOPTED BY THE CITY PLANNING COMMISSION ON THE 5<sup>th</sup> DAY OF DECEMBER, 1990 (CAL. NO. 7), and that these maps were filed on the date of this certification and will take effect on the following day.  
DATED: NEW YORK Dec. 2, 1992

*Lois McDaniel*  
SECRETARY, CITY PLANNING COMMISSION

DRAWN BY: Y.L

CHECKED BY:

DATED: SEPTEMBER 10, 1990  
SCALE: 1" = 50'  
*[Signature]*  
PRESIDENT, BOROUGH OF MANHATTAN  
DIRECTOR, TOPOGRAPHICAL BUREAU

Acc. No. 30083 CPC No. C830263 MM

Acc. No. 30083 CPC No. C830263 MM