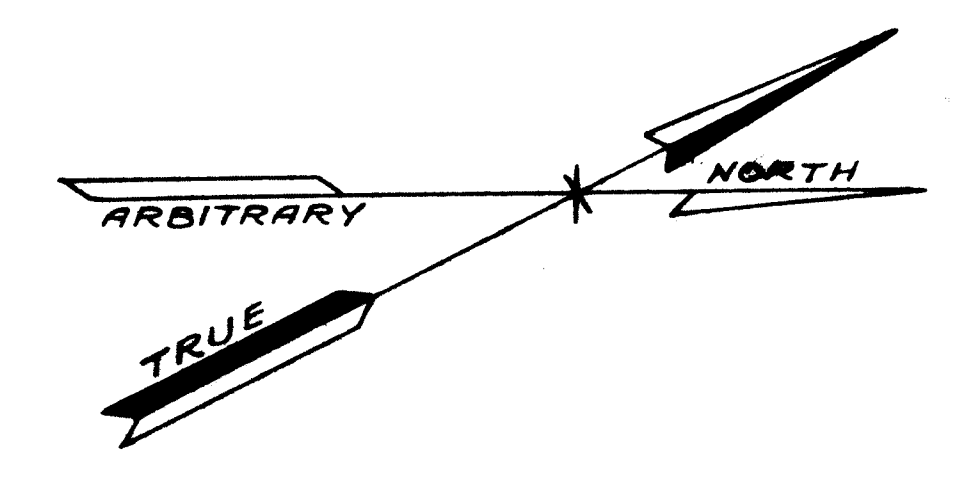
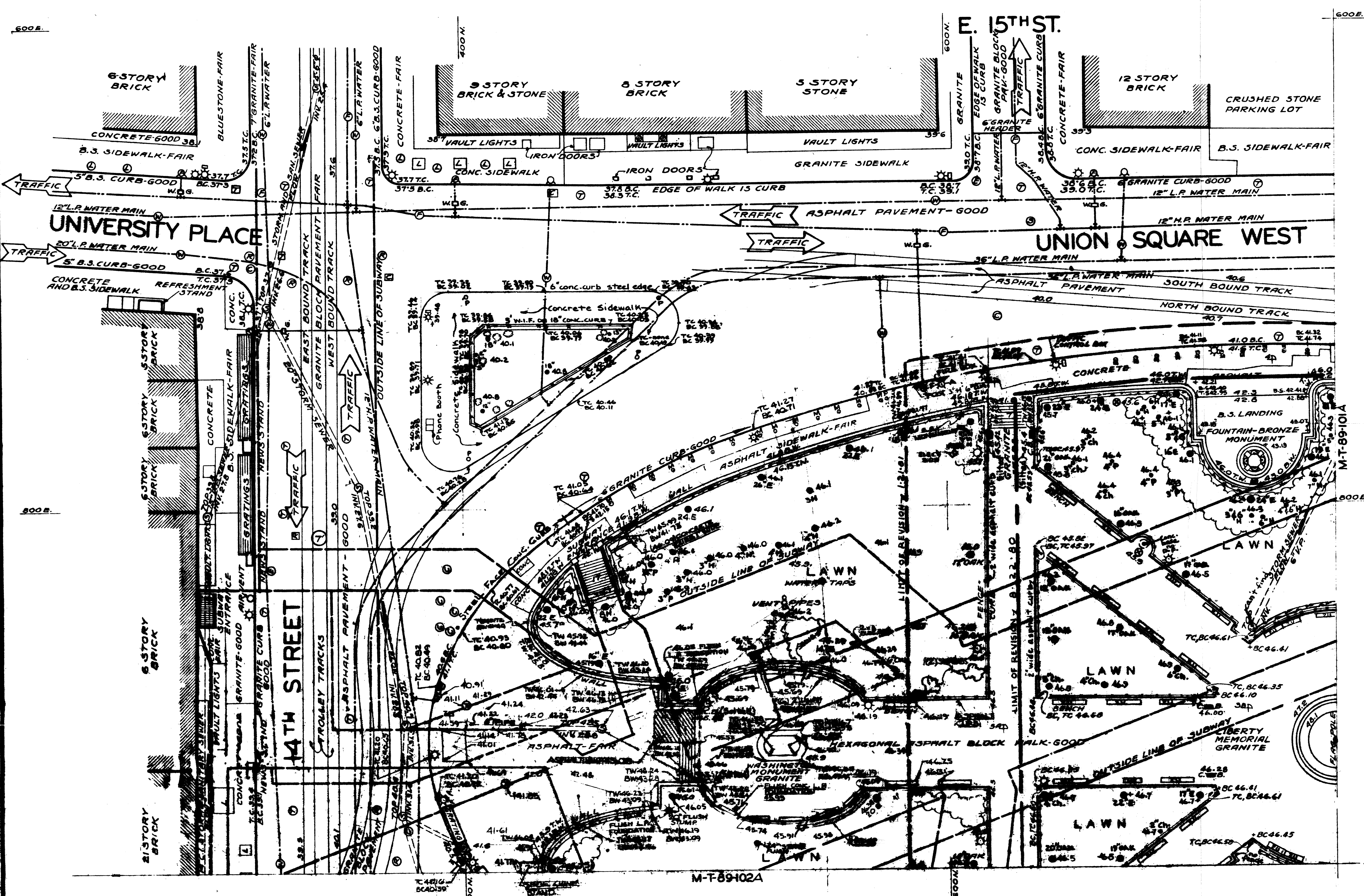

TABLE OF COORDINATES
TRAVERSE POINT COORDINATES

4	N.	735.45
	E.	741.56
5	N.	619.62
	E.	746.33
6	N.	459.07
	E.	797.41
7	N.	393.49
	E.	694.93
3A	N.	622.76
	E.	892.30
3B	N.	723.56
	E.	665.14



KEY PLAN

MT-891008	MT-89101A
MT-89102A	MT-89103A

- LEGEND**
- ⊙ DEPT. OF PUBLIC WORKS - SEWER M.H.
 - ⊙ DEPT. OF WATER SUPPLY M.H.
 - ⊙ CONS. TEL. & ELEC. SUBWAY CO. M.H.
 - ⊙ EMPIRE CITY SUBWAY CO. M.H.
 - ⊙ RAPID TRANSIT SYSTEM M.H.
 - ⊙ HIGH PRESSURE FIRE SYSTEM M.H.
 - ⊙ DRINKING FOUNTAIN
 - ⊙ DRAIN
 - ⊙ HYDRANT
 - ⊙ CATCH BASIN
 - ⊙ WATER GATE
 - ⊙ LAMP POST
 - ⊙ TRAFFIC LIGHT
 - ⊙ FIRE ALARM (ON LAMP POST)
 - ⊙ VAULT LIGHT
 - ⊙ BENCH
 - ⊙ SHRUBBERY
 - ⊙ FLOWER BED
 - ⊙ HEDGE
 - ⊙ T.C. TOP OF CURB
 - ⊙ B.C. BOTTOM OF CURB
 - ⊙ T.W. TOP OF WALL
 - ⊙ B.W. BOTTOM OF WALL
 - ⊙ TREE
 - ⊙ ELM
 - ⊙ CONC. CONCRETE
 - ⊙ B.S. BLUESTONE
 - ⊙ H.P. HIGH PRESSURE
 - ⊙ L.P. LOW PRESSURE
 - ⊙ COVER IN FEET OVER SUBWAY
 - ⊙ BASE LINE POINT - CUT
 - ⊙ V.P. VITRIFIED PIPE
 - ⊙ C.I. CAST IRON
 - ⊙ SUBWAY OUTLINE
 - ⊙ M.H. MANHOLE
 - ⊙ CH. CHERRY TREE
 - ⊙ P. PINE TREE
 - ⊙ H. HAWTHORN
 - ⊙ CR. CRABAPPLE
 - ⊙ GRANITE MONUMENT
 - ⊙ PARKING METER
 - ⊙ PARKING SIGN

NOTES

ALL ELEVATIONS SHOWN ARE BASED ON THE OFFICE OF THE BOARD PRESIDENT OF MANHATTAN DETUM WHICH IS 2820' ABOVE U.S. CONST. & GEODATIC SURVEY POINT BY JERRY HOOK. B.M. 468-EL. 45.98'-TOP OF 18" COPPER BOLT LEADS HORIZONTALLY TO CORNER GRANITE BLOCK AT S.W. CORNER DRAYTON SQUARE SAVINGS BANK AT NE. CORNER OF 15TH ST. AND 4TH AVE. B.M. IS ON 4TH AVE. SIDE, 1' FROM BOTH S. AND N. EDGES OF STONE, AND 34" FROM 15TH ST. FACE OF BUILDING. ORIGIN OF COORDINATES IS ASSUMED AND APPLICABLE TO THIS PARK ONLY. CURB DIMENSIONS INDICATE WIDTH OF CURB. WALLS BOUNDING PARK ARE 15" WIDE MASONRY WITH GRANITE COPINGS. WALKS INSIDE OF PARK ARE BOUNDED BY 3" HIGH PIPE RAIL FENCE BACK ON 2" x 2" ASPHALT BLOCK CURB. WALKS WITHIN PARK AREA ARE HEXAGONAL ASPHALT BLOCK-GOOD.

REVISIONS

DATE	BY	REVISION
8/22/80	J.C.	UPDATED WITHIN REVISION LINES
1-24/81	J.C.	UPDATED WITHIN REVISION LINES
9-30-81	LR	UPDATED

SURVEYED BY J. Phillips
DRAWN BY E. Simpson
TRACED BY S. Sutton
CHECKED BY E. Holmes
FIELD CHECKED BY E. Brown

Prof. M. Maclean
TOPOGRAHICAL ENGINEER BOARD OF MANHATTAN
CHIEF TOPOGRAHICAL ENGINEER

CITY OF NEW YORK
DEPARTMENT OF PARKS
TOPOGRAPHICAL DIVISION
TOPOGRAPHICAL MAP
PORTION OF
UNION SQUARE
BORO OF MANHATTAN
SCALE IN FEET
SEPT. 23, 1935

DESIGNED BY	PREPARED BY	CHECKED BY
DRAWN BY	APPROVED BY	DATE
REVISIONS		

TABLE OF COORDINATES
TRAVERS POINT COORDINATES

2	N.	1000.00
	E.	771.43
3	N.	301.09
	E.	766.66
34	N.	301.47
	E.	889.71
3C	N.	812.59
	E.	941.09

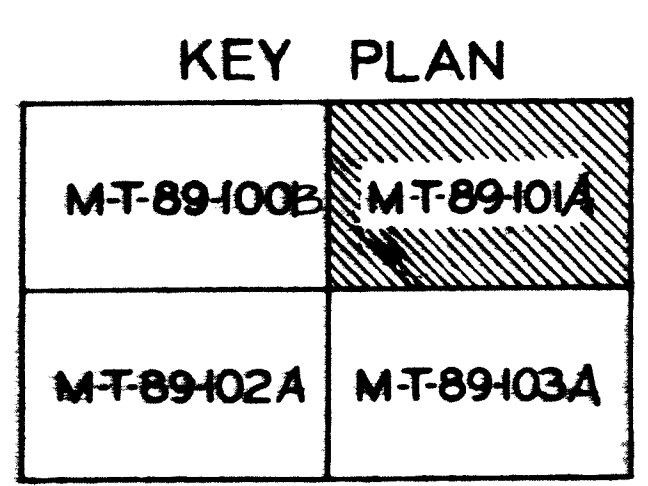
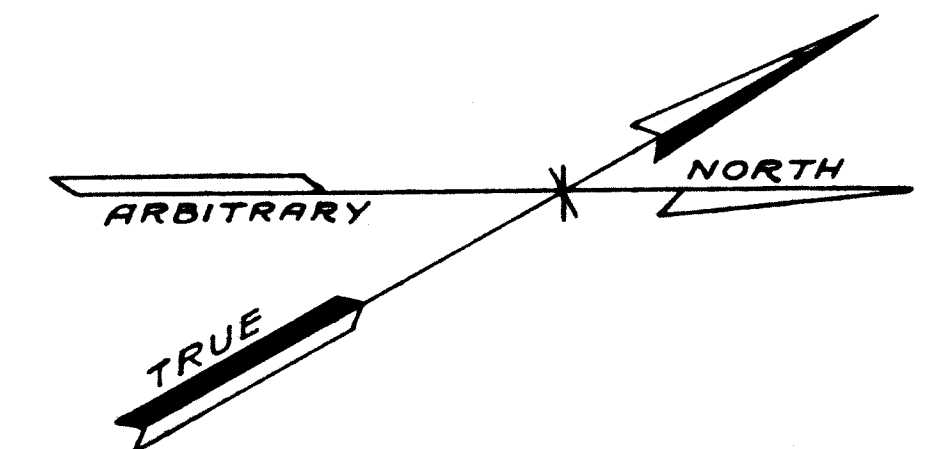
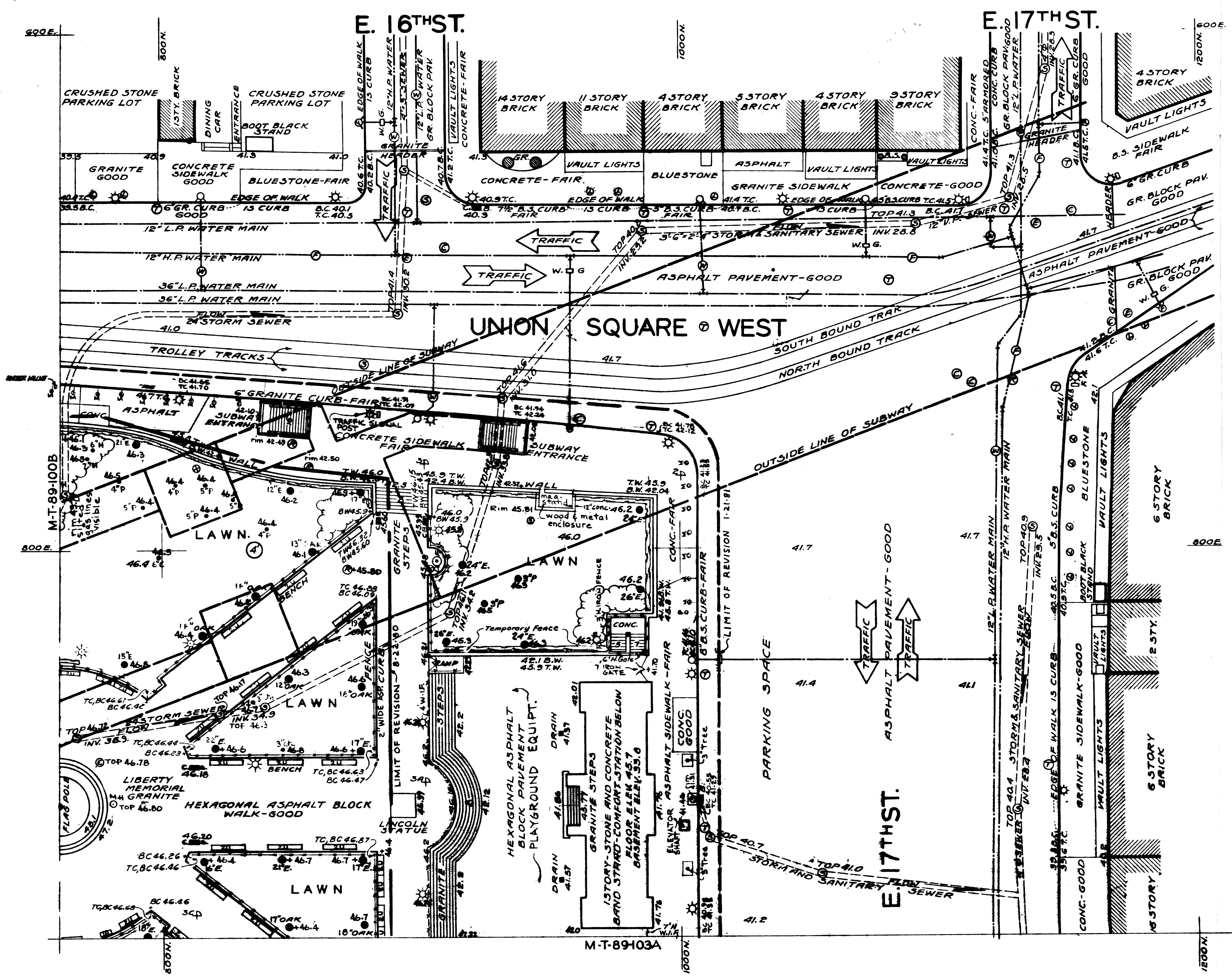

- LEGEND**
- ⊙ DEPT. OF PUBLIC WORKS - SEWER M.H.
 - ⊙ DEPT. OF WATER SUPPLY M.H.
 - ⊙ CONS. TEL. & ELEC. SUBWAY CO. M.H.
 - ⊙ EMPIRE CITY SUBWAY CO. M.H.
 - ⊙ RAPID TRANSIT SYSTEM M.H.
 - ⊙ HIGH PRESSURE FIRE SYSTEM M.H.
 - ⊙ DRINKING FOUNTAIN
 - ⊙ DRAIN
 - ⊙ HYDRANT
 - ⊙ CATCH BASIN
 - ⊙ WATER GATE
 - ⊙ LAMP POST
 - ⊙ TRAFFIC LIGHT
 - ⊙ FIRE ALARM (ON LAMP POST)
 - ⊙ VAULT LIGHT
 - ⊙ BENCH
 - ⊙ SHRUBBERY
 - ⊙ HEDGE
 - ⊙ TOP OF CURB
 - ⊙ BOTTOM OF CURB
 - ⊙ TOP OF WALL
 - ⊙ BOTTOM OF WALL
 - ⊙ TREE
 - ⊙ ELM
 - ⊙ CONCRETE
 - ⊙ BLUESTONE
 - ⊙ GRANITE
 - ⊙ HIGH PRESSURE
 - ⊙ LOW PRESSURE
 - ⊙ COVER IN FEET OVER SUBWAY
 - ⊙ BASE LINE POINT-CUT
 - ⊙ SUBWAY OUTLINE
 - ⊙ M.H.
 - ⊙ CH.
 - ⊙ P.
 - ⊙ H.
 - ⊙ C.
 - ⊙ 3" PIPE RAIL FENCE
 - ⊙ PARKING METER
 - ⊙ PARKING SIGN

NOTES

ALL ELEVATIONS SHOWN ARE BASED ON THE "OFFICE OF THE BORO PRESIDENT OF MANHATTAN" DATUM WHICH IS 2750' ABOVE U.S. COAST & GEODETIC SURVEY DATUM AT SANDY HOOK.

B.M. 462 - 41.46.306 - TOP OF 58" COPPER BOLT LEAD VERTICALLY INTO LARGE GRANITE BLOCK AT S.W. CORNER OF UNION SQUARE 'SAVINGS BANK' AT N.E. CORNER OF 15TH ST. AND 4TH AVE.

B.M. 15 ON 4TH AVE. SIDE, 1' FROM BOTH S. AND W. EDGES OF STONE, AND 34" FROM 15TH ST. FACE OF BUILDING.

ORIGIN OF COORDINATES IS ASSUMED AND APPLICABLE TO THIS PARK ONLY.

GOOD, FAIR OR POOR INDICATE CONDITION.

CURB DIMENSIONS INDICATE WIDTH OF CURB.

WALLS BOUNDING PARK ARE 1.5' WIDE MASONRY WITH GRANITE COPING.

WALKS INSIDE OF PARK ARE BOUNDED BY 3" HIGH PIPE RAIL FENCE BACK OF 2" x 2" ASPHALT BLOCK CURB.

WALKS WITHIN PARK AREA ARE HEXAGONAL ASPHALT BLOCK-6000

REVISIONS

DATE	BY	REVISION
8/22/80	J.C.	UPDATED WITHIN REVISION LINES
1-21-81	J.C.	UPDATED WITHIN REVISION LINES

SURVEYED BY J. Phillips
DRAWN BY E. Simpson
TRACED BY S. Simon
CHECKED BY F. Morris
FIELD CHECKED BY P. Brown

Red M. Wickham
TOPOGRAPHICAL ENGINEER - BORO OF MANHATTAN
J. J. Sullivan
CHIEF TOPOGRAPHICAL ENGINEER

CITY OF NEW YORK
DEPARTMENT OF PARKS
TOPOGRAPHICAL DIVISION
TOPOGRAPHICAL MAP
PORTION OF
UNION SQUARE
BORO OF MANHATTAN
SCALE IN FEET
SEPT. 23, 1936

DRAWN BY	PREPARED BY	DRAWING NO.
CHECKED BY	APPROVED BY	
COORDINATED BY	APPROVED BY	SCALE
DATE	APPROVED BY	
CITY OF NEW YORK DEPARTMENT OF PARKS		

TABLE OF COORDINATES
TRANSVERSE POINT COORDINATES

B	N.	433.28
	E.	363.77
9	N.	536.85
	E.	1032.17
10	N.	626.29
	E.	1048.02
A	N.	355.03
	E.	1027.07
B	N.	394.70
	E.	1136.33
C	N.	479.33
	E.	1079.56

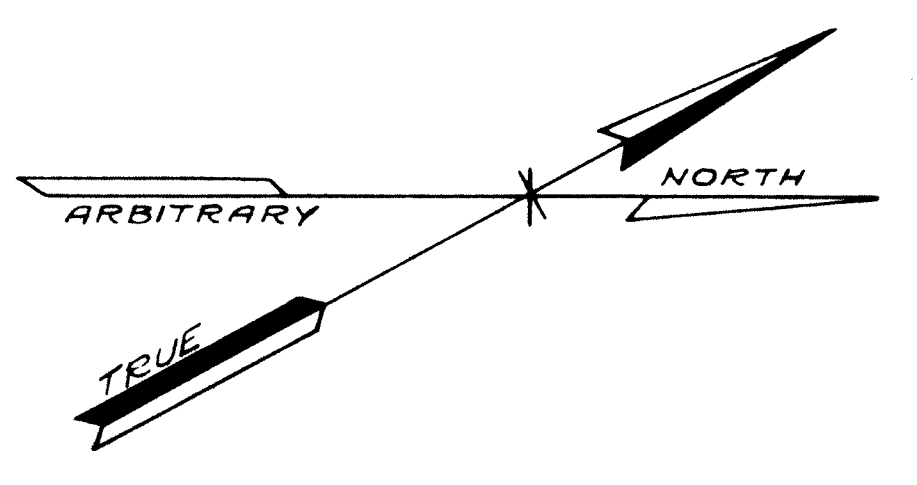
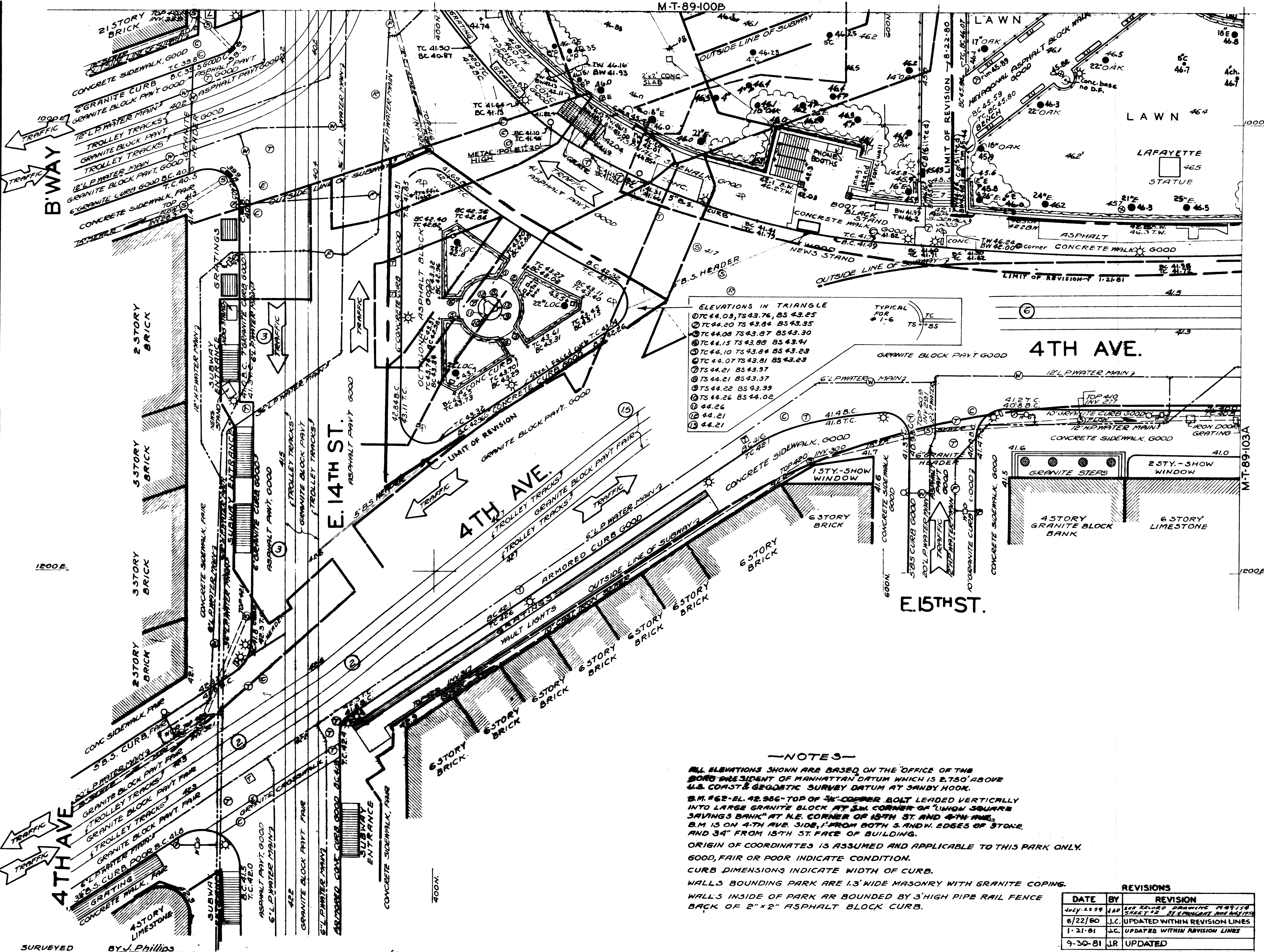

KEY PLAN

M-T89-100B	M-T89-101A
M-T89-102A	M-T89-103A

- LEGEND**
- DEPT. OF PUBLIC WORKS - SEWER M.H.
 - DEPT. OF WATER SUPPLY M.H.
 - CONS. TEL. & ELEC. SUBWAY CO. M.H.
 - EMPIRE CITY SUBWAY CO. M.H.
 - RAPID TRANSIT SYSTEM M.H.
 - HIGH PRESSURE FIRE SYSTEM M.H.
 - DRINKING FOUNTAIN
 - DRAIN
 - HYDRANT
 - C.B. CATCH BASIN
 - W.G. WATER GATE
 - L.P. LAMP POST
 - T.L. TRAFFIC LIGHT
 - V.L. VAULT LIGHT
 - B. BENCH
 - S. SHRUBBERY
 - H. HEDGE
 - T.C. TOP OF CURB
 - B.C. BOTTOM OF CURB
 - T.W. TOP OF WALL
 - B.W. BOTTOM OF WALL
 - T. TREE
 - E. ELM
 - L. LOCUST
 - B.S. BLUESTONE
 - H.P. HIGH PRESSURE
 - L.P. LOW PRESSURE
 - B.P. BASE LINE POINT - CUT
 - C. COVER IN FEET OVER SUBWAY
 - S. SUBWAY OUTLINE
 - M.H. MANHOLE
 - Ch. CHERRY TREE
 - P. PINE TREE
 - H. HAWTHORN
 - C. CRABAPPLE

NOTES

ALL ELEVATIONS SHOWN ARE BASED ON THE OFFICE OF THE BOARD PRESIDENT OF MANHATTAN DATUM WHICH IS 2.750' ABOVE U.S. COAST & GEODETIC SURVEY DATUM AT SANDY HOOK.

B.M. #62-EL. 42.986 - TOP OF 3/4" COPPER BOLT LEADED VERTICALLY INTO LARGE GRANITE BLOCK AT SW CORNER OF UNION SQUARE SAVING'S BANK AT N.E. CORNER OF 15TH ST. AND 6TH AVE. B.M. IS ON 4TH AVE. SIDE, 1' FROM BOTH S. AND N. EDGES OF STONE, AND 34" FROM 15TH ST. FACE OF BUILDING.

ORIGIN OF COORDINATES IS ASSUMED AND APPLICABLE TO THIS PARK ONLY.

GOOD, FAIR OR POOR INDICATE CONDITION.

CURB DIMENSIONS INDICATE WIDTH OF CURB.

WALLS BOUNDING PARK ARE 1.5' WIDE MASONRY WITH GRANITE COPING.

WALLS INSIDE OF PARK ARE BOUNDED BY 3" HIGH PIPE RAIL FENCE BACK OF 2' x 2' ASPHALT BLOCK CURB.

REVISIONS

DATE	BY	REVISION
JULY 1914	J.R.	SEE REVISIONS DRAWING REVISED
8/22/80	J.C.	UPDATED WITH REVISION LINES
1-21-81	J.C.	UPDATED WITH REVISION LINES
9-30-81	J.R.	UPDATED

SURVEYED BY V. Phillips
DRAWN BY E. Simpson
TRACED BY S. Simon
CHECKED BY F. Holmes
FIELD CHECKED BY P. Deane

Robert W. Mackenzie
TOPOGRAPHICAL ENGINEER - BORO OF MANHATTAN

A. H. Anderson
CHIEF TOPOGRAPHICAL ENGINEER

CITY OF NEW YORK
DEPARTMENT OF PARKS
TOPOGRAPHICAL DIVISION
TOPOGRAPHICAL MAP
PORTION OF
UNION SQUARE
BORO OF MANHATTAN
SCALE IN FEET
0 20 40
SEPT. 23, 1935

DESIGNED BY	PREPARED BY	DRAWING NO.
CHECKED BY	APPROVED BY	
COORDINATED BY		SCALE
DATE	EXPANDED BY	

CITY OF NEW YORK
DEPARTMENT OF PARKS

TABLE OF COORDINATES
TRAVERSE POINT-COORDINATES

I	N. 1000.00
	E. 1000.00
II	N. 841.42
	E. 1045.27

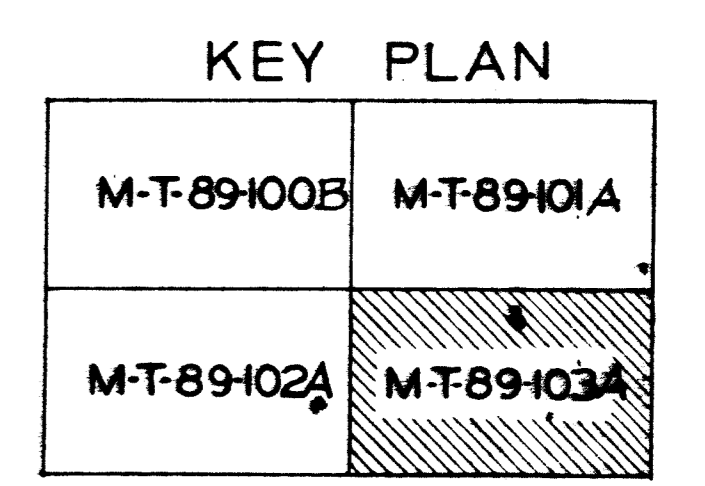
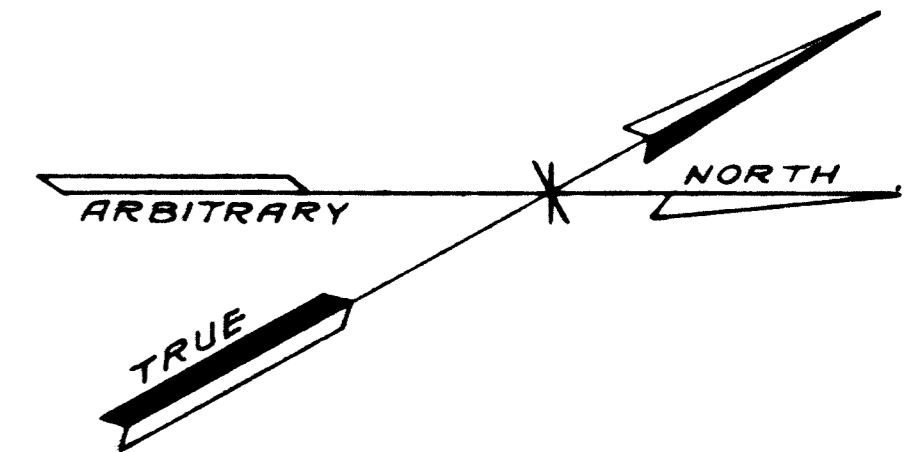
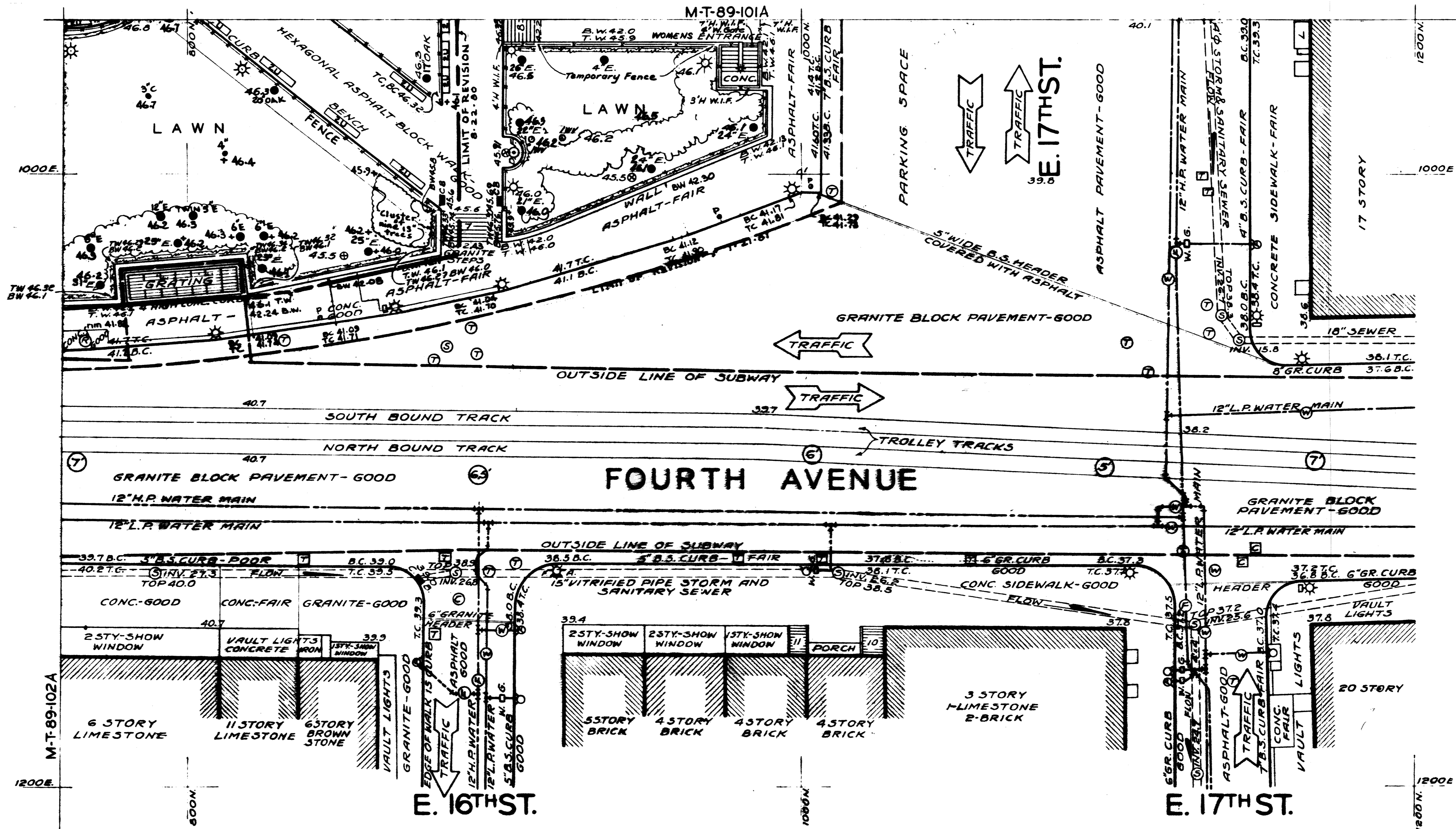

- LEGEND**
- ⊙ DEPT. OF PUBLIC WORKS - SEWER M.H.
 - ⊙ DEPT. OF WATER SUPPLY M.H.
 - ⊙ CONG. TEL. & ELEC. SUBWAY CO. M.H.
 - ⊙ EMPIRE CITY SUBWAY CO. M.H.
 - ⊙ RAPID TRANSIT SYSTEM M.H.
 - ⊙ HIGH PRESSURE FIRE SYSTEM M.H.
 - ⊙ DRINKING FOUNTAIN
 - ⊙ DRAIN
 - ⊙ HYDRANT
 - ⊙ C.B. CATCH BASIN
 - ⊙ W.G. WATER GATE
 - ⊙ LAMP POST
 - ⊙ TRAFFIC LIGHT
 - ⊙ VAULT LIGHT
 - ⊙ BRUSH
 - ⊙ SHRUBBERY
 - ⊙ HEDGE
 - T.C. TOP OF CURB
 - B.C. BOTTOM OF CURB
 - T.W. TOP OF WALL
 - B.W. BOTTOM OF WALL
 - TREE
 - ELM
 - CONC. CONCRETE
 - B.S. BLUESTONE
 - H.P. HIGH PRESSURE
 - L.P. LOW PRESSURE
 - ⊕ COVER IN FEET OVER SUBWAY
 - ⊕ BASE LINE POINT-CUT
 - SUBWAY OUTLINE
 - F.A. FIRE ALARM (ON LAMP POST)
 - GR. GRANITE
 - M.H. MANHOLE
 - Ch CHERRY TREE
 - P PINE
 - H HAWTHORN
 - C CRABAPPLE
 - WY WATER WHEEL
 - S PARK NO. SIGN

NOTES

ALL ELEVATIONS SHOWN ARE BASED ON THE OFFICE OF THE BORO PRESIDENT OF MANHATTAN DATUM WHICH IS 8.750' ABOVE U.S. COAST & GEODETIC SURVEY DATUM AT SANDY HOOK.

B.M. #2 - EL. 42.966 - TOP OF 3/4" CORNER BOLT LEANED VERTICALLY INTO LARGE GRANITE BLOCK AT S.W. CORNER OF UNION SQUARE SAVINGS BANK AT N.E. CORNER OF 15TH ST. AND 4TH AVE. B.M. IS ON 4TH AVE. SIDE, 1' FROM BOTH S. AND W. EDGES OF STONE, AND 34" FROM 15TH ST. FACE OF BUILDING.

ORIGIN OF COORDINATES IS ASSUMED AND APPLICABLE TO THIS PARK ONLY.

GOOD, FAIR OR POOR INDICATE CONDITION.

CURB DIMENSIONS INDICATE WIDTH OF CURB.

WALLS BOUNDING PARK ARE 1 1/2" WIDE MASONRY WITH GRANITE COPING.

WALKS INSIDE OF PARK ARE BOUNDED BY 3" HIGH PIPE RAIL FENCE BACK OF 2' x 2' ASPHALT BLOCK CURB.

WALKS WITHIN PARK AREA, HEXAGONAL ASPHALT BLOCK - GOOD

REVISIONS

DATE	BY	REVISION
8/22/80	J.C.	UPDATED WITHIN REVISION LINES
1/21/81	J.C.	UPDATED WITHIN REVISION LINES

SURVEYED BY J. Phillips
DRAWN BY E. Simpson
TRACED BY S. Simms
CHECKED BY A. Holmes
FIELD CHECKED BY P. Brown

Paul M. Anderson
TOPOGRAPHICAL ENGINEER, BORO OF MANHATTAN
P. M. Anderson
CHIEF TOPOGRAPHICAL ENGINEER

CITY OF NEW YORK
DEPARTMENT OF PARKS
TOPOGRAPHICAL DIVISION
TOPOGRAPHICAL MAP
PORTION OF
UNION SQUARE
BORO OF MANHATTAN

SCALE IN FEET 0 20 40
SEPT. 23, 1935.

DATE	BY	REVISION

CITY OF NEW YORK
DEPARTMENT OF PARKS