

COLUMBIA STREET

COLUMBIA STREET

COLUMBIA STREET

COLUMBIA STREET

DELANCY STREET

DELANCY STREET

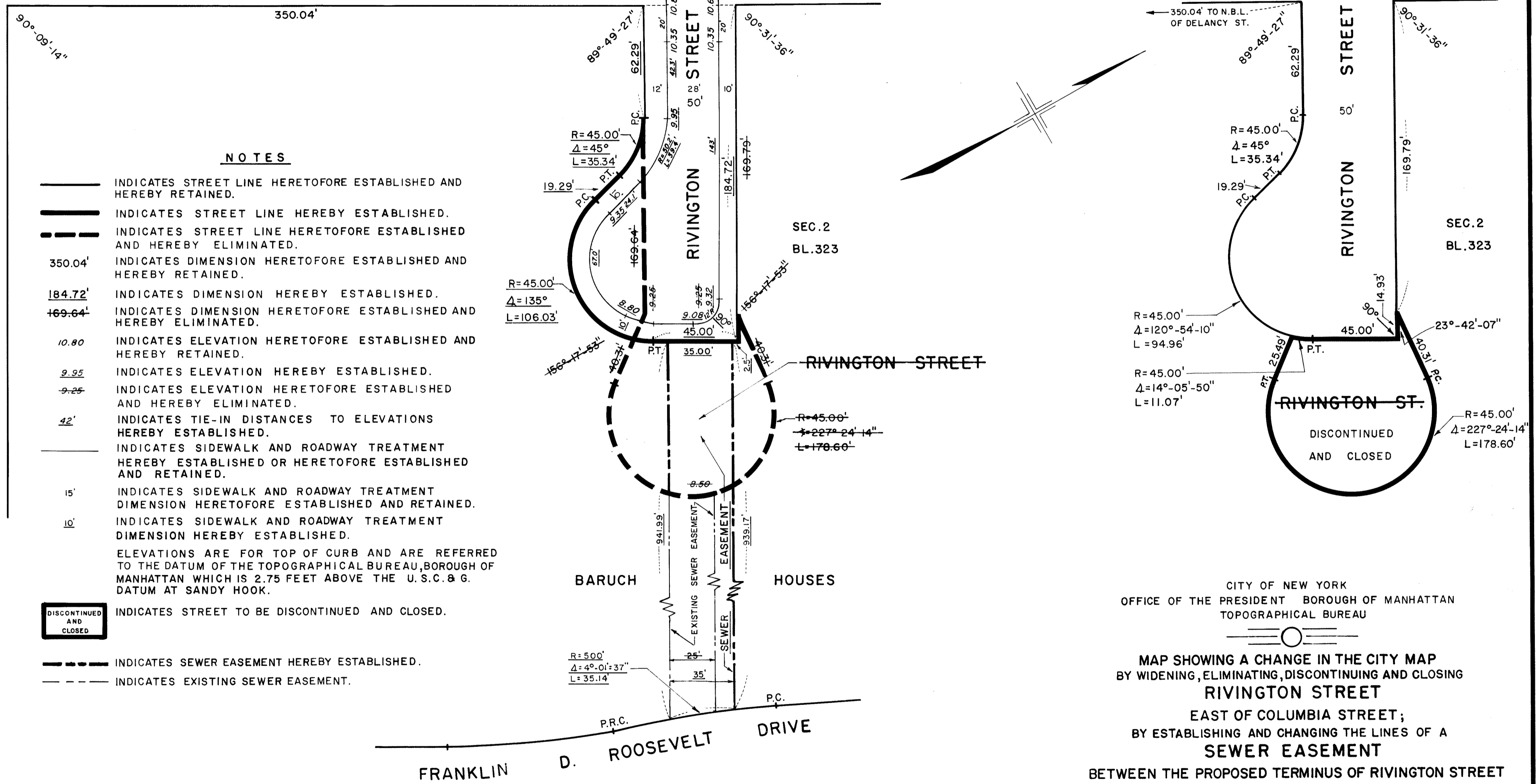

NOTES

- INDICATES STREET LINE HERETOFORE ESTABLISHED AND HEREBY RETAINED.
- INDICATES STREET LINE HEREBY ESTABLISHED.
- - - INDICATES STREET LINE HERETOFORE ESTABLISHED AND HEREBY ELIMINATED.
- 350.04' INDICATES DIMENSION HERETOFORE ESTABLISHED AND HEREBY RETAINED.
- 184.72' INDICATES DIMENSION HEREBY ESTABLISHED.
- 169.64' INDICATES DIMENSION HERETOFORE ESTABLISHED AND HEREBY ELIMINATED.
- 10.80 INDICATES ELEVATION HERETOFORE ESTABLISHED AND HEREBY RETAINED.
- 9.95 INDICATES ELEVATION HEREBY ESTABLISHED.
- 9.25 INDICATES ELEVATION HERETOFORE ESTABLISHED AND HEREBY ELIMINATED.
- 42' INDICATES TIE-IN DISTANCES TO ELEVATIONS HEREBY ESTABLISHED.
- - - INDICATES SIDEWALK AND ROADWAY TREATMENT HEREBY ESTABLISHED OR HERETOFORE ESTABLISHED AND RETAINED.
- 15' INDICATES SIDEWALK AND ROADWAY TREATMENT DIMENSION HERETOFORE ESTABLISHED AND RETAINED.
- 10' INDICATES SIDEWALK AND ROADWAY TREATMENT DIMENSION HEREBY ESTABLISHED.
- ELEVATIONS ARE FOR TOP OF CURB AND ARE REFERRED TO THE DATUM OF THE TOPOGRAPHICAL BUREAU, BOROUGH OF MANHATTAN WHICH IS 2.75 FEET ABOVE THE U.S.C. & G. DATUM AT SANDY HOOK.
- DISCONTINUED AND CLOSED INDICATES STREET TO BE DISCONTINUED AND CLOSED.
- - - INDICATES SEWER EASEMENT HEREBY ESTABLISHED.
- - - INDICATES EXISTING SEWER EASEMENT.

CITY OF NEW YORK
 OFFICE OF THE PRESIDENT BOROUGH OF MANHATTAN
 TOPOGRAPHICAL BUREAU

MAP SHOWING A CHANGE IN THE CITY MAP
 BY WIDENING, ELIMINATING, DISCONTINUING AND CLOSING
 RIVINGTON STREET
 EAST OF COLUMBIA STREET;
 BY ESTABLISHING AND CHANGING THE LINES OF A
 SEWER EASEMENT
 BETWEEN THE PROPOSED TERMINUS OF RIVINGTON STREET
 AND FRANKLIN D. ROOSEVELT DRIVE;
 AND BY ESTABLISHING GRADES AND ROADWAY TREATMENT THEREFOR
 ALL IN CONNECTION WITH AN EXTENSION TO THE BARUCH HOUSES
 DATED: DEC. 7, 1973 SCALE: 1" = 40'

I, DAVID C. O'CONNOR, SECRETARY OF THE BOARD OF ESTIMATE OF THE CITY OF NEW YORK DO HEREBY CERTIFY THAT THIS MAP IS ONE OF SEVEN SIMILAR MAPS ADOPTED BY THE SAID BOARD OF ESTIMATE ON APRIL 25, 1974 CAL. 2

DATED: NEW YORK MAY 28, 1974

David C. O'Connor
 SECRETARY BOARD OF ESTIMATE
 4.9

DRAWN BY: KLT
 CHECKED BY: H.S.
 George Soilan
 DEPUTY TOPOGRAPHICAL ENGINEER

FOR PREVIOUS LAYOUT OF THIS AREA SEE ACC. NOS. 29173, 29381

6/3/74
 J. Faybik

[Signature]
 PRESIDENT, BOROUGH OF MANHATTAN

[Signature] P.E.
 TOPOGRAPHICAL ENGINEER

ACC. NO. 30034