

ST. YORK AVENUE ST. ST. ST. ST. ST. ST. ST. ST. ST. ST. ST. ST. ST. ST.

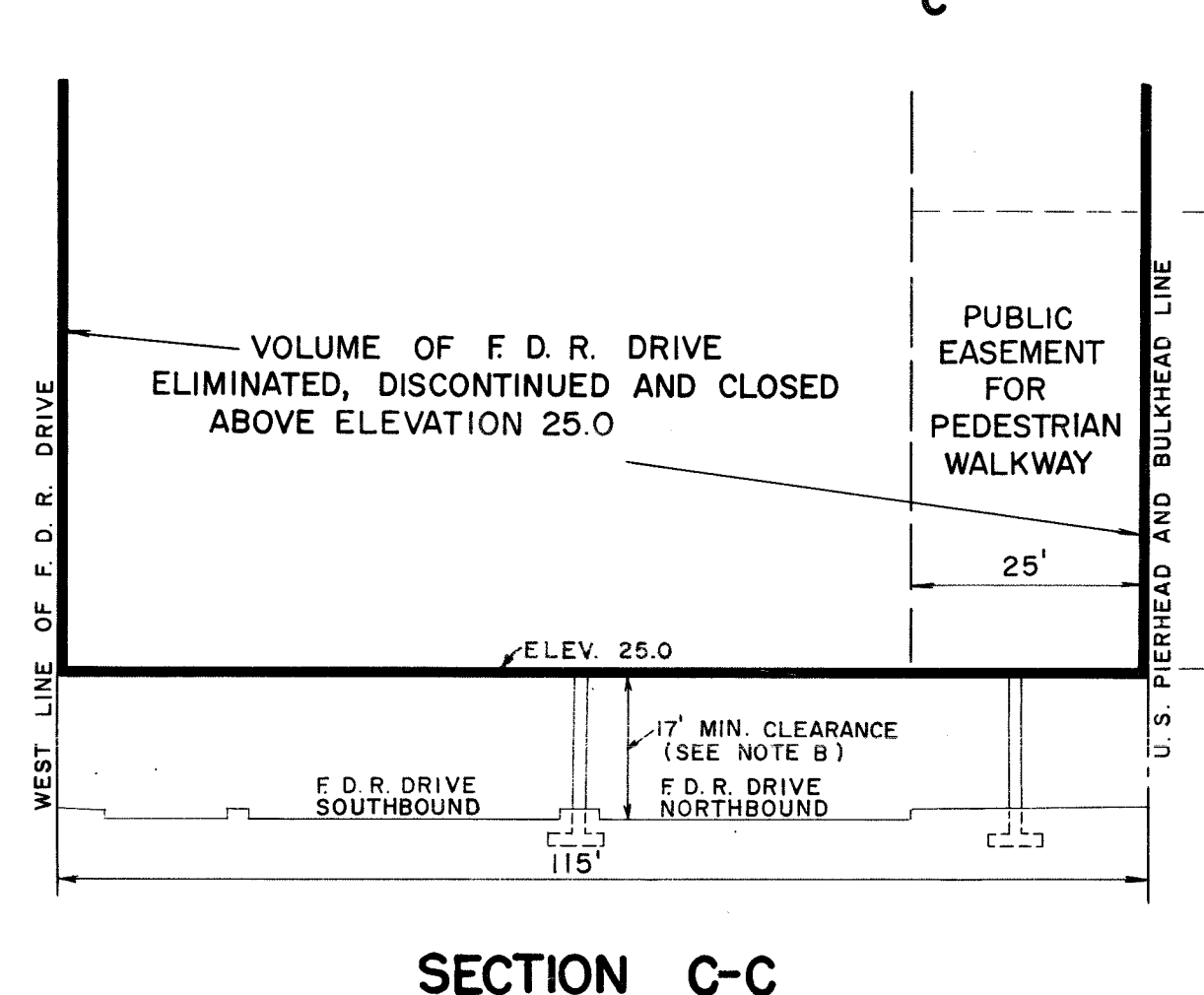
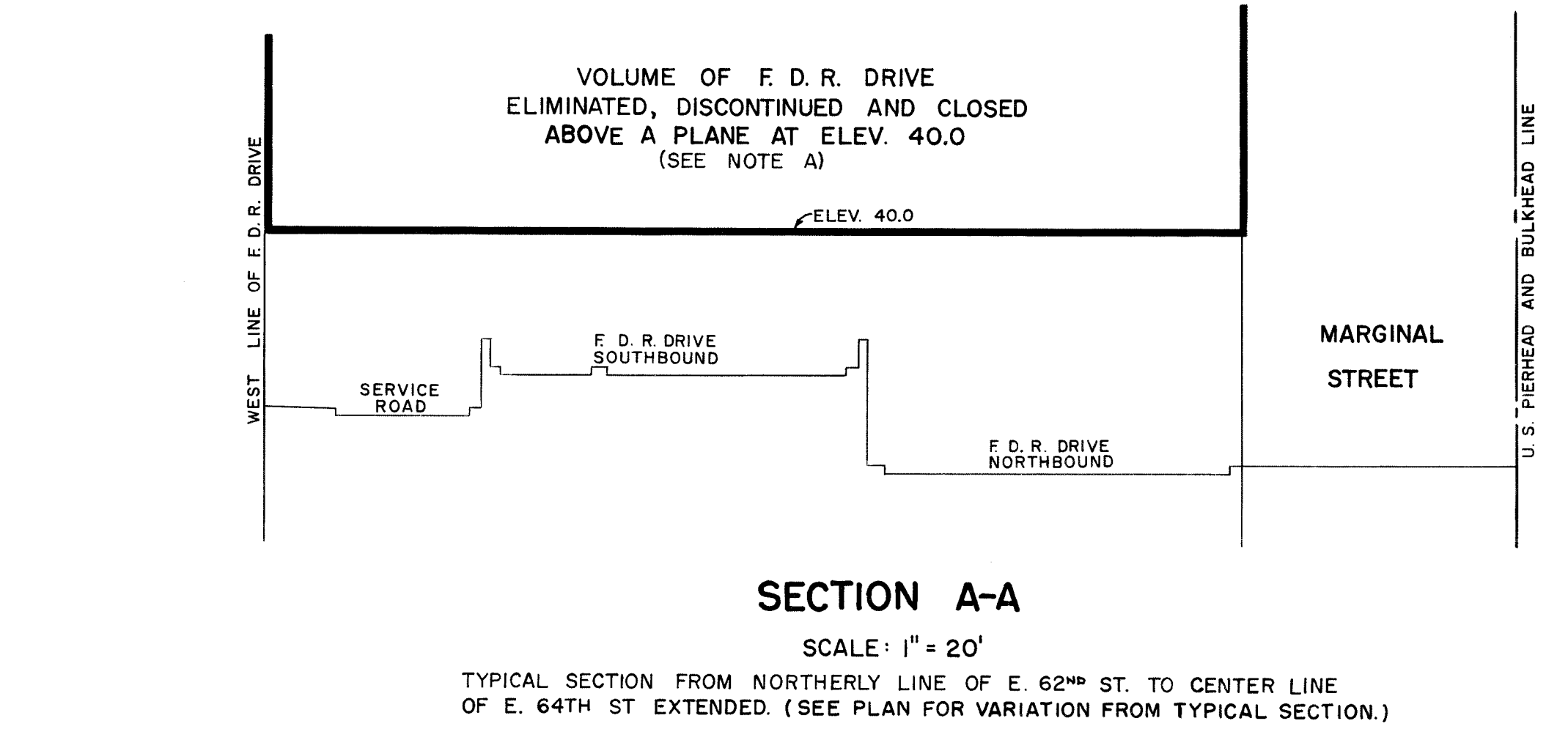
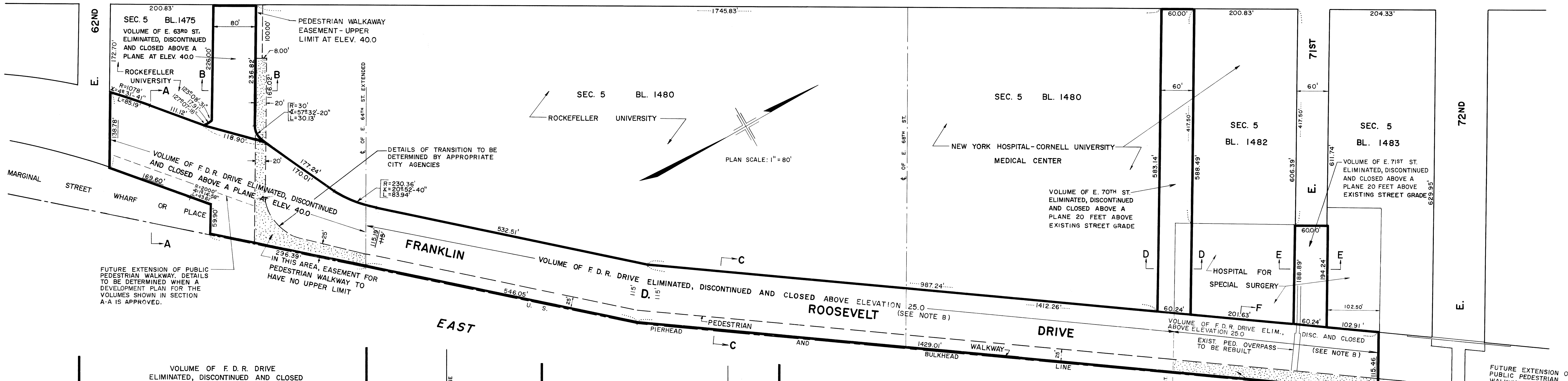

NOTES

INDICATES STREET LINE HERETOFORE ESTABLISHED AND HEREBY RETAINED.

INDICATES DIMENSION HERETOFORE ESTABLISHED AND HEREBY RETAINED.

INDICATES DIMENSION HERETOFORE ESTABLISHED AND HEREBY ELIMINATED.

INDICATES STREET VOLUMES HEREBY ELIMINATED, DISCONTINUED AND CLOSED.

ALL ELEVATIONS ARE REFERRED TO THE DATUM OF THE TOPOGRAPHICAL BUREAU, BOROUGH OF MANHATTAN, WHICH IS 2.75 FEET ABOVE THE U.S.C. & G. DATUM AT SANDY HOOK.

GENERAL NOTE: MAP INTENDED TO SHOW LIMITS OF AIR RIGHTS TO BE MADE AVAILABLE TO ADJUTING INSTITUTIONS AS SHOWN ON PLAN.

NOTE A: NO CONSTRUCTION PERMITTED IN ELIMINATED VOLUMES INDICATED IN SECTS A-A, B-B, D-D, E-E, AND F-F EXCEPT BY APPROVAL OF THE BOARD OF ESTIMATE AND CITY PLANNING COMMISSION AFTER REVIEW BY CITY AGENCIES.

NOTE B: MINIMUM VERTICAL CLEARANCE OF 17 FEET TO UNDERSIDE OF PLATFORM IS SUBJECT TO MODIFICATION AS MAY BE NECESSARY IN ORDER TO MEET REQUIRED SIGHT DISTANCES TO HIGHWAY SIGNS.

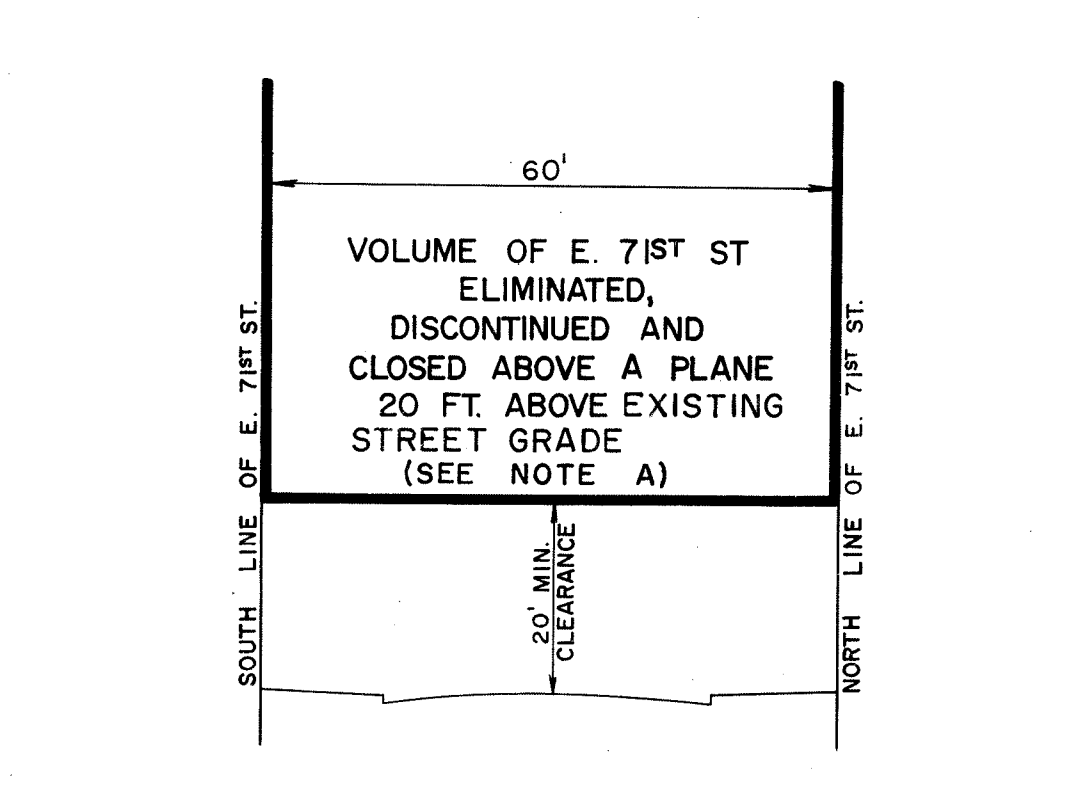
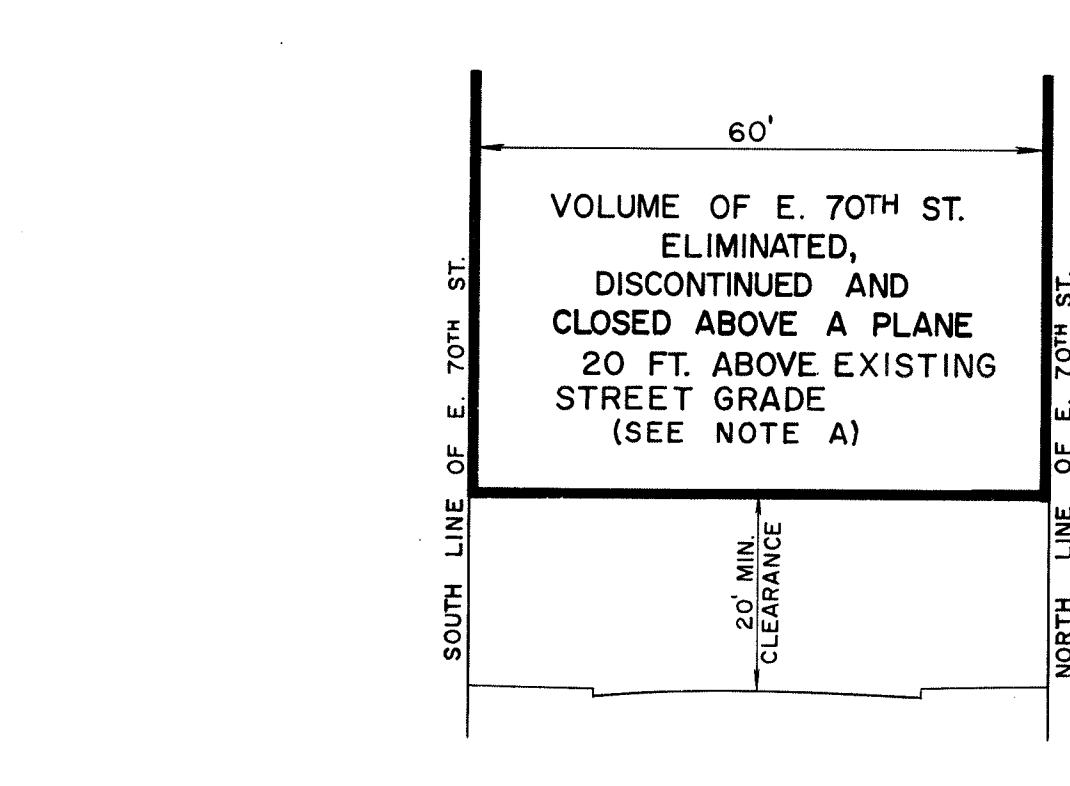
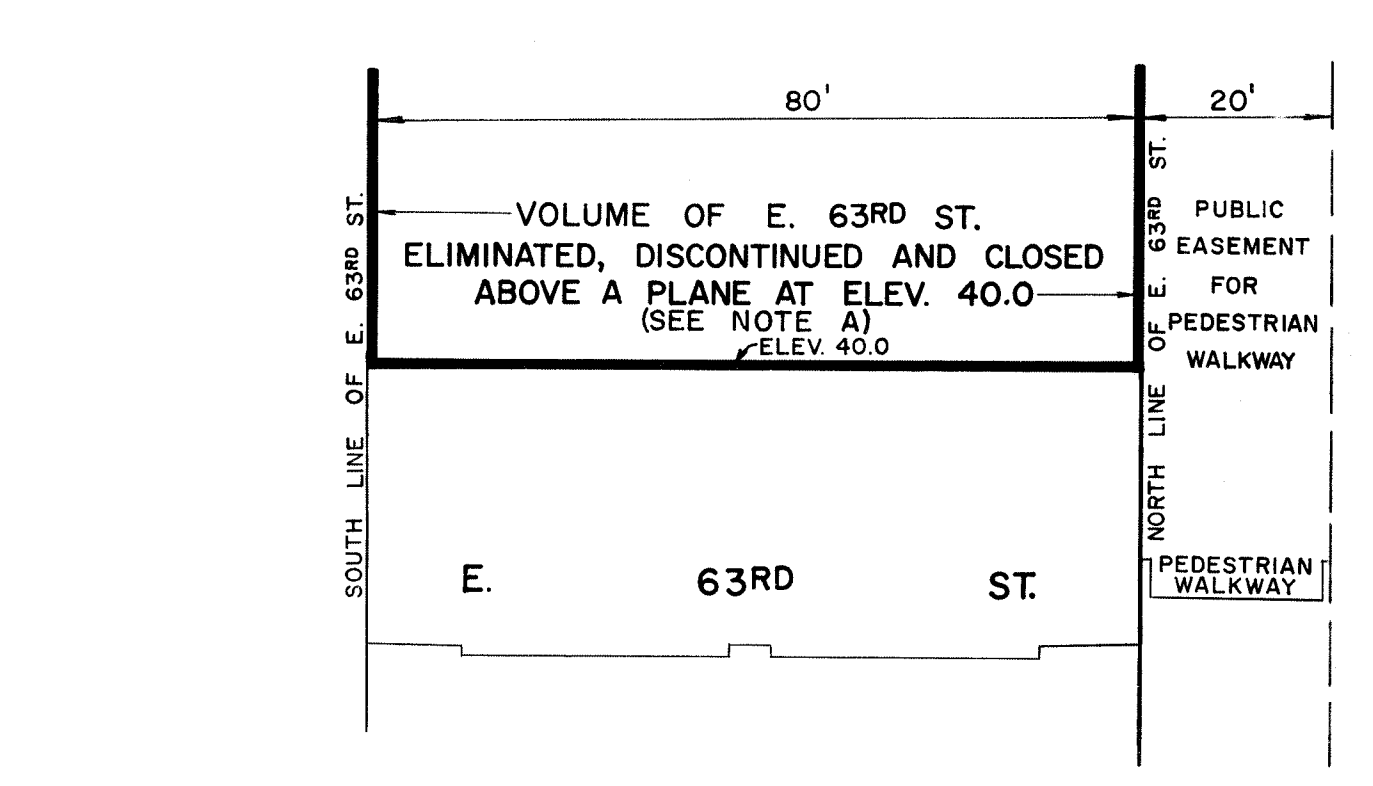
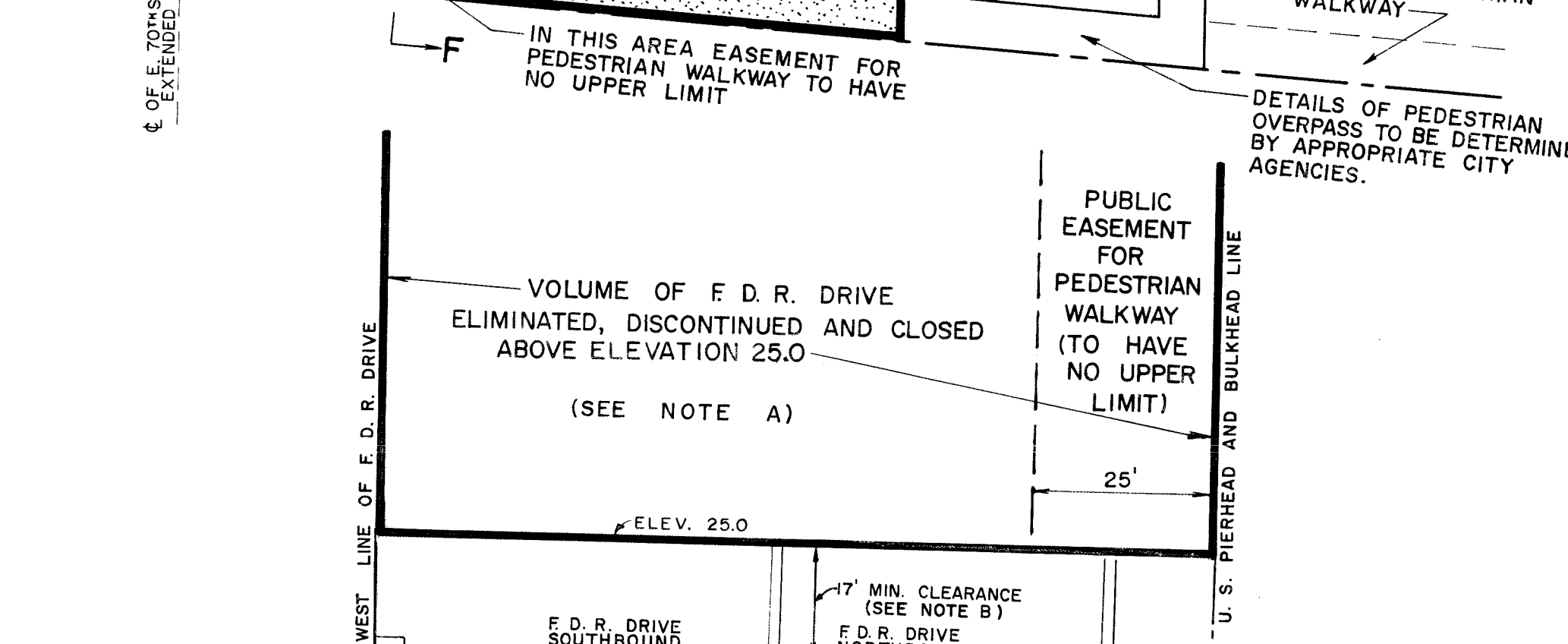

**CITY OF NEW YORK
CITY PLANNING COMMISSION**

MAP SHOWING A CHANGE IN THE CITY MAP BY ELIMINATING, DISCONTINUING AND CLOSING VOLUMES OF STREETS ABOVE DESIGNATED LOWER LIMITING PLANES, AND BY LAYING OUT THE LINES AND DIMENSIONS OF A PERMANENT EASEMENT FOR AN ELEVATED PUBLIC PEDESTRIAN WALKWAY IN THE AREA GENERALLY BOUNDED BY EAST 62ND STREET, YORK AVENUE, EAST 72ND STREET AND THE EAST RIVER, BOROUGH OF MANHATTAN.

DATED: JULY 3, 1972

SCALE AS SHOWN

DRAWN BY: K.A.N. & G.S.
CHECKED BY: *[Signature]*
DEPUTY TOPOGRAPHICAL ENGINEER
TOPOGRAPHICAL ENGINEER

DAVID C. O'CONNOR, SECRETARY OF THE BOARD OF ESTIMATE OF THE CITY OF NEW YORK DO HEREBY CERTIFY THAT THIS MAP IS ONE OF SEVEN SIMILAR MAPS ADOPTED BY THE SAID BOARD OF ESTIMATE ON THE 21st APRIL, 1973 CAL. 1

DATED: NEW YORK 4/27/1973
[Signature]
SECRETARY, BOARD OF ESTIMATE

4/27/1973
[Signature]
JOHN FAJPIK

[Signature] P.E.
CHIEF, OFFICE OF TECHNICAL CONTROLS
CITY PLANNING COMMISSION

[Signature]
CHAIRMAN, CITY PLANNING COMMISSION

[Signature]
PRESIDENT, BOROUGH OF MANHATTAN

ACC. 30023