

WEST CHANNEL

SCALE: 1" = 60'

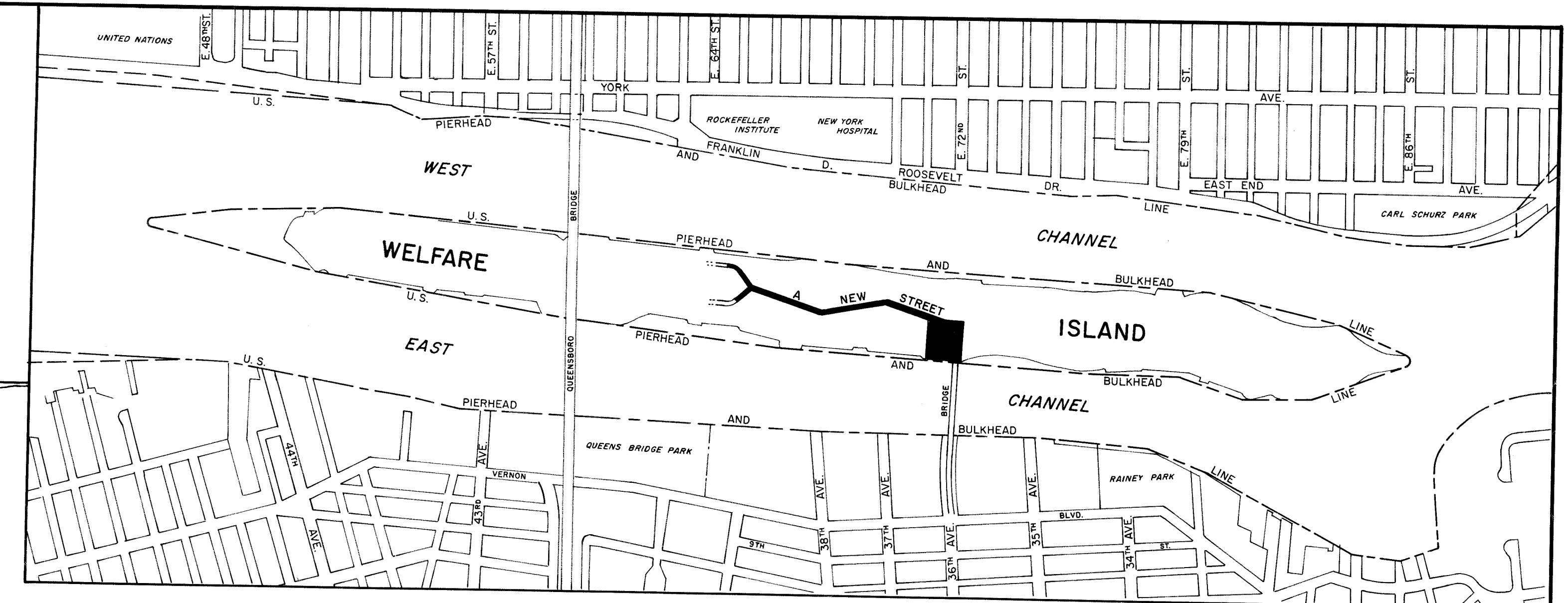

LOCATION MAP

WELFARE ISLAND

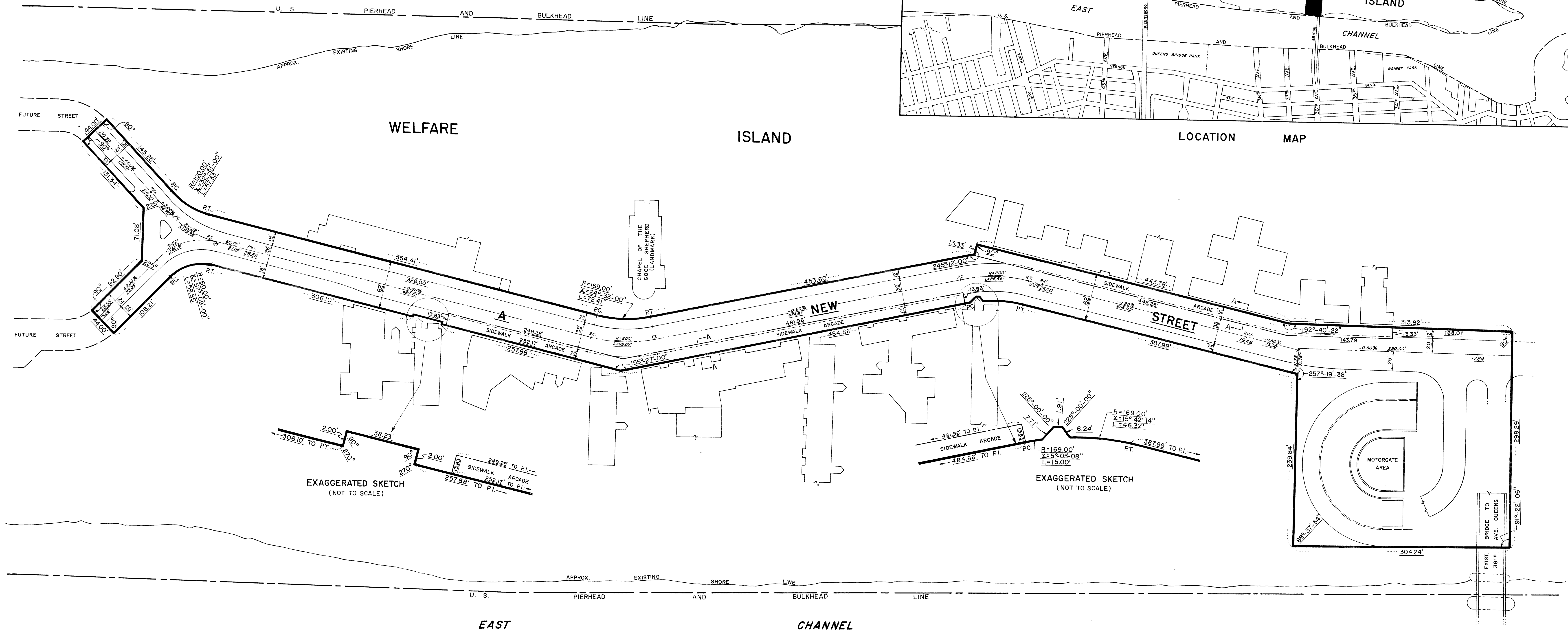

EXAGGERATED SKETCH (NOT TO SCALE)

EXAGGERATED SKETCH (NOT TO SCALE)

EAST CHANNEL

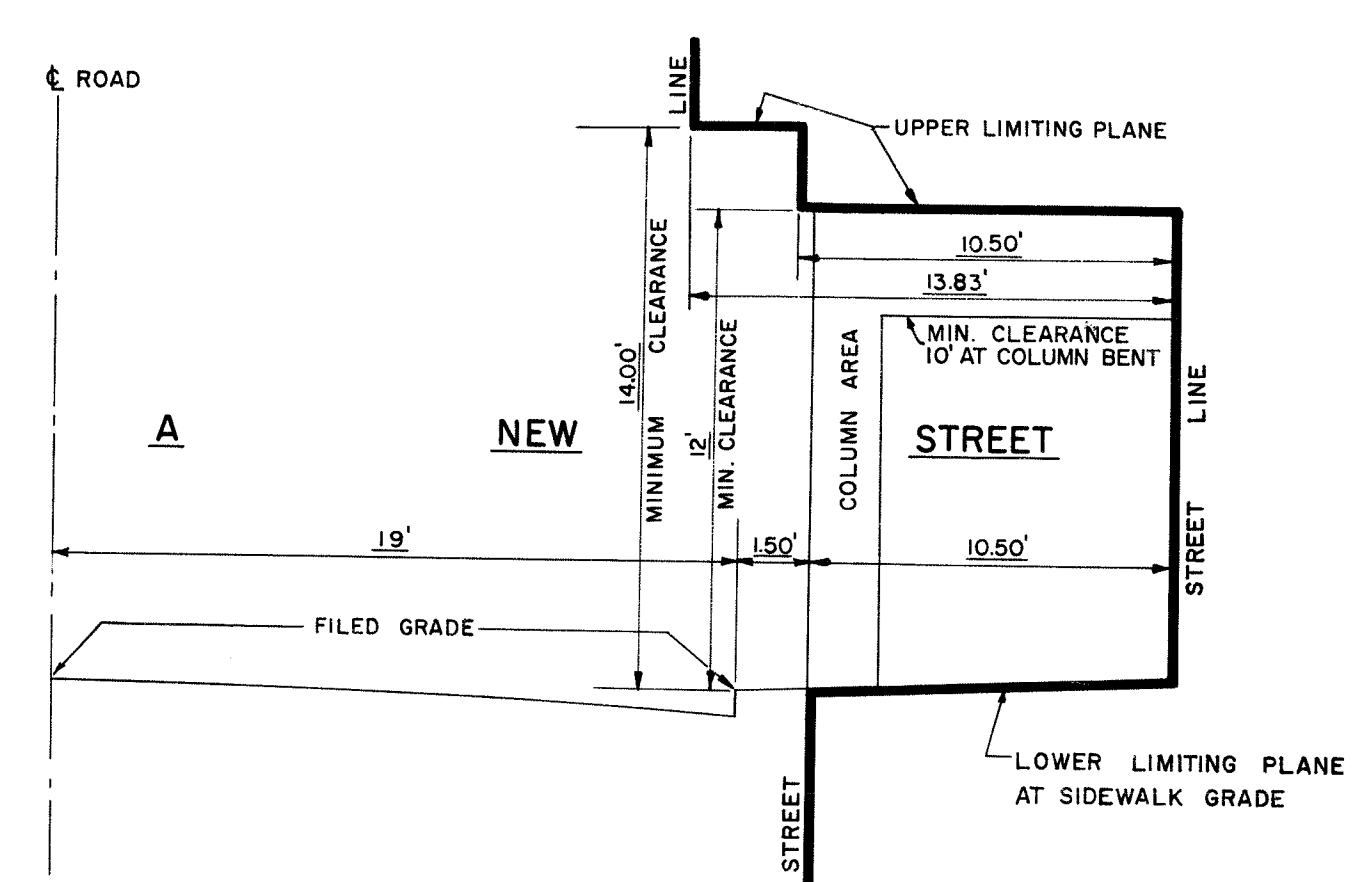

TYPICAL SECTION A-A
SCALE: 1" = 5'-0"

- NOTES**
- INDICATES STREET LINE HEREBY ESTABLISHED.
 - 564.41' INDICATES DIMENSION HEREBY ESTABLISHED.
 - 23.00' INDICATES ELEVATION HEREBY ESTABLISHED.
 - 487.72' INDICATES TIE-IN DISTANCES TO ELEVATIONS HEREBY ESTABLISHED.
 - INDICATES SIDEWALK AND ROADWAY TREATMENT HEREBY ESTABLISHED.
 - 12' INDICATES SIDEWALK AND ROADWAY TREATMENT DIMENSION HEREBY ESTABLISHED.
- ELEVATIONS SHOWN ON THIS MAP ARE FOR TOP OF PAVEMENT AT CENTER LINE OF ROADWAY AND ARE REFERRED TO THE BELMONT ISLAND DATUM WHICH IS 2.265 FEET BELOW THE U.S.C. & G. DATUM AT SANDY HOOK.

I, RUTH W. WHALEY, SECRETARY OF THE BOARD OF ESTIMATE OF THE CITY OF NEW YORK DO HEREBY CERTIFY THAT THIS MAP IS ONE OF SEVEN SIMILAR MAPS ADOPTED BY THE SAID BOARD OF ESTIMATE ON August 17, 1972. CAL. 145

DATED: NEW YORK SEP 12 1972
Ruth W. Whaley
 SECRETARY, BOARD OF ESTIMATE
 N.Y.

CITY OF NEW YORK
 OFFICE OF THE PRESIDENT BOROUGH OF MANHATTAN
 TOPOGRAPHICAL BUREAU

MAP SHOWING A CHANGE IN THE STREET SYSTEM BY LAYING OUT THE LINES, GRADES AND ROADWAY TREATMENT OF

A NEW STREET,
 PORTIONS OF WHICH WILL LIE BETWEEN UPPER AND LOWER LIMITING PLANES IN

WELFARE ISLAND,
 APPROXIMATELY BETWEEN THE EASTERLY PROLONGATION OF THE NORTHERLY LINE OF EAST 64TH STREET AND THE EASTERLY PROLONGATION OF THE NORTHERLY LINE OF EAST 72ND STREET
 BOROUGH OF MANHATTAN.

DATED: JUNE 1, 1972

SCALE: AS SHOWN

Felipe Amador
 PRESIDENT, BOROUGH OF MANHATTAN
 TOPOGRAPHICAL ENGINEER

DRAWN BY: K.N.B.F.S.
 CHECKED BY: *m.j.w.*
 DEPUTY TOPOGRAPHICAL ENGINEER