

MARGINAL STREET WHARF OR PLACE

U. S. BULKHEAD LINE

EAST RIVER

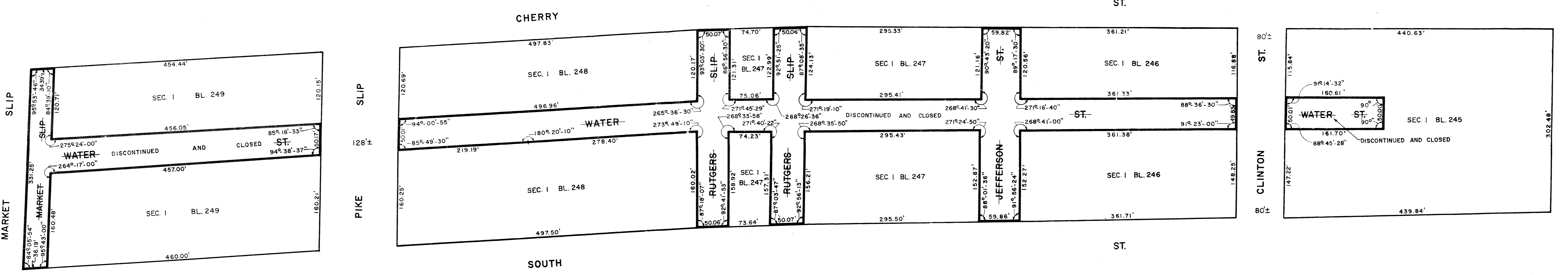

NOTE: STREETS TO BE DISCONTINUED AND CLOSED ENCLOSED IN HEAVY BLACK LINES.

NOTES

- INDICATES STREET LINE HERETOFORE ESTABLISHED AND HEREBY RETAINED.
- INDICATES STREET LINE HEREBY ESTABLISHED.
- INDICATES STREET LINE HERETOFORE ESTABLISHED AND HEREBY ELIMINATED.
- 90' INDICATES DIMENSION HERETOFORE ESTABLISHED AND HEREBY RETAINED.
- 497.50' INDICATES DIMENSION HEREBY ESTABLISHED.
- 460.65' INDICATES DIMENSION HERETOFORE ESTABLISHED AND HEREBY ELIMINATED.
- 3.9' INDICATES ELEVATION HERETOFORE ESTABLISHED AND HEREBY RETAINED.
- 3.2' INDICATES ELEVATION HEREBY ESTABLISHED.
- 4.60' INDICATES ELEVATION HERETOFORE ESTABLISHED AND HEREBY ELIMINATED.
- 128' INDICATES TIE-IN DISTANCE TO ELEVATIONS HEREBY ESTABLISHED.
- 10' INDICATES SIDEWALK AND ROADWAY TREATMENT HEREBY ESTABLISHED OR HERETOFORE ESTABLISHED AND RETAINED.
- 10' INDICATES EXISTING SIDEWALK AND ROADWAY TREATMENT DIMENSION.
- 15' INDICATES SIDEWALK AND ROADWAY TREATMENT DIMENSION HEREBY ESTABLISHED.
- ELEVATIONS ARE FOR TOP OF CURB AND ARE REFERRED TO THE DATUM OF THE TOPOGRAPHICAL BUREAU, BOROUGH OF MANHATTAN WHICH IS 2.75 FEET ABOVE THE U.S.C.G. SURVEY DATUM AT SANDY HOOK.
- INDICATES PARK HERETOFORE ESTABLISHED AND HEREBY ELIMINATED.
- INDICATES SEWER EASEMENT HEREBY ESTABLISHED.
- INDICATES SIDEWALK EASEMENT HEREBY ESTABLISHED.

CITY OF NEW YORK
CITY PLANNING COMMISSION

MAP SHOWING A CHANGE IN THE CITY MAP BY ELIMINATING, WIDENING, DISCONTINUING AND CLOSING STREETS; BY ELIMINATING A PARK; BY ESTABLISHING THE LINES AND DIMENSIONS OF SEVERAL SIDEWALK AND SEWER EASEMENTS, AND BY ESTABLISHING GRADES AND ROADWAY TREATMENT IN THE AREA BOUNDED BY SOUTH STREET, MARKET SLIP, CHERRY STREET AND MONTGOMERY STREET IN CONNECTION WITH THE SITE FOR THE TWO BRIDGES URBAN RENEWAL AREA.

DATED FEB. 10, 1972

SCALE: 1" = 80'

DRAWN BY: G. SOILAN
CHECKED BY: M. J. W.
M. J. WIENDES
DEPUTY TOPOGRAPHICAL ENGINEER
John J. Lunde, P.E.
TOPOGRAPHICAL ENGINEER

FILED IN THE OFFICE OF THE CITY CLERK
1/31/1972
J. J. Faybit
James J. Fuchter, P.E.
CHIEF, OFFICE OF TECHNICAL CONTROLS

Donald H. Elliot
CHAIRMAN, CITY PLANNING COMMISSION
President, Borough of Manhattan