

PROFILE - BROADWAY
WEST SIDE

SCALES: HOR: 1" = 20'
VERT: 1" = 2'

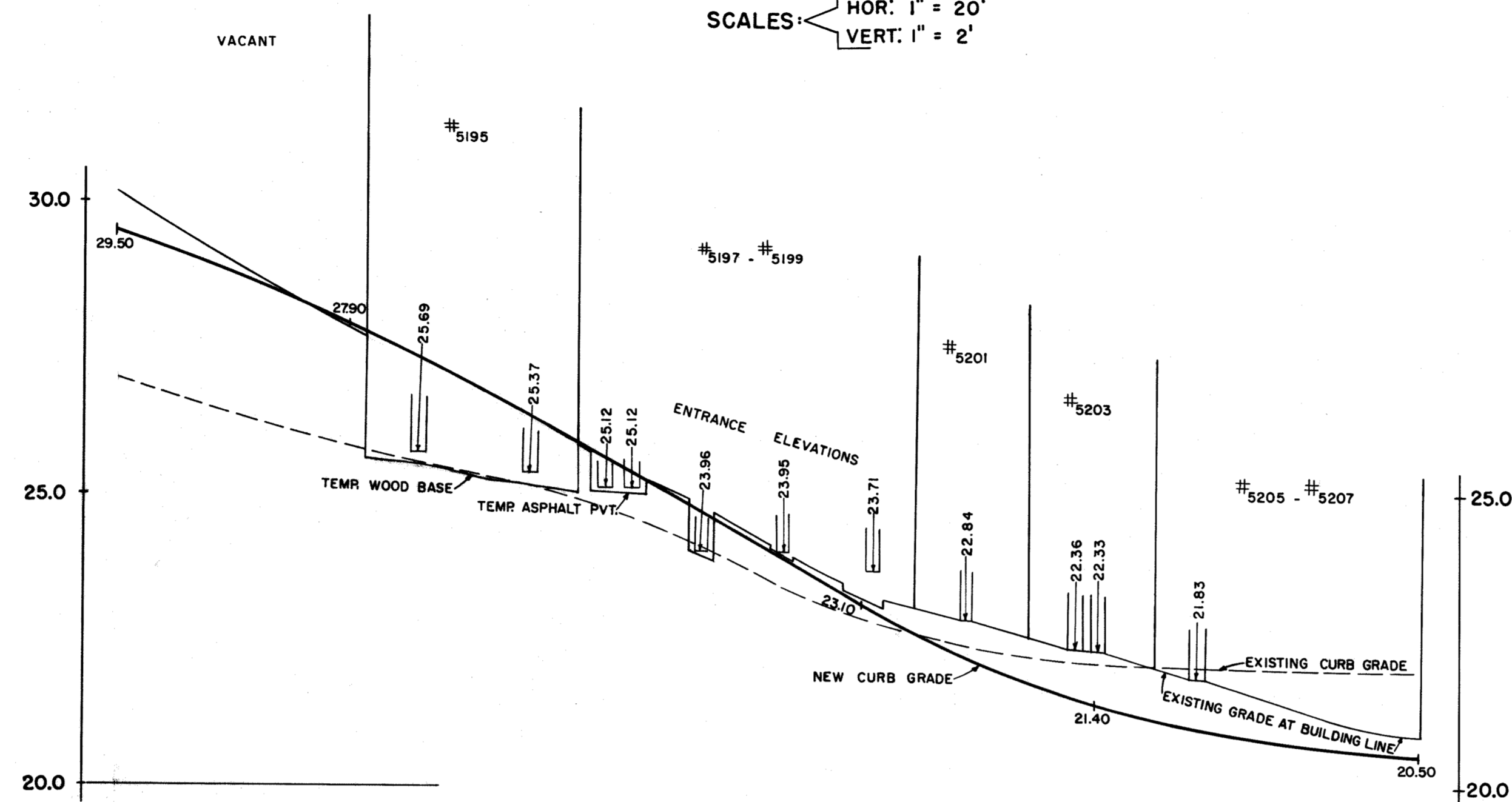

PLAN

SCALE: 1" = 20'

W. 225TH ST.

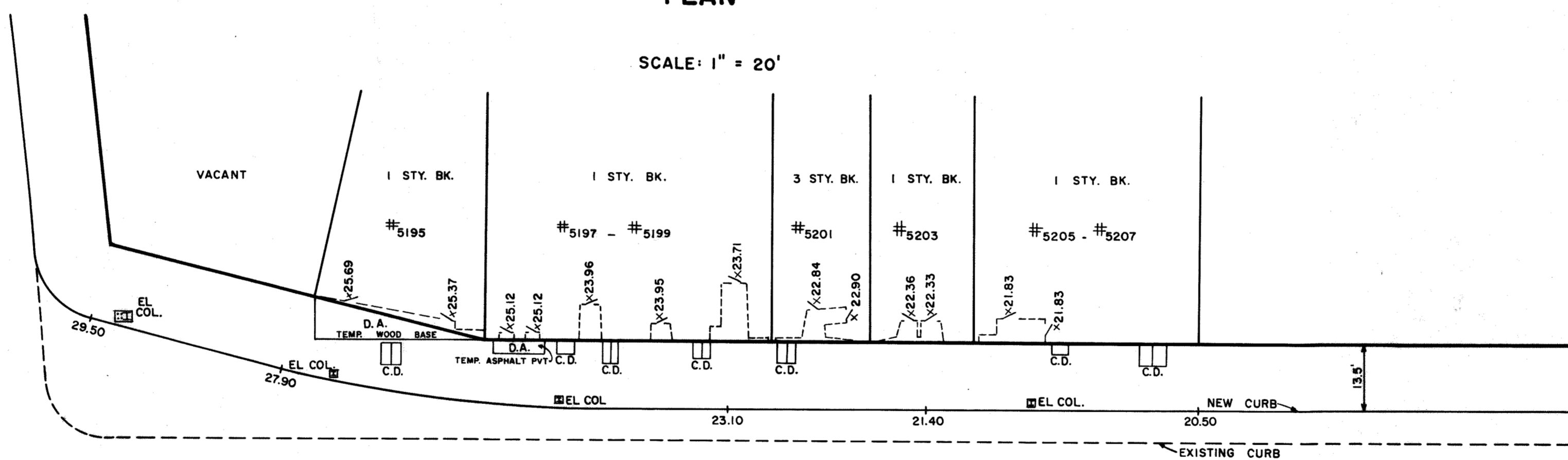

BROADWAY

W. 225TH ST.

NOTES
ELEVATIONS SHOWN ON THIS MAP ARE REFERRED TO THE DATUM OF THE TOPOGRAPHICAL BUREAU, BOROUGH OF MANHATTAN WHICH IS 2.75 FT. ABOVE THE U. S. C. & G. DATUM AT SANDY HOOK.

C.D. ————— CELLAR DOOR
D.A. - - - - - DEPRESSED AREA
ENTRANCE ELEVATION

CITY OF NEW YORK
OFFICE OF THE PRESIDENT BOROUGH OF MANHATTAN
TOPOGRAPHICAL BUREAU

PLAN, PROFILE AND GRADE HISTORY
OF THE WESTERLY SIDE OF
BROADWAY
BETWEEN W. 225TH STREET AND A POINT
APPROXIMATELY 230 FEET NORTHERLY THEREOF.

DATED: APRIL 10, 1963.

SCALE: AS SHOWN

DRAWN BY: G. S.

CHECKED BY: F. S.

F. Sanchez P.E.
DEPUTY TOPOGRAPHICAL ENGINEER

P. Rogack P.E.
CONSULTING ENGINEER

Edward D. Kauf P.E.
TOPOGRAPHICAL ENGINEER