

I, RUTH W. WHALEY, SECRETARY OF THE BOARD OF ESTIMATE OF THE CITY OF NEW YORK DO HEREBY CERTIFY THAT THIS MAP IS ONE OF FIVE SIMILAR MAPS ADOPTED BY THE SAID BOARD OF ESTIMATE ON MARCH 9th 1961 CAL. N^o 1

DATED: NEW YORK APRIL 31, 1961

Ruth W. Whaley
SECRETARY BOARD OF ESTIMATE

NOTE

STREET TO BE DISCONTINUED AND CLOSED ENCLOSED IN HEAVY BLACK LINES.

CITY OF NEW YORK
OFFICE OF THE PRESIDENT BORO. OF MANHATTAN
DEPARTMENT OF BOROUGH WORKS

MAP SHOWING A CHANGE IN THE STREET SYSTEM BY DISCONTINUING AND CLOSING PURSUANT TO CHAPTER 15, TITLE "E" OF THE ADMINISTRATIVE CODE OF THE CITY OF NEW YORK A PORTION OF

OLD SLIP
BETWEEN WATER STREET AND FRONT STREET

DATED: DECEMBER 5, 1960

SCALE: 1"=20'

Lois A. Coffey
ACT. PRESIDENT BORO. OF MANHATTAN

Anthony Donergo
CHIEF ENGINEER

FILED IN THE OFFICE OF THE PRES. BORO. MAN.
4/28/61

RECEIVED
CITY OF NEW YORK
DEPARTMENT OF BOROUGH WORKS
APR 28 1961

ACC. 29694

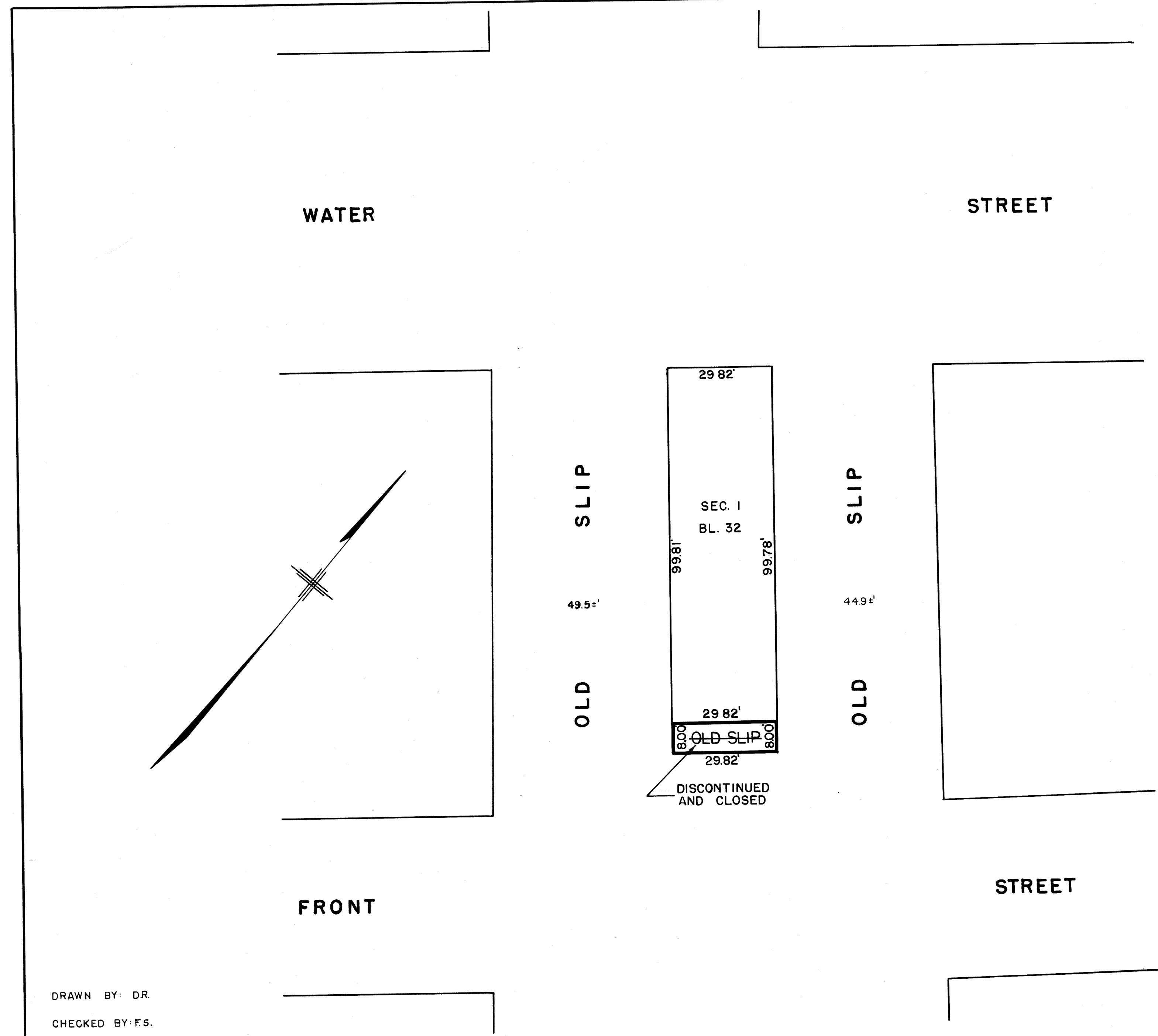

DRAWN BY: DR.

CHECKED BY: F.S.

F. Sanchez
SECTION ENGINEER
Edmund J. Karp
ENGINEER OF PLANNING

ES Ga
ENGINEER OF DESIGN

Drawn 19