

AMSTERDAM AVENUE

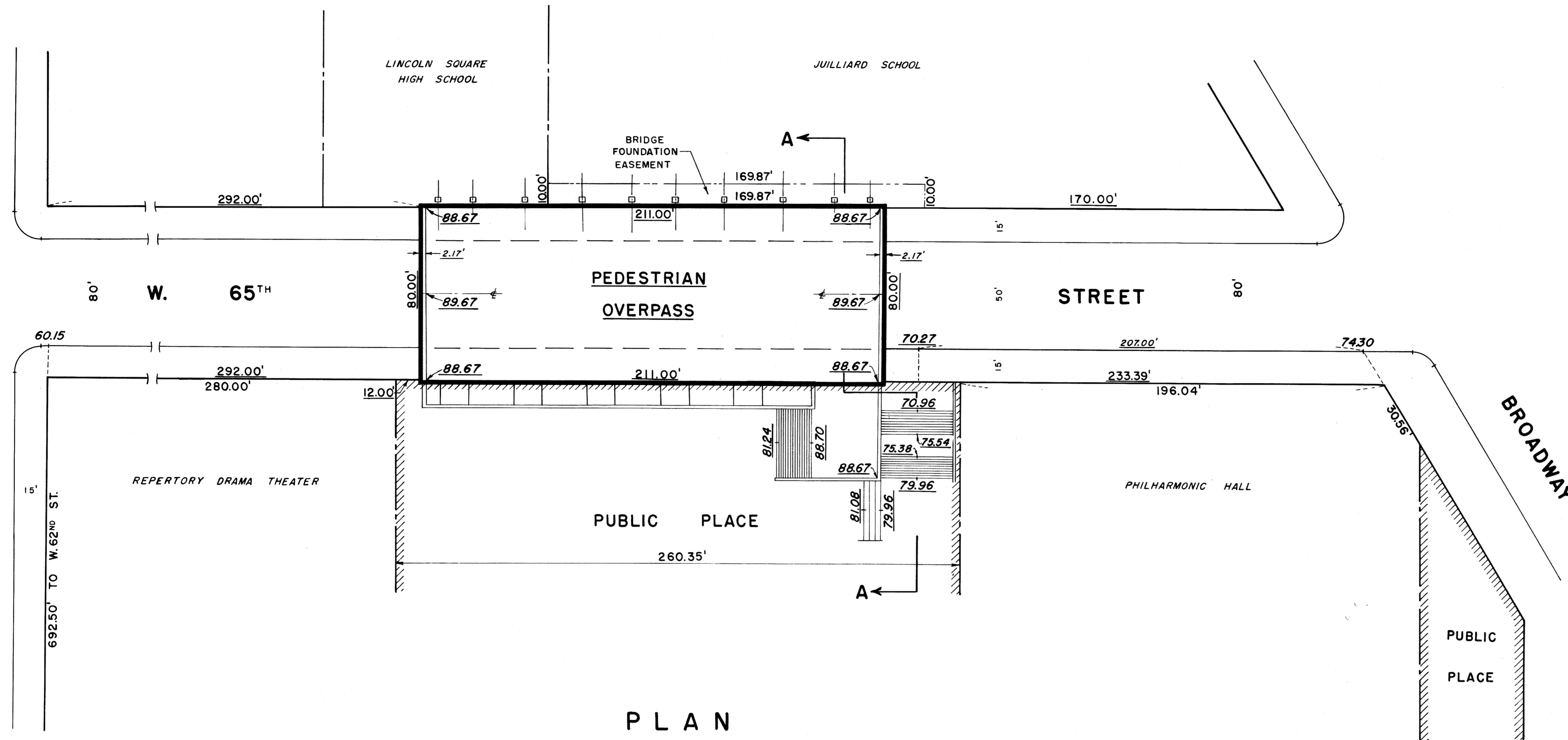

**PLAN**

SCALE: 1" = 32'

- NOTES**
- INDICATES STREET LINE HERETOFORE ESTABLISHED AND HEREBY RETAINED.
  - INDICATES LINE OF PEDESTRIAN OVERPASS HEREBY ESTABLISHED.
  - - - INDICATES PROPERTY SUBDIVISION LINE.
  - 196.04' INDICATES DIMENSION HERETOFORE ESTABLISHED AND HEREBY RETAINED.
  - 292.00' INDICATES DIMENSION HEREBY ESTABLISHED.
  - 74.30 INDICATES ELEVATION HERETOFORE ESTABLISHED AND HEREBY RETAINED.
  - 70.27 INDICATES ELEVATION HEREBY ESTABLISHED.
  - 15' INDICATES SIDEWALK AND ROADWAY TREATMENT HEREBY ESTABLISHED OR HERETOFORE ESTABLISHED AND RETAINED.
  - 15' INDICATES SIDEWALK AND ROADWAY TREATMENT DIMENSION HERETOFORE ESTABLISHED AND RETAINED.
  - INDICATES PUBLIC PLACE HERETOFORE ESTABLISHED AND HEREBY RETAINED.
  - ELEVATIONS SHOWN ON THIS MAP ARE REFERRED TO THE BOROUGH WORKS DATUM OF THE BOROUGH OF MANHATTAN WHICH IS 2.75 FEET ABOVE THE U.S.C. & G. DATUM AT SANDY HOOK.
  - 202.00' INDICATES TIE-IN DISTANCES TO ELEVATIONS HEREBY ESTABLISHED.

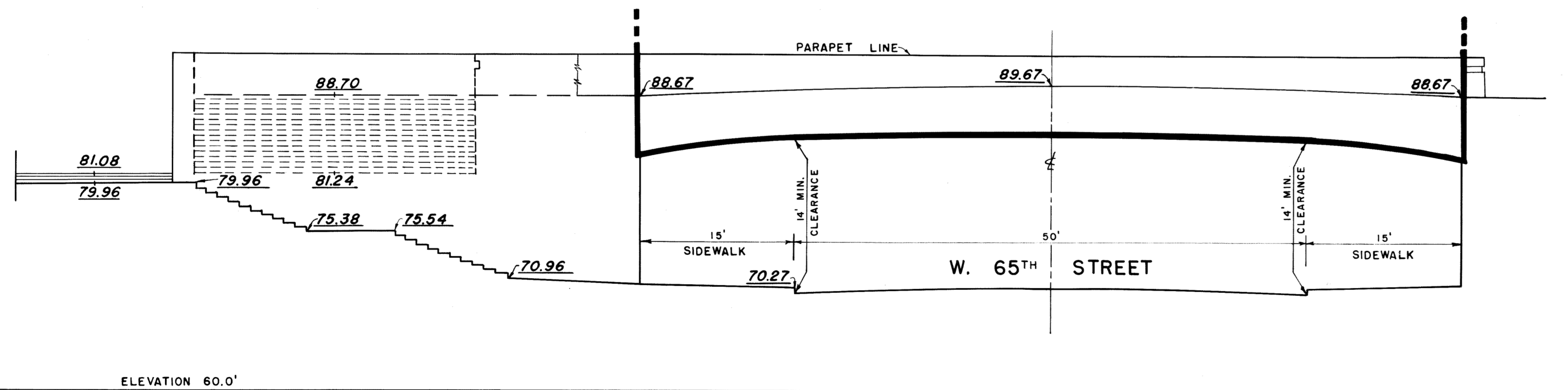

**SECTION A-A**

SCALE: 1" = 8'

CITY OF NEW YORK  
 OFFICE OF THE PRESIDENT BOROUGH OF MANHATTAN  
 DEPARTMENT OF BOROUGH WORKS

MAP SHOWING A CHANGE IN THE CITY PLAN  
 BY LAYING OUT LINES AND GRADES FOR  
**A. PEDESTRIAN OVERPASS**  
 OVER  
**WEST 65TH STREET**  
 BETWEEN  
**AMSTERDAM AVENUE AND BROADWAY**  
 IN CONNECTION WITH THE  
**LINCOLN SQUARE DEVELOPMENT**

I, RUTH W. WHALEY, SECRETARY OF THE BOARD OF ESTIMATE OF THE CITY OF NEW YORK DO HEREBY CERTIFY THAT THIS MAP IS ONE OF FIVE SIMILAR MAPS ADOPTED BY THE SAID BOARD OF ESTIMATE ON FEB. 23, 1961 CAL. 183

DATED: NEW YORK APRIL 21, 1961  
*Ruth W. Whaley*  
 SECRETARY BOARD OF ESTIMATE  
 N.Y.

DATED: NOV. 15, 1960

SCALE: AS SHOWN

DRAWN BY: G.T.

CHECKED BY: F.S.

*F. Sanchez*  
 SECTION ENGINEER  
*Edmund J. Karp*  
 ENGINEER OF PLANNING

*C.S.R.R.*  
 ENGINEER OF DESIGN

COMMISSIONER OF PARKS

*Raimo A. Costa*  
 ACT. PRESIDENT, BOROUGH OF MANHATTAN  
*Anthony Donato*  
 CHIEF ENGINEER

FILED IN THE OFFICE OF THE PRESIDENT, BOROUGH OF MANHATTAN

ACC: 29686