

- NOTES
- INDICATES STREET LINE HERETOFORE ESTABLISHED AND HEREBY RETAINED.
 - INDICATES STREET LINE HERETOFORE ESTABLISHED AND HEREBY ELIMINATED.
 - INDICATES DIMENSION HEREBY ESTABLISHED.
 - INDICATES SIDEWALK AND ROADWAY TREATMENT HEREBY ESTABLISHED OR HERETOFORE ESTABLISHED AND HEREBY RETAINED.
 - INDICATES SIDEWALK AND ROADWAY TREATMENT DIMENSION HEREBY ESTABLISHED.
 - INDICATES PARK HERETOFORE ESTABLISHED AND HEREBY RETAINED.
 - INDICATES PARK HEREBY ESTABLISHED.
 - INDICATES PARK HERETOFORE ESTABLISHED AND HEREBY ELIMINATED.

CITY OF NEW YORK
OFFICE OF THE PRESIDENT, BOROUGH OF MANHATTAN
DEPARTMENT OF BOROUGH WORKS

MAP SHOWING A CHANGE IN THE STREET SYSTEM BY LAYING OUT THE LINES OF THE LOWER MANHATTAN EXPRESSWAY WITH RAMP APPROACHES THERETO FROM THE MILLER (WEST SIDE) HIGHWAY AND HOLLAND TUNNEL TO THE MANHATTAN AND WILLIAMSBURG BRIDGES BY LAYING OUT AN EXTENSION OF KENMARE STREET FROM LAFAYETTE STREET TO AVENUE OF THE AMERICAS BY ELIMINATING, WIDENING AND RELOCATING STREETS AND BY LAYING OUT PARK STRIPS ALL IN CONNECTION THEREWITH

DATED: NOVEMBER 2, 1959

Anthony J. Romo
CHIEF ENGINEER

John T. Carroll
CONSULTING ENGINEER

SCALE: AS NOTED

I, RUTH W. WHALEY, SECRETARY OF THE BOARD OF ESTIMATE OF THE CITY OF NEW YORK DO HEREBY CERTIFY THAT THIS MAP IS ONE OF FIVE SIMILAR MAPS ADOPTED BY THE SAID BOARD OF ESTIMATE ON THE LAST 3067751 CAL. 57.

DATED NEW YORK JANUARY 4, 1961

Ruth W. Whaley
SECRETARY OF ESTIMATE

COMMISSIONER OF PARKS

CITY CONSTRUCTION CO-ORDINATOR

PRESIDENT, BOROUGH OF MANHATTAN

ACC. NO. 29666

ENGINEER OF PLANNING, B.P.M.
ENGINEER OF DESIGN, B.P.M.

UNITED STATES BULKHEAD LINE APPROVED BY THE SECRETARY OF WAR JULY 31, 1941

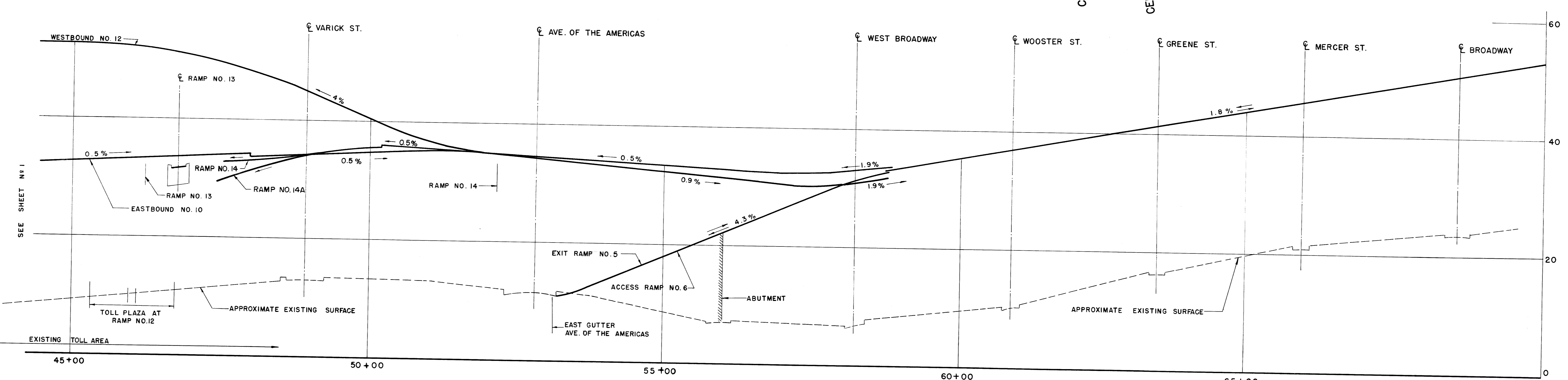
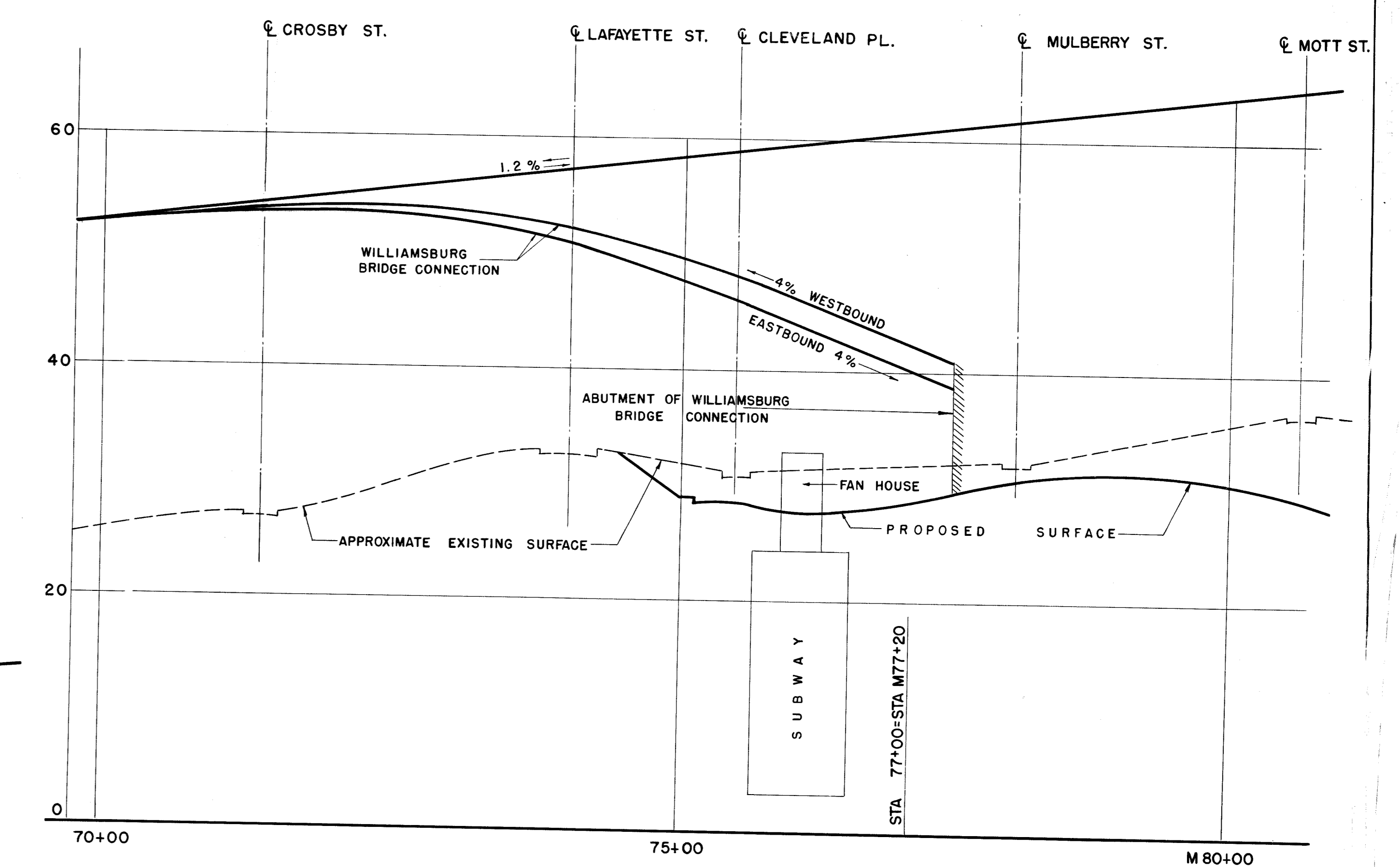
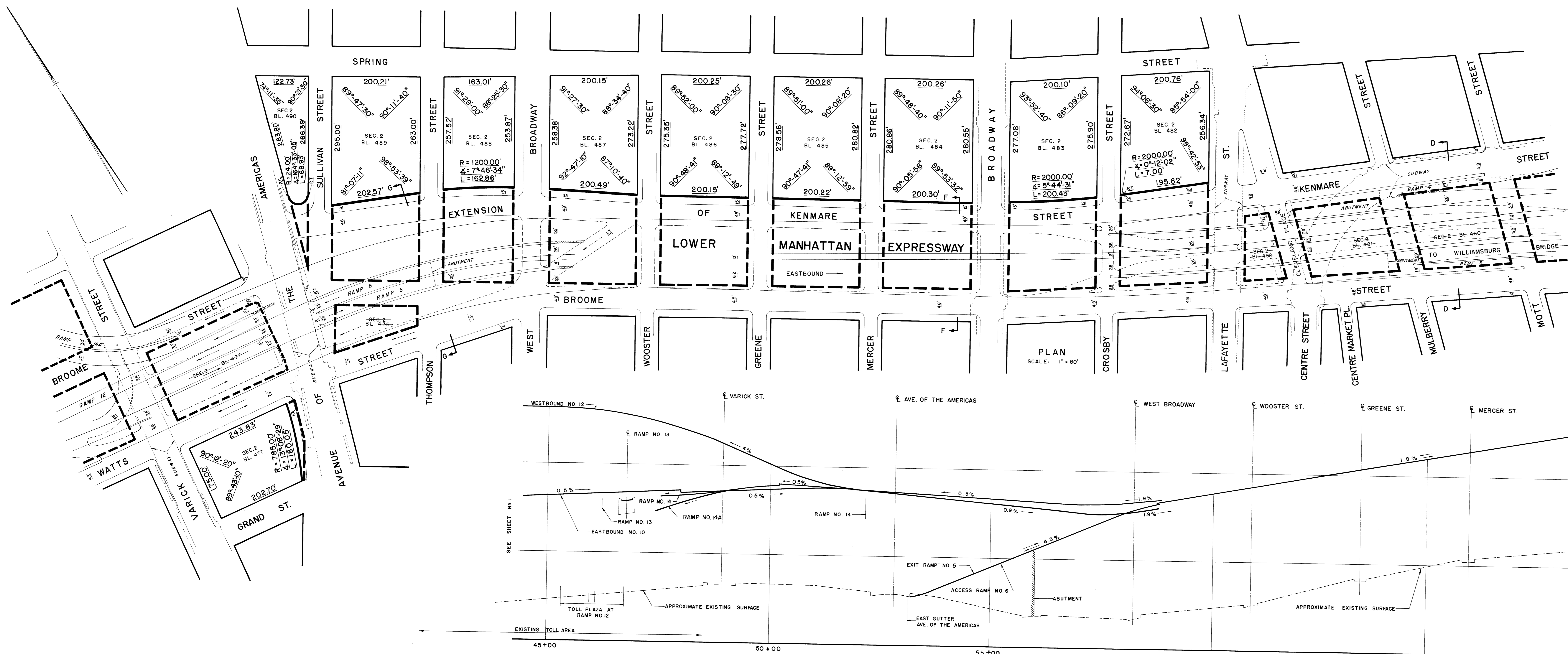

EASTBOUND NO. 10 & WESTBOUND NO. 12

HORIZONTAL SCALE 1" = 80.0'
VERTICAL SCALE 1" = 8.0'

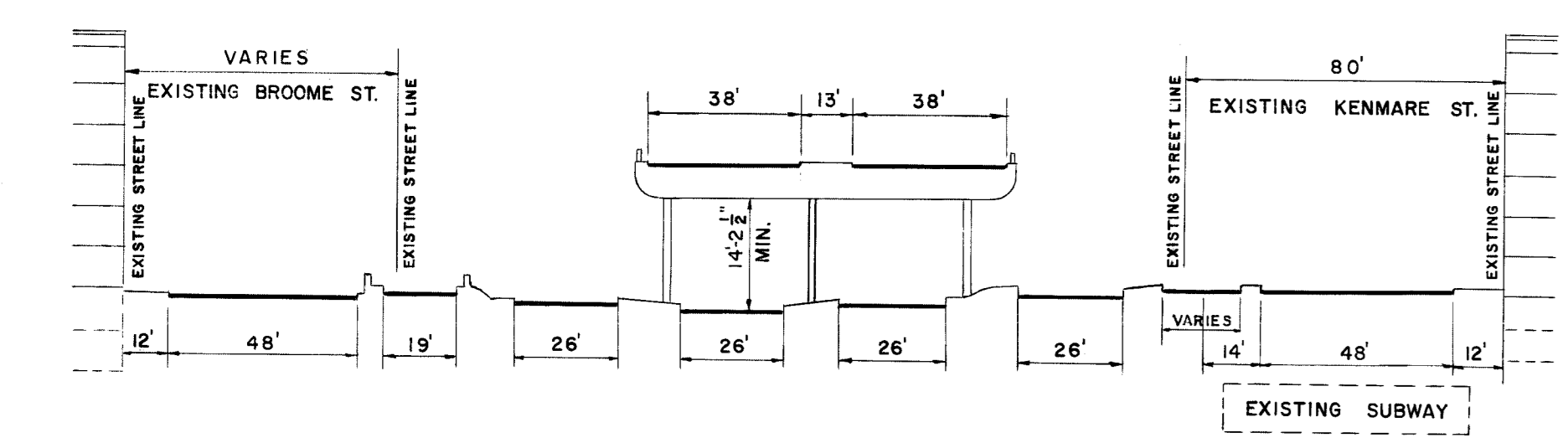

SECTION D-D
SCALE: 1" = 40.0'

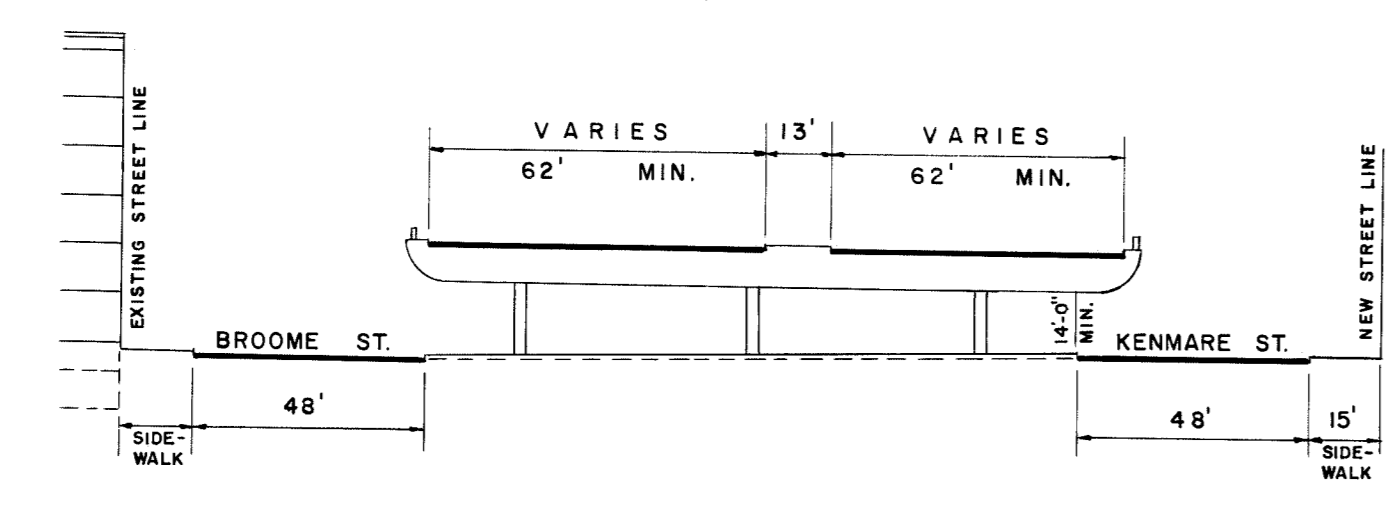

SECTION F-F
SCALE: 1" = 40.0'

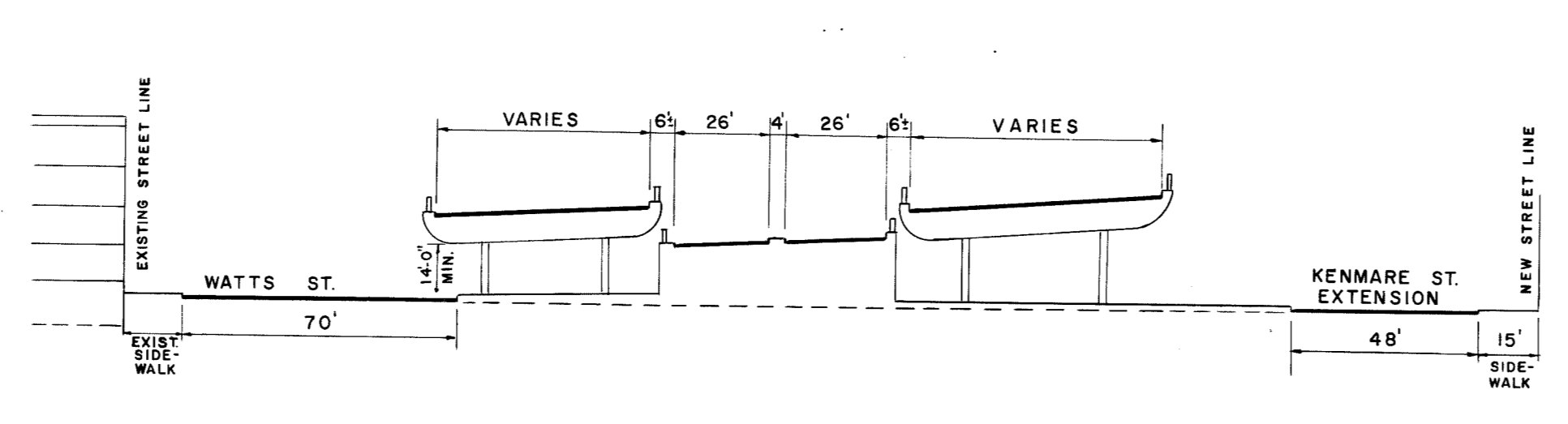

SECTION G-G
SCALE: 1" = 40.0'

- NOTES
- INDICATES STREET LINE HERETOFORE ESTABLISHED AND HEREBY RETAINED.
 - INDICATES STREET LINE HEREBY ESTABLISHED.
 - INDICATES STREET LINE HERETOFORE ESTABLISHED AND HEREBY ELIMINATED.
 - INDICATES DIMENSION HEREBY ESTABLISHED.
 - INDICATES SIDEWALK AND ROADWAY TREATMENT HEREBY ESTABLISHED OR HERETOFORE ESTABLISHED AND RETAINED.
 - 15' INDICATES SIDEWALK AND ROADWAY TREATMENT DIMENSION HEREBY ESTABLISHED.
 - INDICATES PARK HERETOFORE ESTABLISHED AND HEREBY RETAINED.
 - INDICATES PARK HEREBY ESTABLISHED.
 - INDICATES PARK HERETOFORE ESTABLISHED AND HEREBY ELIMINATED.

MAP SHOWING A CHANGE IN THE STREET SYSTEM BY LAYING OUT THE LINES OF THE LOWER MANHATTAN EXPRESSWAY WITH RAMP APPROACHES THERETO FROM THE MILLER (WEST SIDE) HIGHWAY AND HOLLAND TUNNEL TO THE MANHATTAN AND WILLIAMSBURG BRIDGES BY LAYING OUT AN EXTENSION OF KENMARE STREET FROM LAFAYETTE STREET TO AVENUE OF THE AMERICAS BY ELIMINATING, WIDENING AND RELOCATING STREETS AND BY LAYING OUT PARK STRIPS ALL IN CONNECTION THEREWITH

Edward J. Kauf
ENGINEER OF PLANNING, B.P.M.

J.P.R.
ENGINEER OF DESIGN, B.P.M.

I, RUTH W. WHALEY, SECRETARY OF THE BOARD OF ESTIMATE OF THE CITY OF NEW YORK DO HEREBY CERTIFY THAT THIS MAP IS ONE OF FIVE SIMILAR MAPS ADOPTED BY THE SAID BOARD OF ESTIMATE ON THE 11th day of October, 1959.

DATED NEW YORK JAN 20 4 1960
Ruth W. Whaley
SECRETARY BOARD OF ESTIMATE

DATED: NOVEMBER 2, 1959

Anthony Demergo
ENGINEER

John T. Conell
CONSULTING ENGINEER

SCALE: AS NOTED

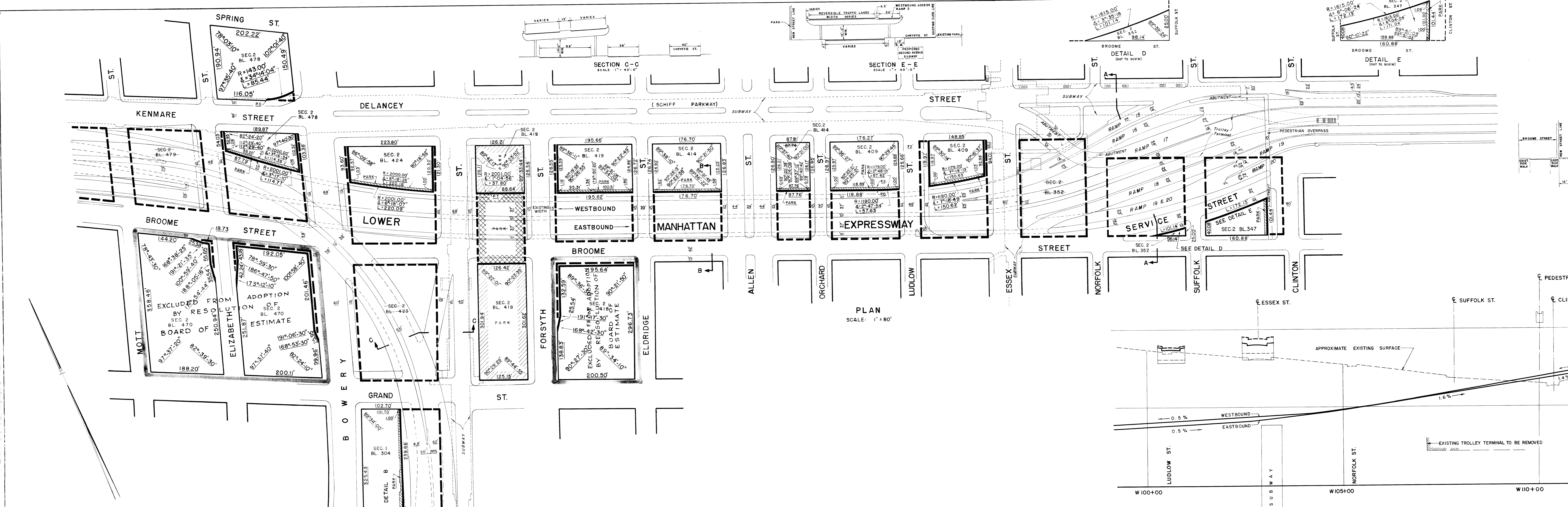

PLAN
SCALE: 1" = 80'

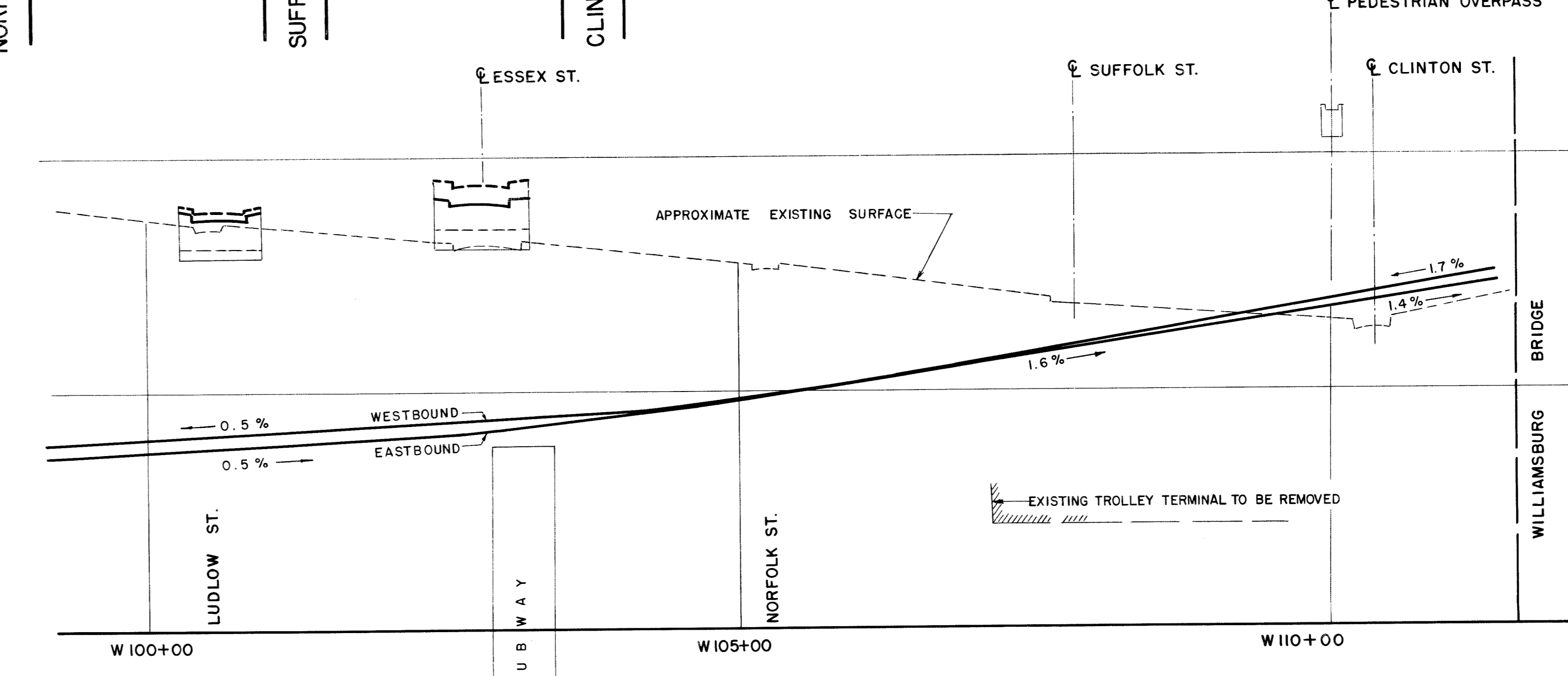

I, GUTH W. WHALEY, SECRETARY OF THE BOARD OF ESTIMATE OF THE CITY OF NEW YORK DO HEREBY CERTIFY THAT THIS MAP IS ONE OF FIVE SIMILAR MAPS ADOPTED BY THE SAID BOARD OF ESTIMATE ON THE 17th DAY OF JANUARY, 1959.
Guth W. Whaley
SECRETARY BOARD OF ESTIMATE

- NOTES**
- INDICATES STREET LINE HERETOFORE ESTABLISHED AND HEREBY RETAINED.
 - INDICATES STREET LINE HERETOFORE ESTABLISHED AND HEREBY ELIMINATED.
 - 200.76 INDICATES DIMENSION HEREBY ESTABLISHED.
 - - - INDICATES SIDEWALK AND ROADWAY TREATMENT HEREBY ESTABLISHED OR HERETOFORE ESTABLISHED AND RETAINED.
 - - - INDICATES SIDEWALK AND ROADWAY TREATMENT DIMENSION HEREBY ESTABLISHED.
 - - - INDICATES DIMENSION PREVIOUSLY ESTABLISHED AND HEREBY ELIMINATED.
 - INDICATES PARK HERETOFORE ESTABLISHED AND HEREBY RETAINED.
 - INDICATES PARK HEREBY ESTABLISHED.
 - INDICATES PARK HERETOFORE ESTABLISHED AND HEREBY ELIMINATED.
 - AREA WITHIN PINK BORDER EXCLUDED FROM ADOPTION BY RESOLUTION OF THE BOARD OF ESTIMATE.

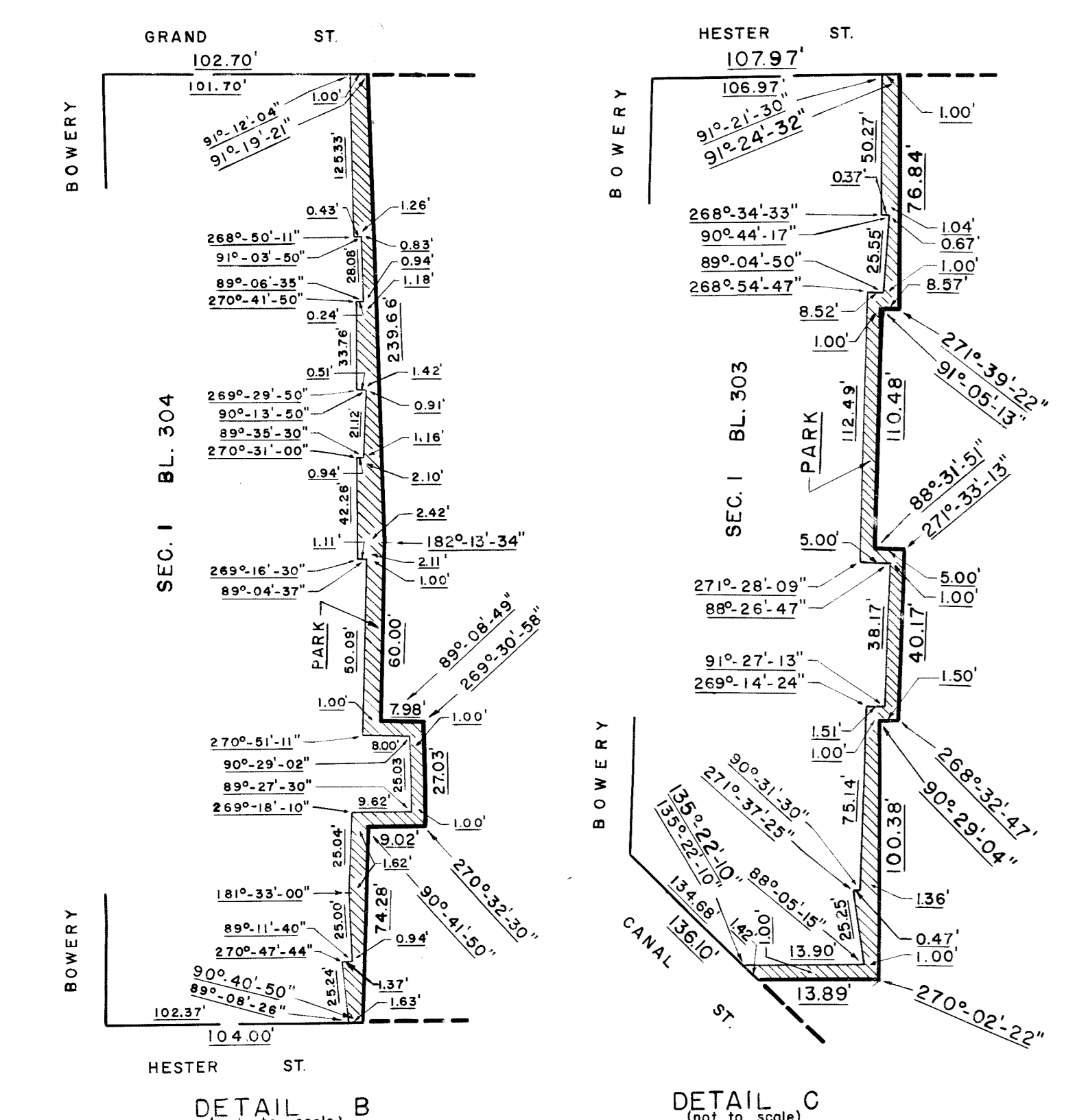

DETAIL B
SCALE: 1" = 10'

DETAIL C
SCALE: 1" = 10'

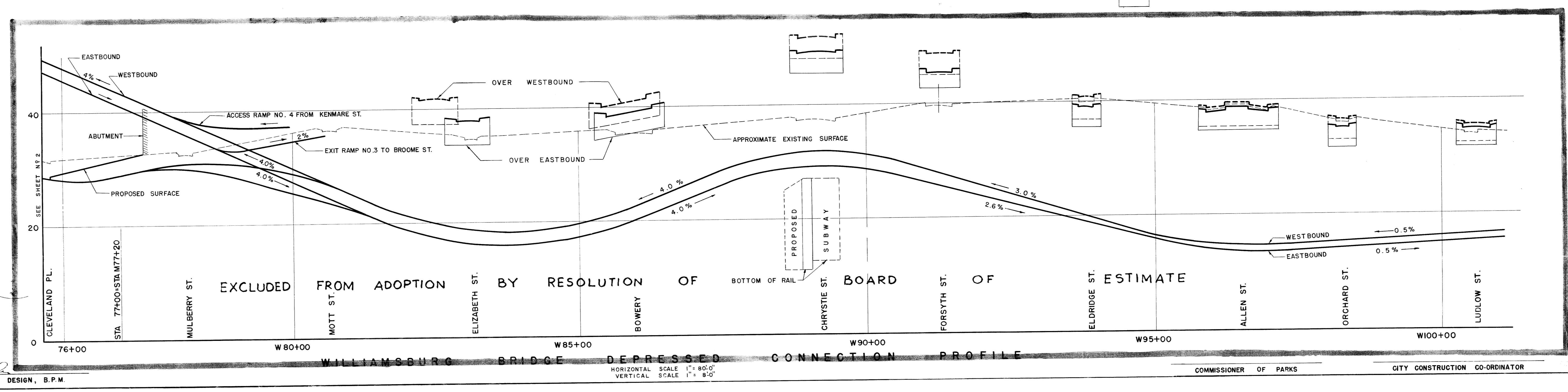

HORIZONTAL SCALE 1" = 80'
VERTICAL SCALE 1" = 10'

CITY OF NEW YORK
OFFICE OF THE PRESIDENT, BOROUGH OF MANHATTAN
DEPARTMENT OF BOROUGH WORKS

MAP SHOWING A CHANGE IN THE STREET SYSTEM
BY LAYING OUT THE LINES OF THE
LOWER MANHATTAN EXPRESSWAY
WITH RAMP APPROACHES THERETO
FROM THE MILLER (WEST SIDE) HIGHWAY AND
HOLLAND TUNNEL TO THE MANHATTAN AND WILLIAMSBURG BRIDGES
BY LAYING OUT AN
EXTENSION OF KENMARE STREET
FROM LAFAYETTE STREET TO AVENUE OF THE AMERICAS
BY ELIMINATING, WIDENING AND RELOCATING STREETS
AND BY LAYING OUT PARK STRIPS
ALL IN CONNECTION THEREWITH

DATED: NOVEMBER 2, 1959

Anthony Romano ENGINEER
John T. Conall CONSULTING ENGINEER

1956
G. Katz
PRESIDENT, BOROUGH OF MANHATTAN
COMMISSIONER OF PARKS
CITY CONSTRUCTION CO-ORDINATOR
ACC NO. 29666

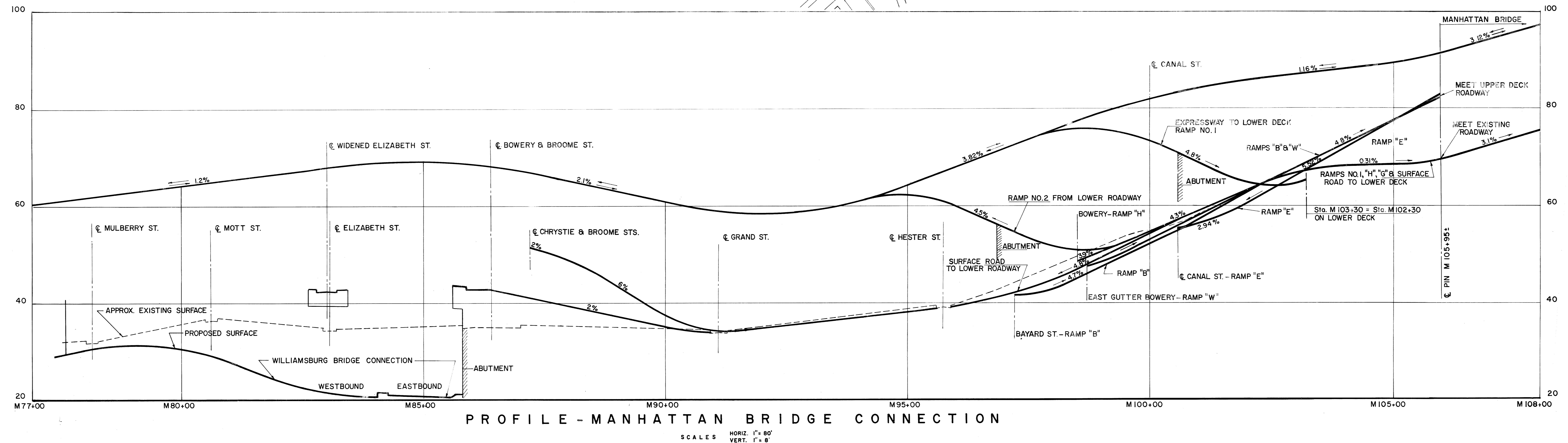
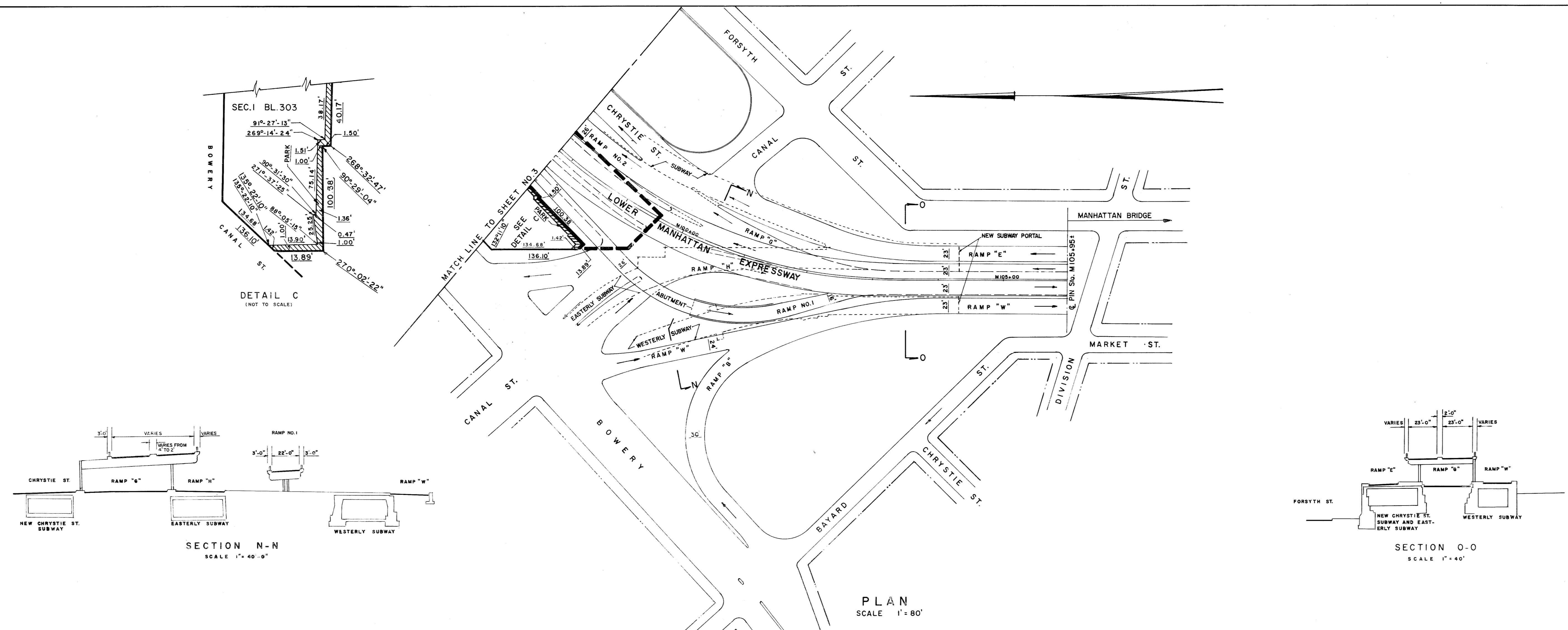

I, RUTH W. WHALEY, SECRETARY OF THE BOARD OF ESTIMATE OF THE CITY OF NEW YORK DO HEREBY CERTIFY THAT THIS MAP IS ONE OF FIVE SIMILAR MAPS ADOPTED BY THE SAID BOARD OF ESTIMATE ON THE 12th DAY OF JULY 1959.

DATED: NEW YORK, July 12, 1959

Ruth W. Whaley
SECRETARY, BOARD OF ESTIMATE

- NOTES
- INDICATES STREET LINE HERETOFORE ESTABLISHED AND HEREBY RETAINED.
 - - - INDICATES STREET LINE HEREBY ESTABLISHED.
 - - - INDICATES STREET LINE HERETOFORE ESTABLISHED AND HEREBY ELIMINATED.
 - 42.00' INDICATES DIMENSION HEREBY ESTABLISHED.
 - 15' INDICATES SIDEWALK AND ROADWAY TREATMENT HEREBY ESTABLISHED OR HERETOFORE ESTABLISHED AND RETAINED.
 - INDICATES SIDEWALK AND ROADWAY TREATMENT DIMENSION HEREBY ESTABLISHED.
 - INDICATES PARK HERETOFORE ESTABLISHED AND HEREBY RETAINED.
 - INDICATES PARK HEREBY ESTABLISHED.
 - INDICATES PARK HERETOFORE ESTABLISHED AND HEREBY ELIMINATED.

CITY OF NEW YORK
OFFICE OF THE PRESIDENT, BOROUGH OF MANHATTAN
DEPARTMENT OF BOROUGH WORKS

MAP SHOWING A CHANGE IN THE STREET SYSTEM BY LAYING OUT THE LINES OF THE
LOWER MANHATTAN EXPRESSWAY
WITH RAMP APPROACHES THERETO
FROM THE MILLER (WEST SIDE) HIGHWAY AND HOLLAND TUNNEL TO THE MANHATTAN AND WILLIAMSBURG BRIDGES BY LAYING OUT AN
EXTENSION OF KENMARE STREET FROM LAFAYETTE STREET TO AVENUE OF THE AMERICAS BY ELIMINATING, WIDENING AND RELOCATING STREETS AND BY LAYING OUT PARK STRIPS ALL IN CONNECTION THEREWITH

DATED: NOVEMBER 2, 1959

SCALE: AS NOTED

Anthony Romo
CITY ENGINEER

John T. Canoll
CONSULTING ENGINEER

John T. Canoll
PRESIDENT, BOROUGH OF MANHATTAN

Edmund J. Kauf
ENGINEER OF PLANNING, B.P.M.

S. G. R.
ENGINEER OF DESIGN, B.P.M.

CITY CONSTRUCTION CO-ORDINATOR

COMMISSIONER OF PARKS



HUDSON ST. RELOCATION PROFILE

RAMP NO. 8 PROFILE
TUNNEL TO EXPRESSWAY E.B. & WESTBOUND NO. II (WEST SIDE HIGHWAY N.B.)

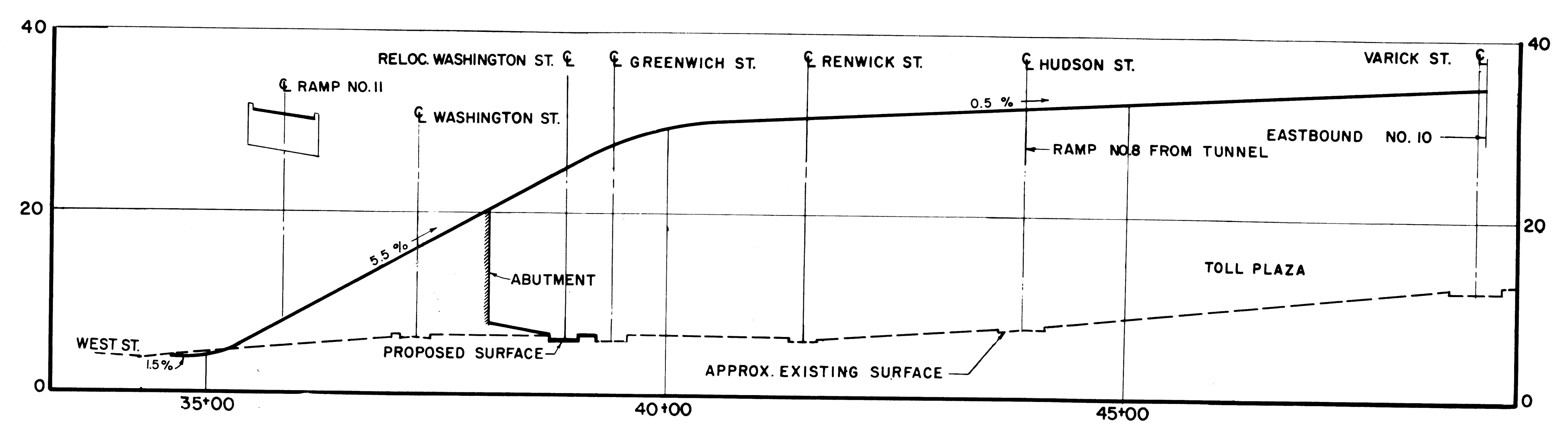

RAMP NO. 9 PROFILE
ACCESS TO EXPRESSWAY E.B.

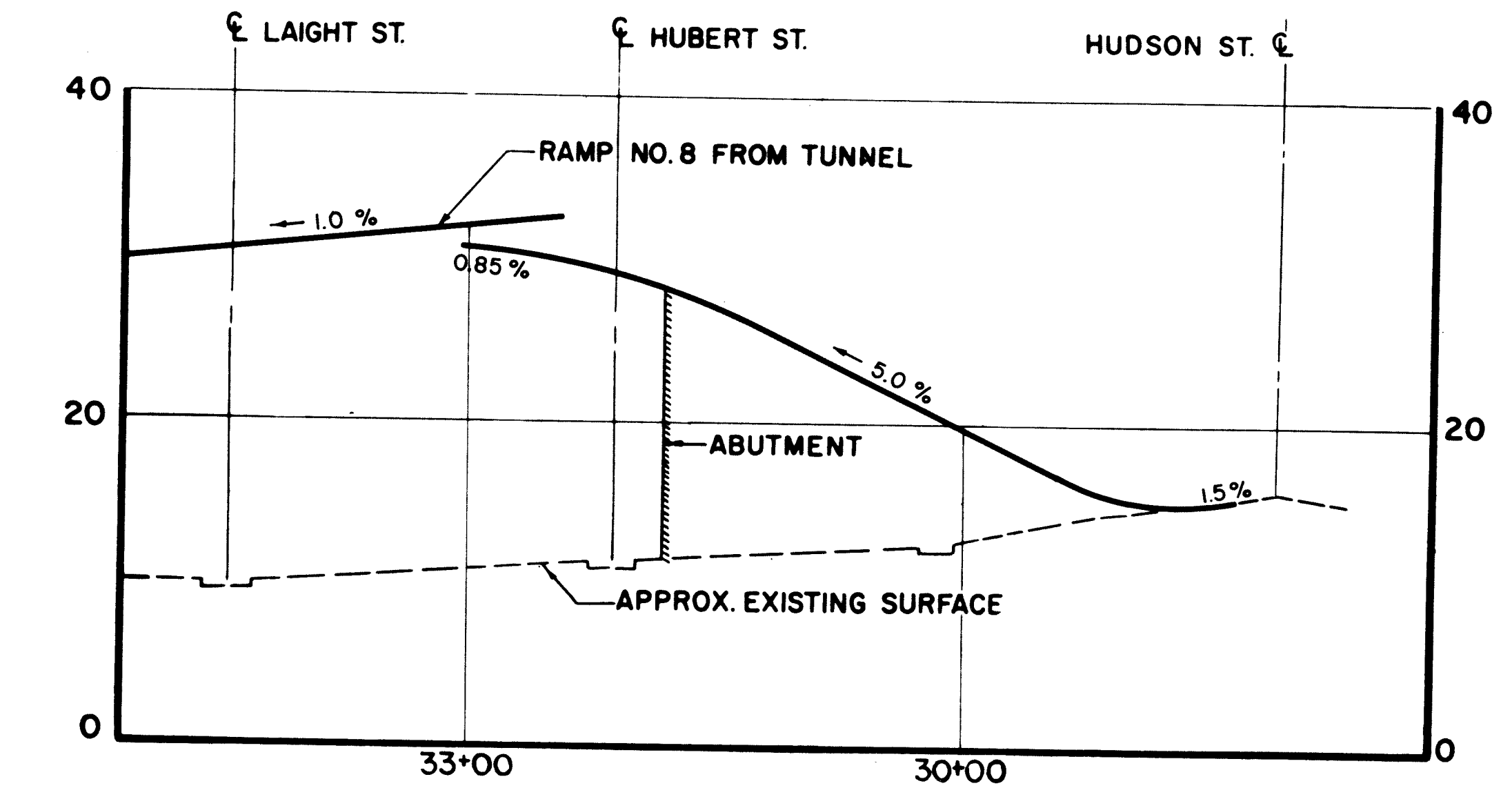

RAMP NO. 7 PROFILE
HUDSON ST. TO EXPRESSWAY E.B. & WEST SIDE HIGHWAY N.B.

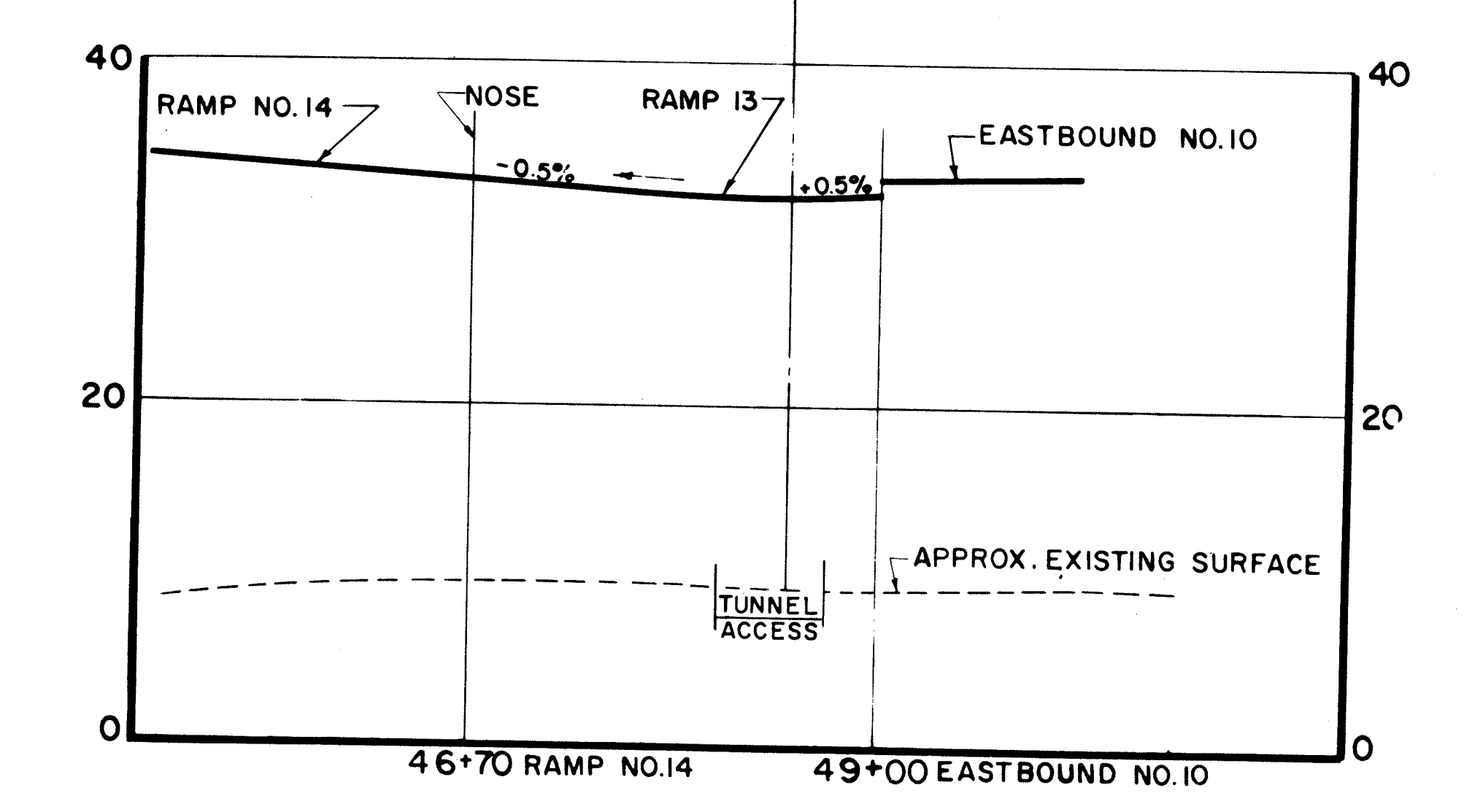

RAMP NO. 13 PROFILE

LEGEND

APPROX. EXISTING GRADE

NOTE: PROFILES, EXISTING AND PROPOSED SURFACE TAKEN ON E

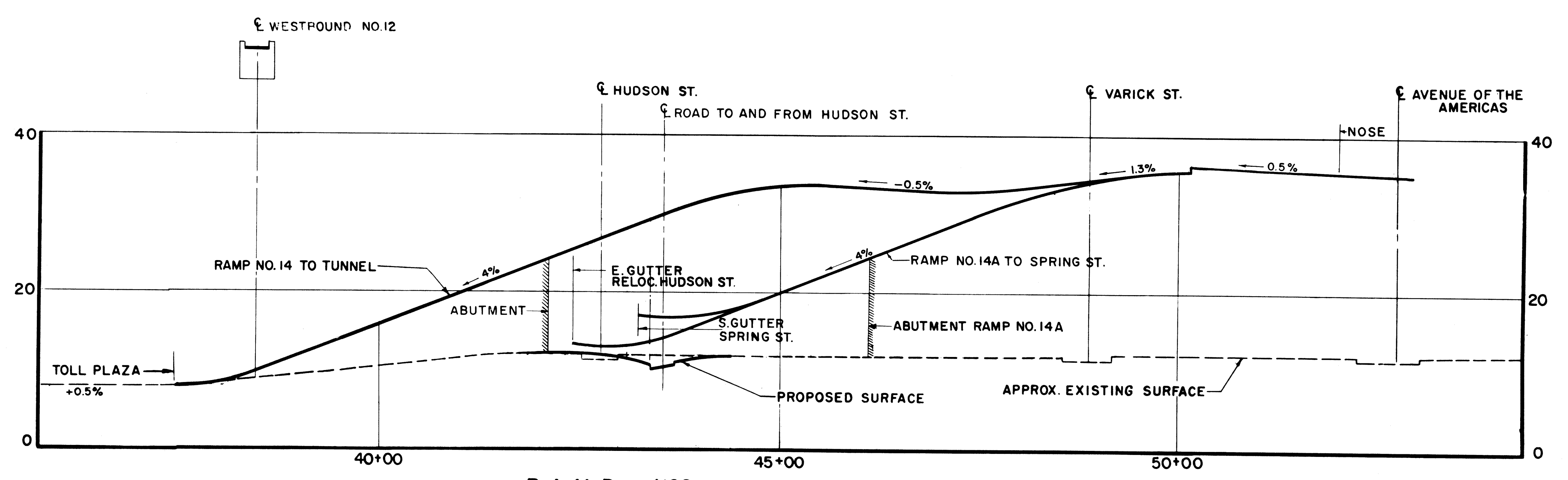

RAMP NOS. 14 & 14A PROFILES
EXPRESSWAY W.B. TO TUNNEL & SPRING ST.

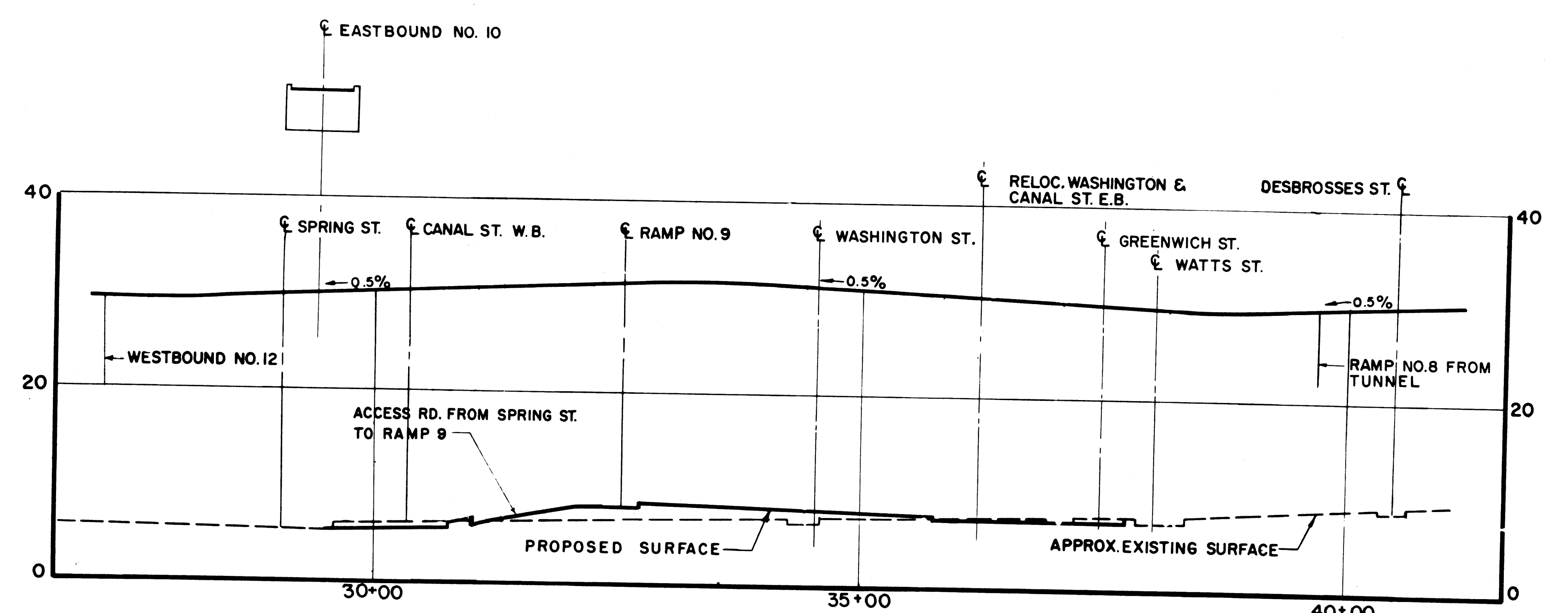

WESTBOUND RAMP NO. II PROFILE
RAMP NO. 8 FROM TUNNEL TO WEST SIDE HIGHWAY N.B.

I, RUTH W. WHALEY, SECRETARY OF THE BOARD OF ESTIMATE OF THE CITY OF NEW YORK DO HEREBY CERTIFY THAT THIS MAP IS ONE OF FIVE SIMILAR MAPS ADOPTED BY THE SAID BOARD OF ESTIMATE ON THE 27th DAY OF MARCH 1959.

DATED: NEW YORK, NOV 2, 1959

Ruth W. Whaley
SECRETARY, BOARD OF ESTIMATE

CITY OF NEW YORK
OFFICE OF THE PRESIDENT, BOROUGH OF MANHATTAN
DEPARTMENT OF BOROUGH WORKS

MAP SHOWING A CHANGE IN THE STREET SYSTEM BY LAYING OUT THE LINES OF THE LOWER MANHATTAN EXPRESSWAY WITH RAMP APPROACHES THERETO FROM THE MILLER (WEST SIDE) HIGHWAY AND HOLLAND TUNNEL TO THE MANHATTAN AND WILLIAMSBURG BRIDGES BY LAYING OUT AN EXTENSION OF KENMARE STREET FROM LAFAYETTE STREET TO AVENUE OF THE AMERICAS BY ELIMINATING, WIDENING AND RELOCATING STREETS AND BY LAYING OUT PARK STRIPS ALL IN CONNECTION THEREWITH

DATED NOVEMBER 2, 1959

SCALE HOR. 1"=80'
VER. 1"=6'

Shmuel I. Karp
ENGINEER OF PLANNING, B.P.M.

S. Blum
ENGINEER OF DESIGN, B.P.M.

CITY CONSTRUCTION CO-ORDINATOR

Anthony Demergo
CHIEF ENGINEER

John T. Canoll
CONSULTING ENGINEER

COMMISSIONER OF PARKS

Shmuel I. Karp
PRESIDENT, BOROUGH OF MANHATTAN

ACC. No. 29666

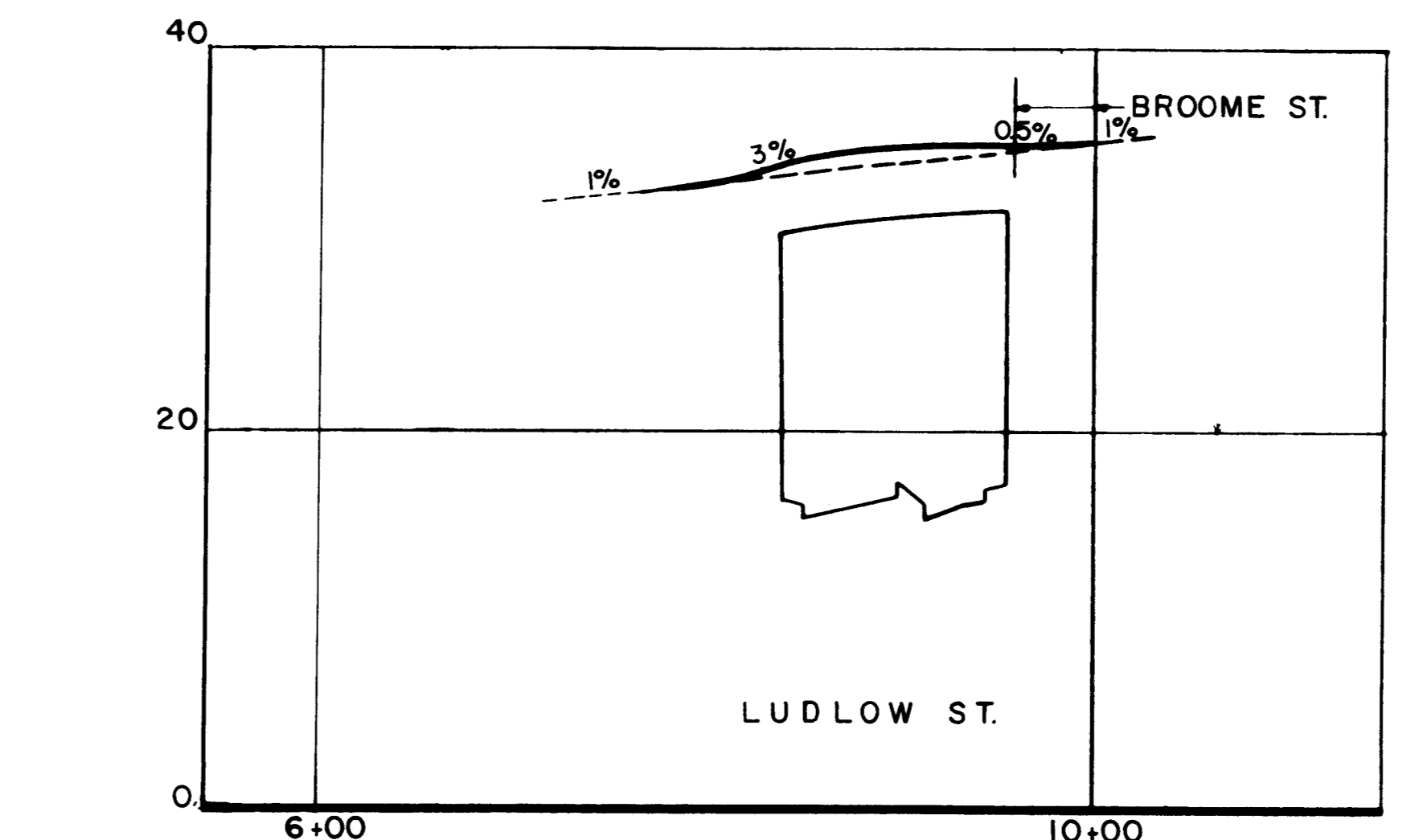
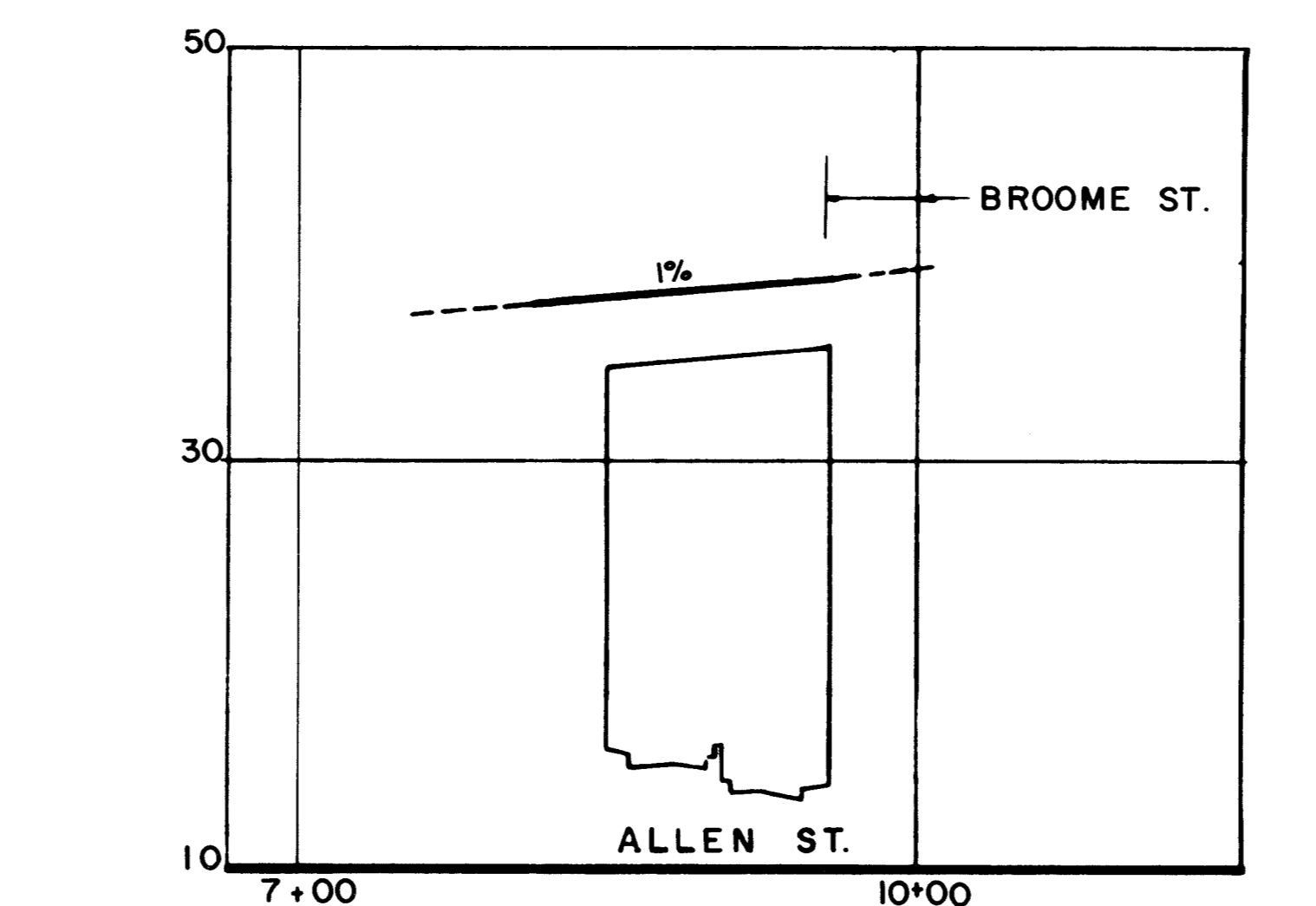
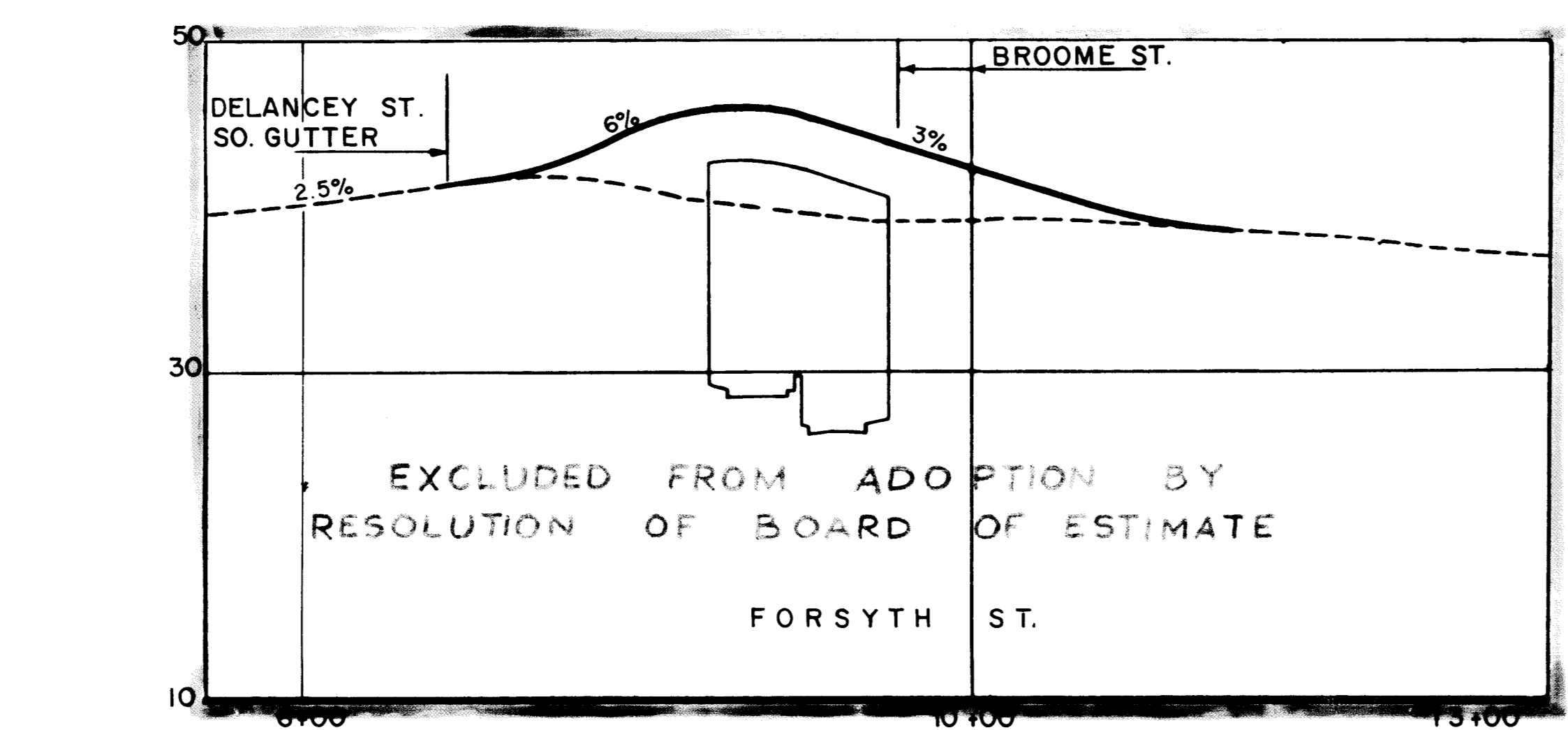
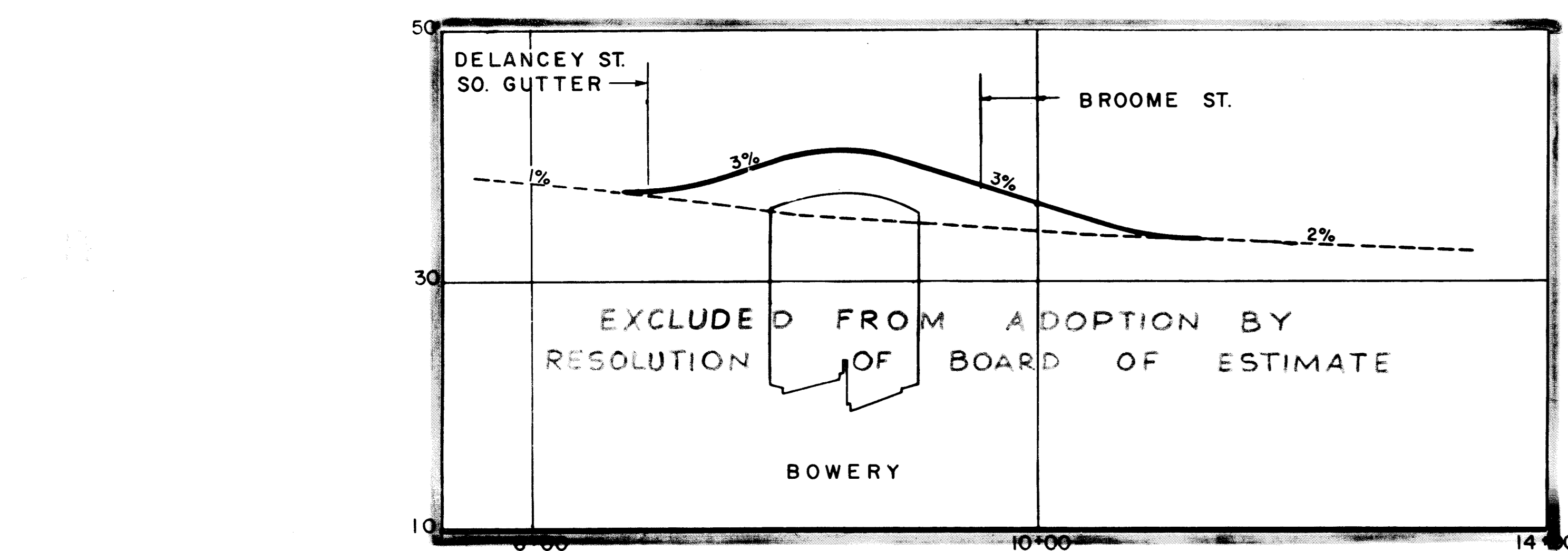
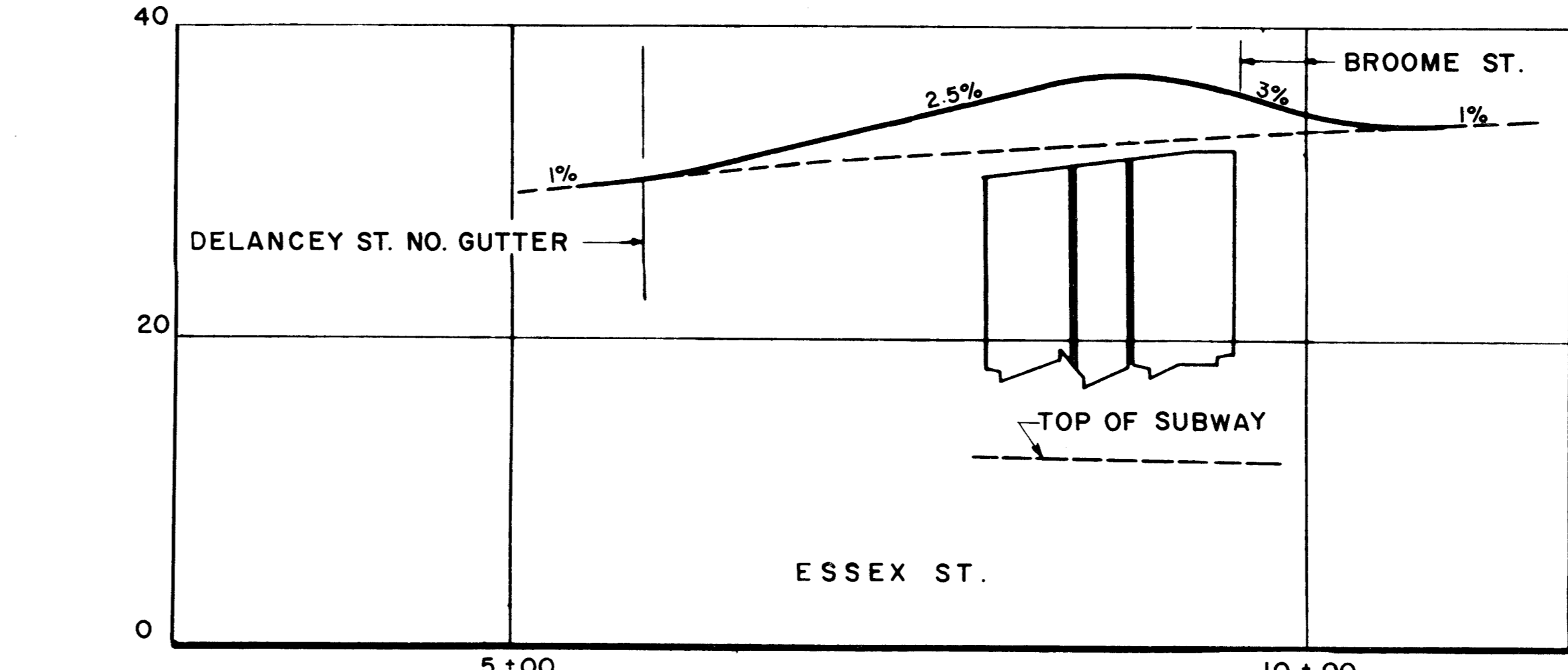
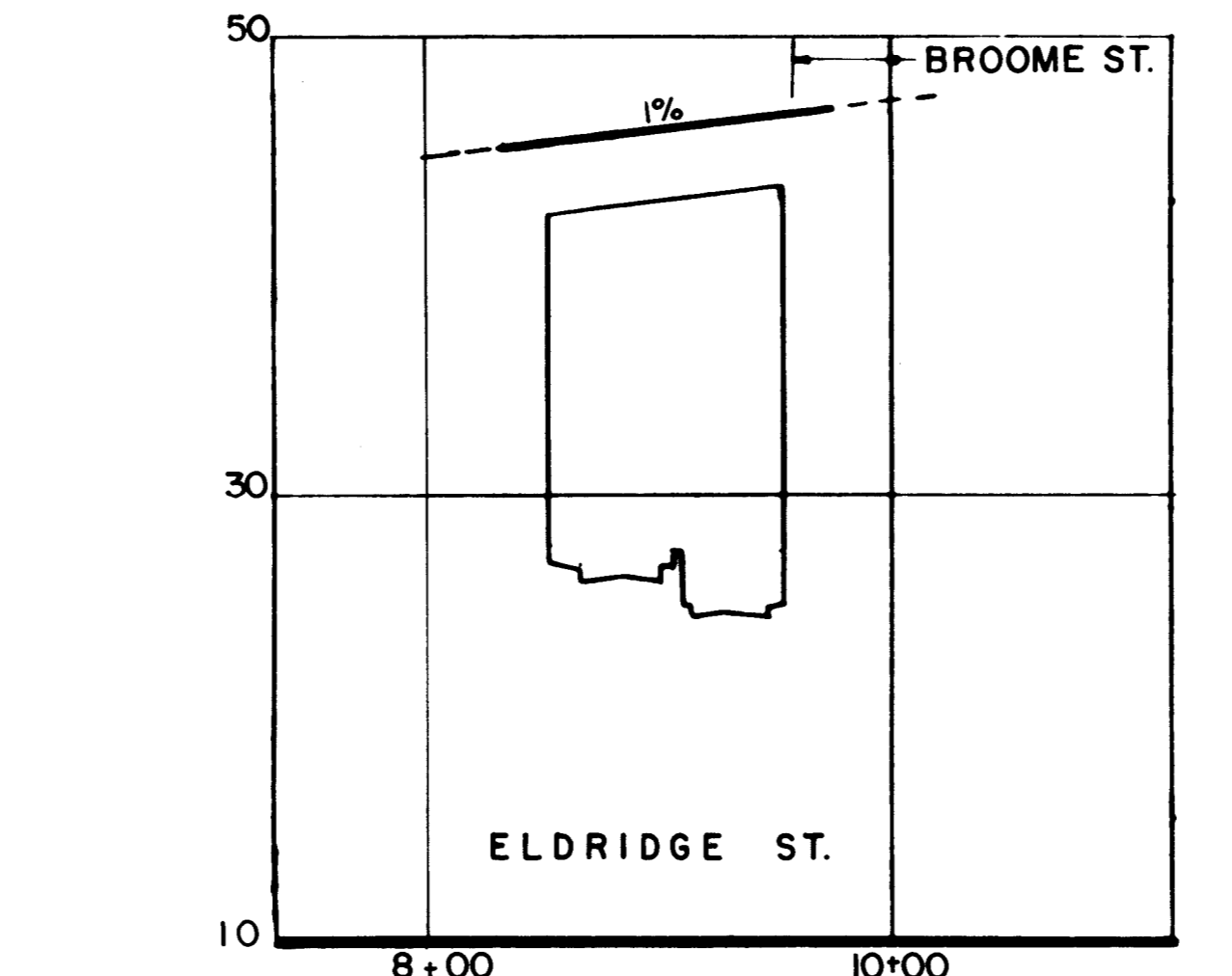
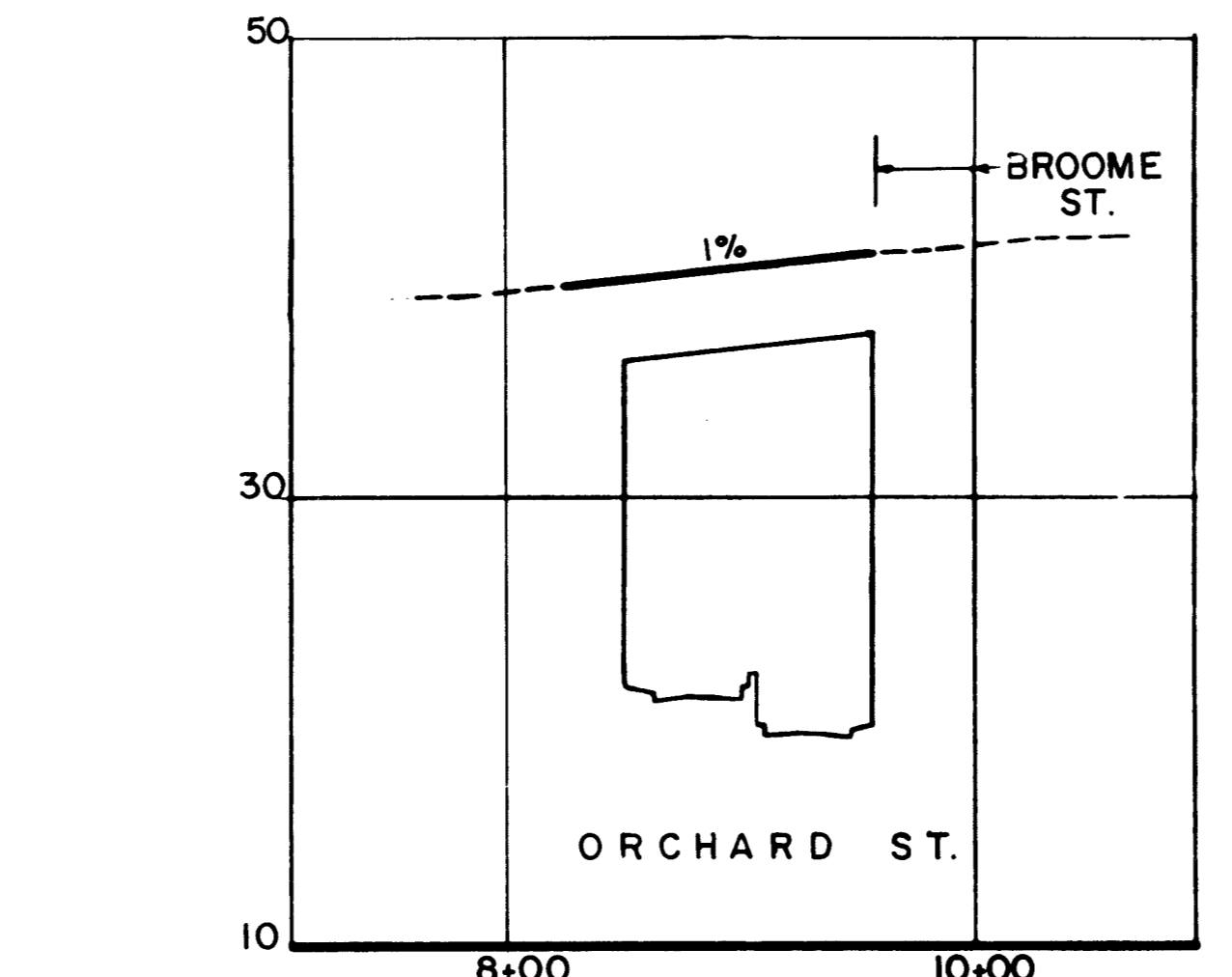
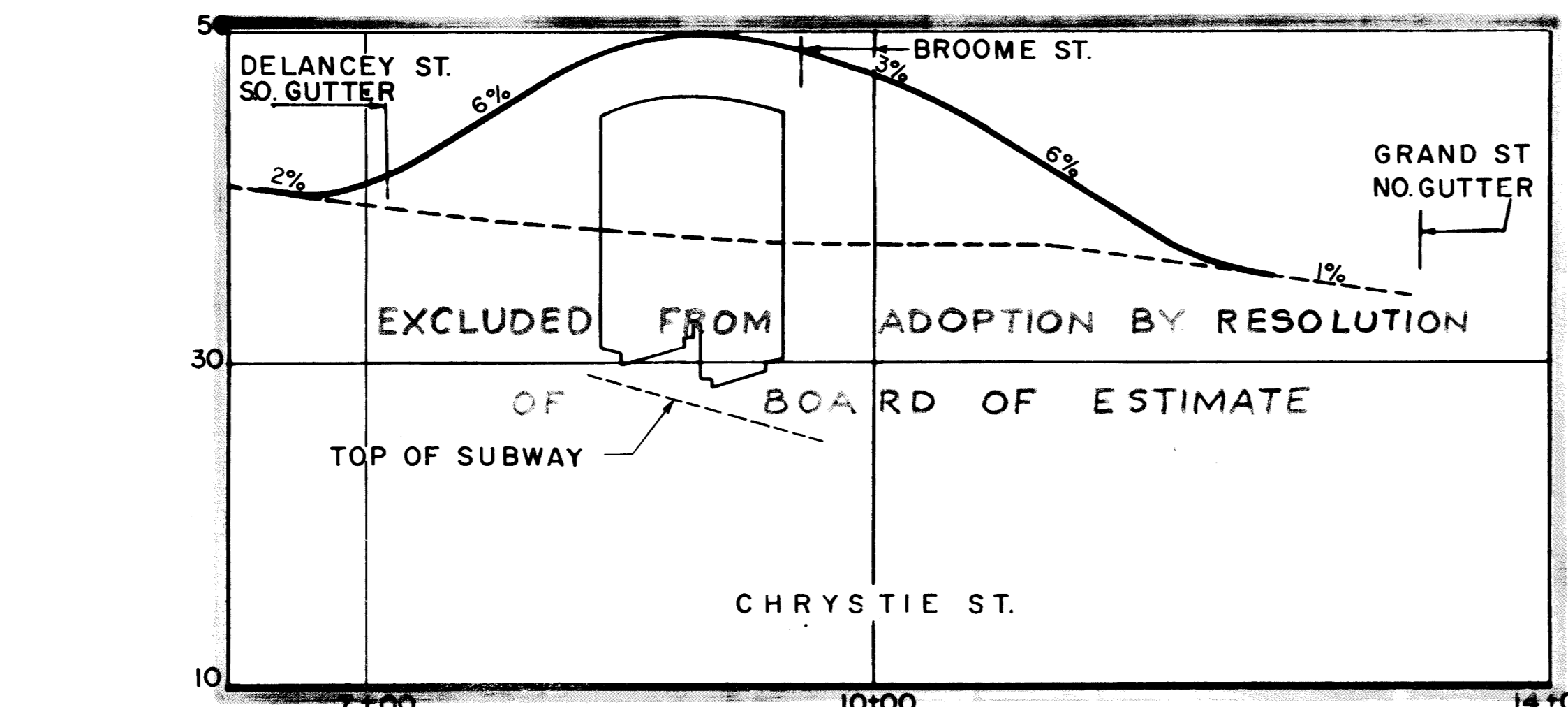
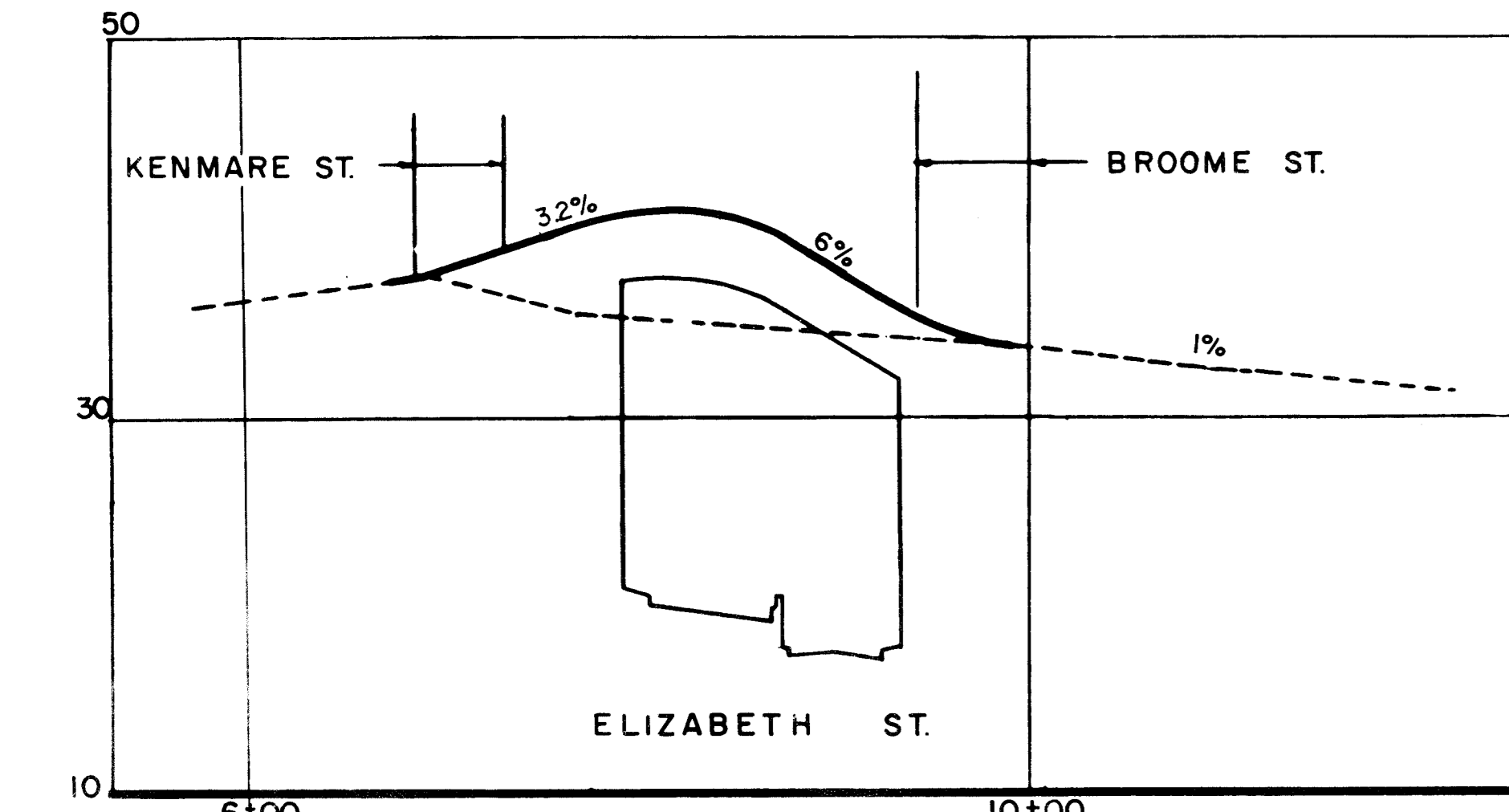
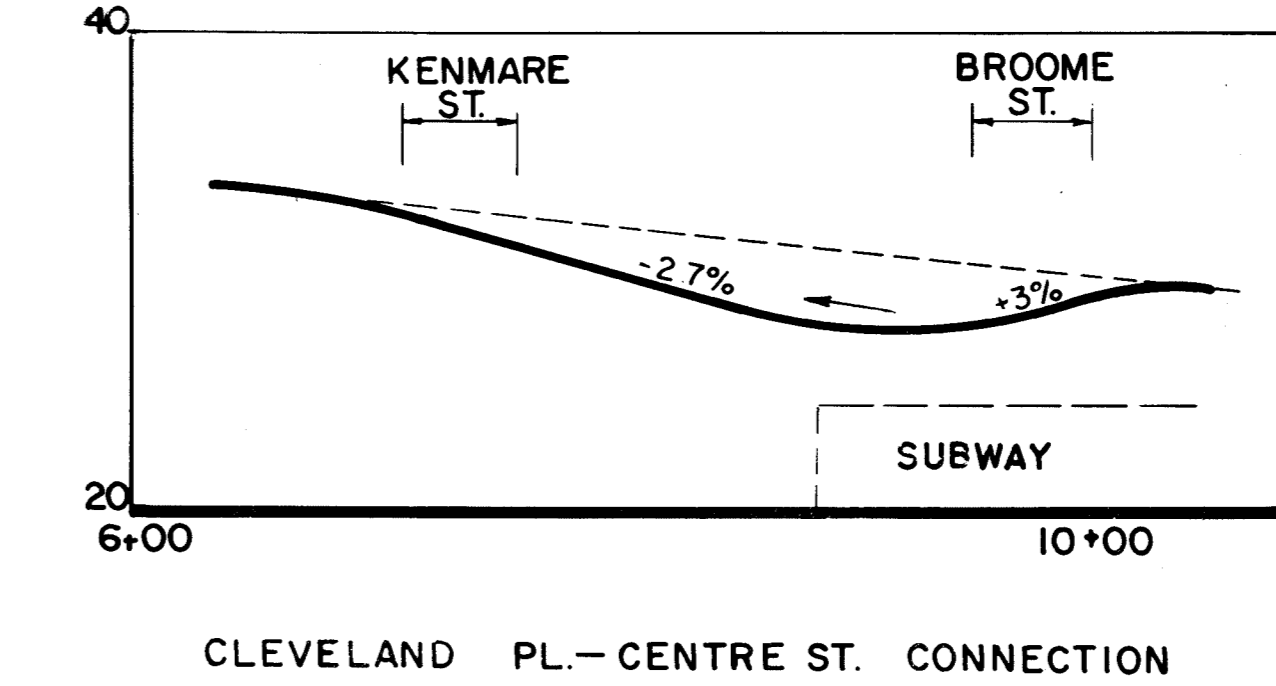
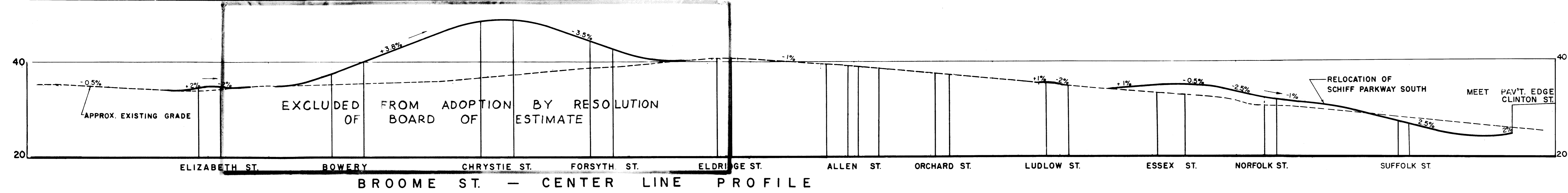

LEGEND

AREA WITHIN PINK BORDER EXCLUDED FROM ADOPTION BY RESOLUTION OF THE BOARD OF ESTIMATE.

APPROX. EXISTING GRADE

NOTE: PROFILES, EXISTING AND PROPOSED SURFACE TAKEN ON E

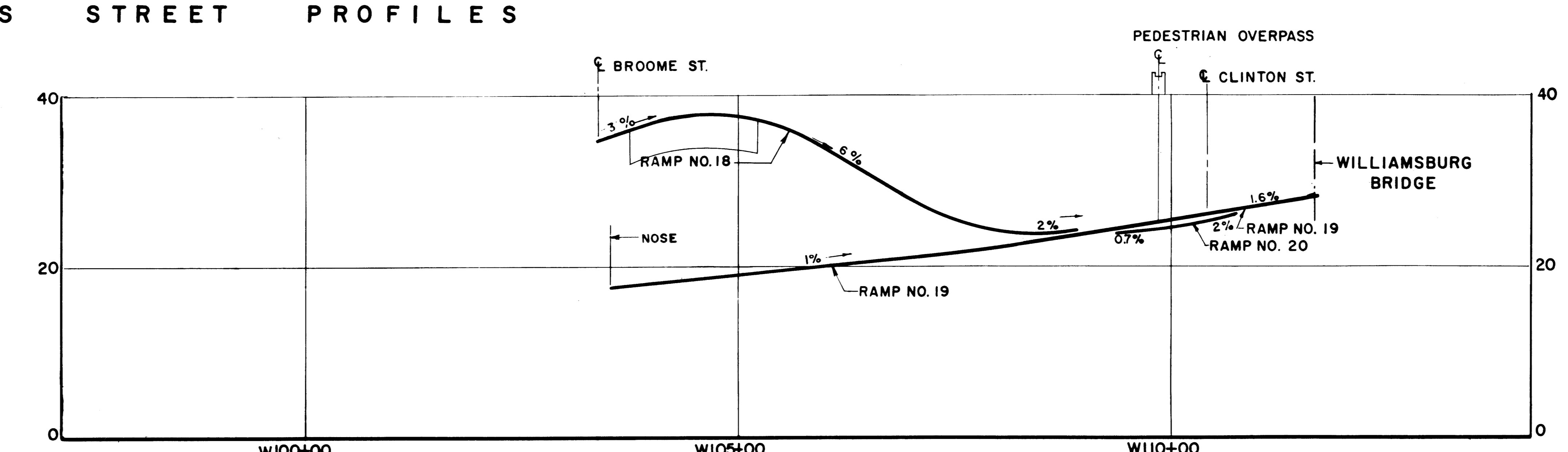
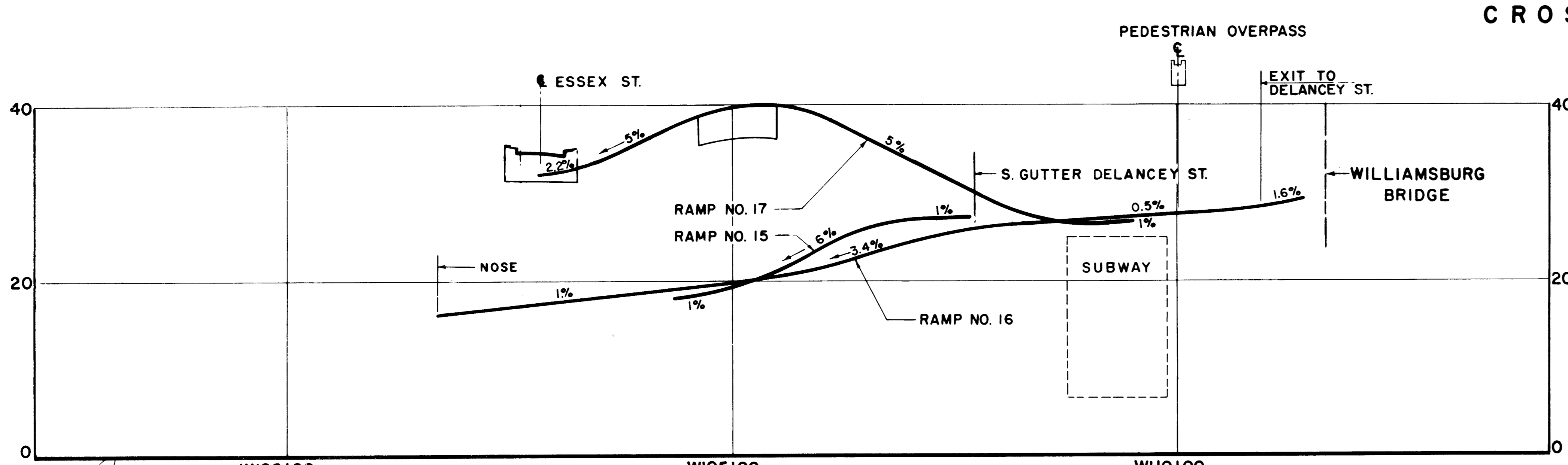

RAMP PROFILES

NO.15 FROM DELANCEY STREET TO DEPRESSED CONNECTION

NO.16 FROM WILLIAMSBURG BRIDGE TO DEPRESSED CONNECTION

NO.17 FROM WILLIAMSBURG BRIDGE TO DELANCEY STREET

RAMP PROFILES

NO.18 FROM BROOME STREET TO WILLIAMSBURG BRIDGE

NO.19 FROM DEPRESSED CONNECTION TO WILLIAMSBURG BRIDGE

NO.20 FROM DEPRESSED CONNECTION TO STREET

I, RUTH W. WHALEY, SECRETARY OF THE BOARD OF ESTIMATE OF THE CITY OF NEW YORK DO HEREBY CERTIFY THAT THIS MAP IS ONE OF FIVE SIMILAR MAPS ADOPTED BY THE SAID BOARD OF ESTIMATE ON THE 12th day of APRIL 22 DATED NEW YORK 1955

Ruth W. Whaley
SECRETARY BOARD OF ESTIMATE

CITY OF NEW YORK
OFFICE OF THE PRESIDENT
BOROUGH OF MANHATTAN
DEPARTMENT OF BOROUGH WORKS

MAP SHOWING A CHANGE IN THE STREET SYSTEM BY LAYING OUT THE LINES OF THE LOWER MANHATTAN EXPRESSWAY WITH RAMP APPROACHES THERETO FROM THE MILLER (WEST SIDE) HIGHWAY AND HOLLAND TUNNEL TO THE MANHATTAN AND WILLIAMSBURG BRIDGES BY LAYING OUT AN EXTENSION OF KENMARE STREET FROM LAFAYETTE STREET TO AVENUE OF THE AMERICAS BY ELIMINATING, WIDENING AND RELOCATING STREETS AND BY LAYING OUT PARK STRIPS ALL IN CONNECTION THEREWITH

Edward J. Kepp
ENGINEER OF PLANNING, S.P.M.

S. A. L.
ENGINEER OF DESIGN, S.P.M.

DATED NOVEMBER 2, 1955

CITY CONSTRUCTION CO-ORDINATOR

Anthony D'Amico
CHIEF ENGINEER

John T. Caswell
CONSULTING ENGINEER

COMMISSIONER OF PARKS

John T. Caswell
PRESIDENT, BOROUGH OF MANHATTAN

SCALE: HOR. 1"=80' VER. 1"=8'