

TO BE ACQUIRED FROM
N. Y. C. R. R. BY AGREEMENT

TO BE ACQUIRED FROM
N. Y. C. R. R. BY AGREEMENT

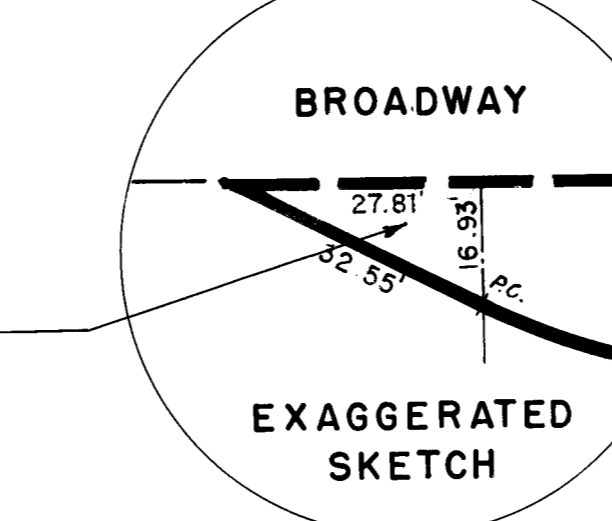

I, RUTH W. WHALEY, SECRETARY OF THE BOARD OF ESTIMATE OF THE CITY OF NEW YORK DO HEREBY CERTIFY THAT THIS MAP IS ONE OF FIVE SIMILAR MAPS ADOPTED BY THE SAID BOARD OF ESTIMATE ON THE 11th DAY OF JULY, 1955.
DATED: NEW YORK
Ruth W. Whaley
SECRETARY BOARD OF ESTIMATE
N.Y.

FOR EARLIER LAYOUTS OF THIS AREA SEE ACC. NO. 4960, 6330, 8058 & 28976

- INDICATES STREET LINE HERETOFORE ESTABLISHED AND HEREBY RETAINED.
- INDICATES STREET LINE HEREBY ESTABLISHED, AND HEREBY ELIMINATED.
- 420.00' INDICATES DIMENSION HERETOFORE ESTABLISHED AND HEREBY RETAINED.
- 285.00' INDICATES DIMENSION HEREBY ESTABLISHED.
- ±0'-0" INDICATES DIMENSION HERETOFORE ESTABLISHED AND HEREBY ELIMINATED.
- INDICATES SIDEWALK AND ROADWAY TREATMENT HEREBY ESTABLISHED OR HERETOFORE ESTABLISHED AND RETAINED.
- 15' INDICATES SIDEWALK AND ROADWAY TREATMENT DIMENSION HERETOFORE ESTABLISHED AND RETAINED.
- 15' INDICATES SIDEWALK AND ROADWAY TREATMENT DIMENSION HEREBY ESTABLISHED.
- INDICATES PARK HERETOFORE ESTABLISHED AND HEREBY RETAINED.
- INDICATES LINE OF BRIDGE APPROACH

CITY OF NEW YORK
OFFICE OF THE PRESIDENT BOROUGHS OF MANHATTAN
DEPARTMENT OF BOROUGHS WORKS
MAP SHOWING A CHANGE IN THE STREET SYSTEM
BY WIDENING
BROADWAY
FROM W. 218TH STREET TO W. 230TH STREET
AND BY ESTABLISHING ROADWAY TREATMENT THEREFOR
FROM W. 215TH STREET TO KIMBERLY PLACE IN THE BRONX
IN CONNECTION WITH THE
APPROACHES TO THE BROADWAY BRIDGE

DATED: OCT. 19, 1955 SCALE: 1" = 80'
Walter D. Drayton
PRESIDENT BOROUGHS OF MANHATTAN
CHIEF ENGINEER

DRAWN BY: JUN, E.C.O.N.J.
CHECKED BY: F.S.
F. S. [Signature]
SECTION ENGINEER
Edward Keat
ENGINEER OF PLANNING
S. C. [Signature]
ENGINEER OF DESIGN

ACC. 5