

I, RUTH W. WHALEY, SECRETARY OF THE BOARD OF ESTIMATE OF THE CITY OF NEW YORK DO HEREBY CERTIFY THAT THIS MAP IS ONE OF FIVE SIMILAR MAPS ADOPTED BY THE SAID BOARD OF ESTIMATE ON THE 25TH DAY OF MARCH 1959

DATED: NEW YORK MAY 4, 1959

Ruth W. Whaley
SECRETARY BOARD OF ESTIMATE
#7.

NOTES

- INDICATES STREET LINE HERETOFORE ESTABLISHED AND HEREBY RETAINED.
 - INDICATES STREET LINE HEREBY ESTABLISHED.
 - INDICATES STREET LINE HERETOFORE ESTABLISHED AND HEREBY ELIMINATED.
 - 60' INDICATES DIMENSION HERETOFORE ESTABLISHED AND HEREBY RETAINED.
 - 45.00' INDICATES DIMENSION HEREBY ESTABLISHED.
 - - - - - INDICATES SIDEWALK AND ROADWAY TREATMENT HERETOFORE ESTABLISHED AND HEREBY ELIMINATED.
 - - - - - INDICATES SIDEWALK AND ROADWAY TREATMENT HEREBY ESTABLISHED OR HERETOFORE ESTABLISHED AND RETAINED.
 - 15' INDICATES SIDEWALK AND ROADWAY TREATMENT DIMENSION HERETOFORE ESTABLISHED AND RETAINED.
 - 15' INDICATES SIDEWALK AND ROADWAY TREATMENT DIMENSION HEREBY ESTABLISHED.
 -  INDICATES PARK HERETOFORE ESTABLISHED AND HEREBY RETAINED.
 - 39.75' INDICATES ELEVATIONS HEREBY ESTABLISHED.
 - 96' INDICATES TIE-IN DISTANCES TO ELEVATIONS HEREBY ESTABLISHED.
- ELEVATIONS ARE FOR TOP OF CURB AND ARE REFERRED TO THE BOROUGH WORKS DATUM OF THE BOROUGH OF MANHATTAN WHICH IS 2.75 FEET ABOVE THE U.S.C.&G. DATUM AT SANDY HOOK.

CITY OF NEW YORK
OFFICE OF THE PRESIDENT BOROUGH OF MANHATTAN
DEPARTMENT OF BOROUGH WORKS

MAP SHOWING A CHANGE IN THE STREET SYSTEM
BY MODIFYING THE NORTHERLY LINE OF
ASTOR PLACE
BETWEEN 3RD AVENUE AND 4TH AVENUE
AND BY ESTABLISHING GRADES AND ROADWAY TREATMENT
IN THE AREA BOUNDED BY
EAST 6TH STREET, COOPER SQUARE, ASTOR PLACE, 4TH AVENUE,
EAST NINTH STREET, 3RD AVENUE AND COOPER SQUARE

DATED: OCT. 27, 1958.

SCALE - 1" = 50'

Anthony Donarzo
PRESIDENT BOROUGH OF MANHATTAN
Anthony Donarzo
CHIEF ENGINEER

FILED IN THE OFFICE OF THE PRES. BORO. MAN.
MAY 5TH 1959 G. KATZ

ACC. No. 29577

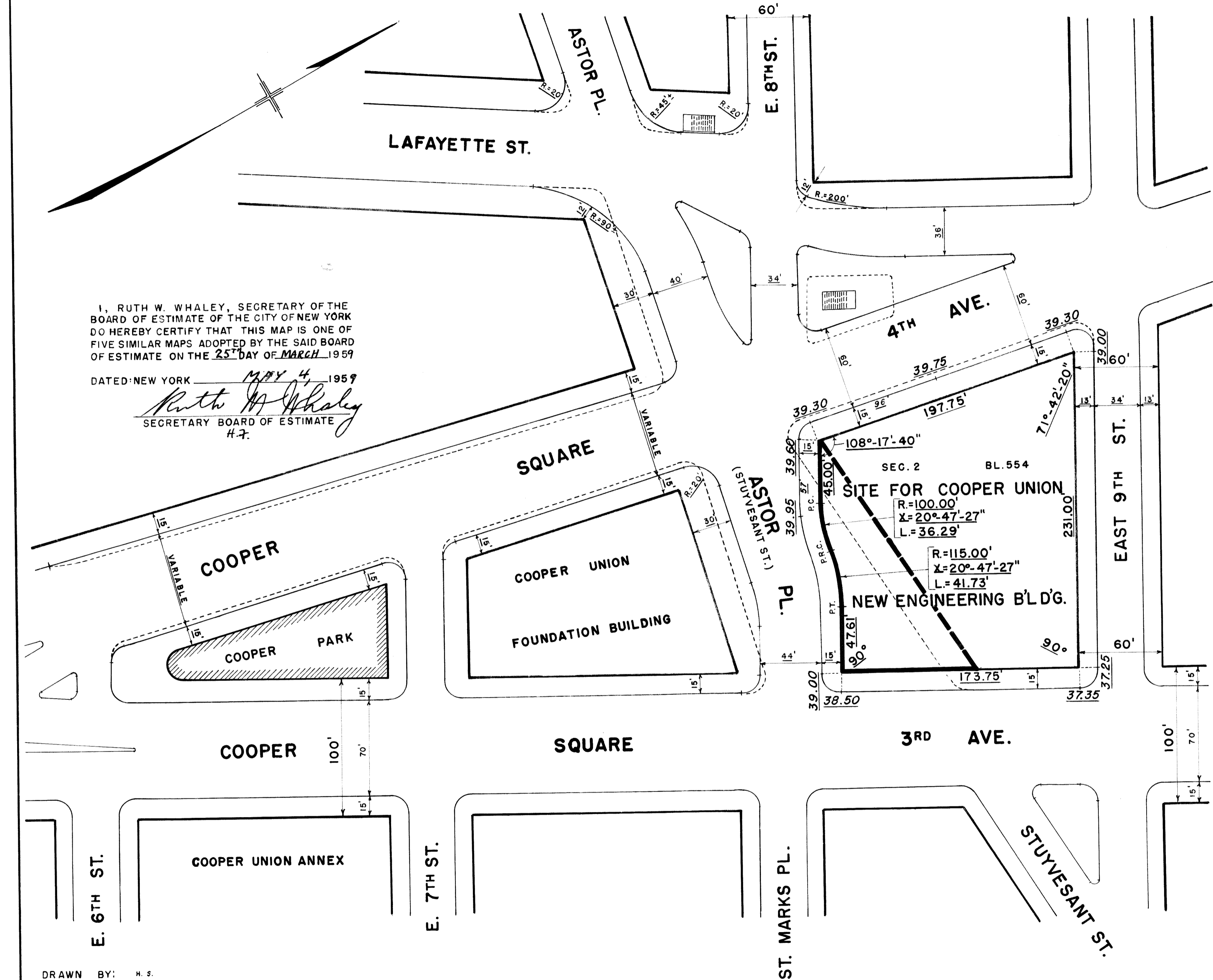

DRAWN BY: H.S.
CHECKED BY: F.S.

F. Sanchez SECTION ENGINEER
Edmund J. Katz ENGINEER OF PLANNING
S. John ENGINEER OF DESIGN

Draw 19