

NOTES

1. LINES AND DIMENSIONS OF STREETS PREVIOUSLY ESTABLISHED AND HEREBY RETAINED ARE SHOWN BY FULL BLACK LINES AND BLACK FIGURES.

2. LINES AND DIMENSIONS OF STREETS HEREBY ESTABLISHED ARE SHOWN BY FULL RED LINES AND RED FIGURES.

3. LINES OF STREETS AND PARKS HEREBY ELIMINATED ARE SHOWN BY DASHED RED LINES.

4. DIMENSIONS PREVIOUSLY ESTABLISHED AND HEREBY ELIMINATED ARE SHOWN BY BLACK FIGURES CROSSED BY A BLACK LINE.

5. LINES OF BATTERY PARK UNDERPASS AND PLAZA UNDERPASS WITHIN THE AREA OF PUBLIC STREETS ARE ROADWAY TREATMENT AND ARE SHOWN BY THIN SOLID RED LINES AND WHERE UNDERGROUND ARE SHOWN BY THIN DASHED AND DOTTED RED LINES.

6. LINES OF BATTERY PARK UNDERPASS WITHIN PARK AND LINES OF PLAZA UNDERPASS WITHIN THE MANHATTAN APPROACHES TO THE BROOKLYN-BATTERY TUNNEL ARE HEREBY LAID OUT AS PUBLIC STREETS AND ARE SHOWN BY HEAVY DASHED AND DOTTED RED LINES.

7. GRADES HEREBY ESTABLISHED ARE SHOWN BY VERTICAL RED FIGURES. EXISTING SURFACE ELEVATIONS ARE SHOWN BY VERTICAL BLACK FIGURES ENCLOSED IN A PARENTHESIS AND WHERE HEREBY DISCONTINUED ARE CROSSED BY A BLACK LINE.

8. ELEVATIONS SHOWN ON THIS MAP FOR TOP OR BOTTOM OF CURB ARE REFERRED TO THE BOROUGH WORKS DATUM OF THE BOROUGH OF MANHATTAN WHICH IS 2.750 FEET ABOVE MEAN SEA LEVEL AT SANDY HOOK.

9. ELEVATIONS, TOP OF CURB ARE SHOWN THUS..... 5.10' E.

10. ELEVATIONS, BOTTOM OF CURB ARE SHOWN THUS..... 5.10' B.

11. STATIONING ON THIS SHEET IS ALONG THE EAST CURB LINE OF STRUCTURE.

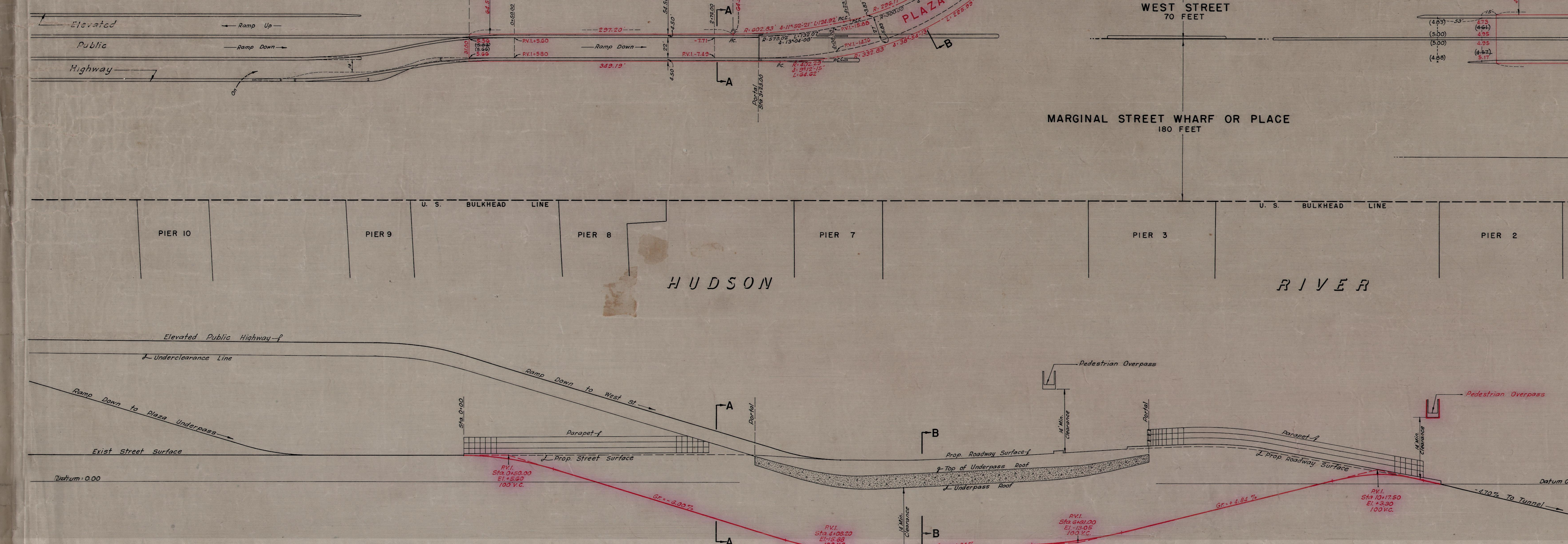

I, HILDA G. SCHWARTZ, SECRETARY OF THE BOARD OF ESTIMATE OF THE CITY OF NEW YORK DO HEREBY CERTIFY THAT THIS MAP IS ONE OF FOUR SIMILAR MAPS ADOPTED BY THE SAID BOARD OF ESTIMATE ON THE 25th DAY OF JULY 1946

DATED: NEW YORK OCTOBER 7, 1946

Hilda G. Schwartz
SECRETARY BOARD OF ESTIMATE

CITY OF NEW YORK
OFFICE OF THE PRESIDENT BOROUGH OF MANHATTAN
DEPARTMENT OF BOROUGH WORKS

MAP SHOWING A CHANGE IN THE CITY MAP BY LAYING OUT THE LINES AND GRADES FOR A STREET DESIGNATED AS

BATTERY PARK UNDERPASS
AND RAMPS THERETO
IN, UNDER AND THROUGH BATTERY PARK AND FOR A STREET DESIGNATED AS

PLAZA UNDERPASS
IN AND UNDER THE MANHATTAN APPROACHES TO BROOKLYN-BATTERY TUNNEL BY LAYING OUT THE LINES AND GRADES FOR A WIDENING OF

MORRIS STREET
ON ITS NORTHERLY SIDE
BETWEEN WEST STREET AND WASHINGTON STREET,
A NEW STREET
ON THE NORTHERLY SIDE OF THE MANHATTAN APPROACHES BETWEEN WEST STREET AND WASHINGTON STREET BY ELIMINATING OR CHANGING THE LINES OF

EDGAR STREET
BETWEEN GREENWICH STREET AND TRINITY PLACE,
WASHINGTON STREET
BETWEEN A NEW STREET AND MORRIS STREET AND

SOUTH STREET
WEST OF WHITEHALL STREET
TOGETHER WITH A CHANGE IN THE LINES OF
BATTERY PARK
BETWEEN STATE STREET AND SOUTH STREET.

DRAWN BY: Sanchez
CHECKED BY: G. Kauf
Joseph C. Collins
ENGINEER OF DESIGN

APPROVED FOR DEPARTMENT OF PARKS
COMMISSIONER OF PARKS

FOR DEPARTMENT OF MARINE & AVIATION
COMMISSIONER OF MARINE & AVIATION

DATED: JUNE 7, 1946

Hugo E. Hoyer
PRESIDENT BOROUGH OF MANHATTAN

Michael Klein
CHIEF ENGINEER

Richard F. Jones
CHIEF ENGINEER OF DESIGN

TUBE 52 B