

AVENUE  
TENTH

AVENUE  
NINTH

WEST 28<sup>TH</sup> STREET

WEST 27<sup>TH</sup> STREET

WEST 26<sup>TH</sup> STREET

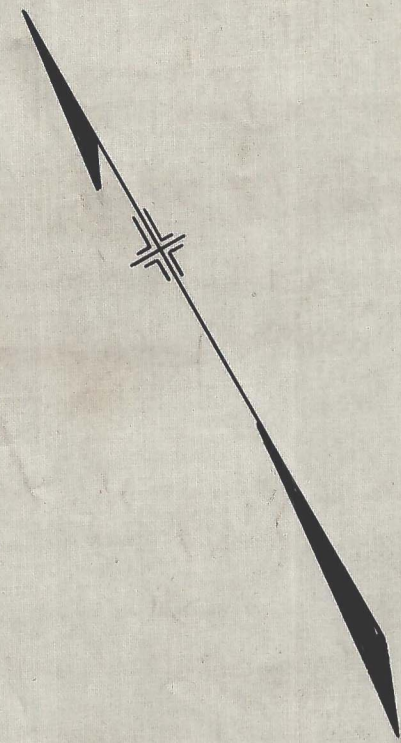
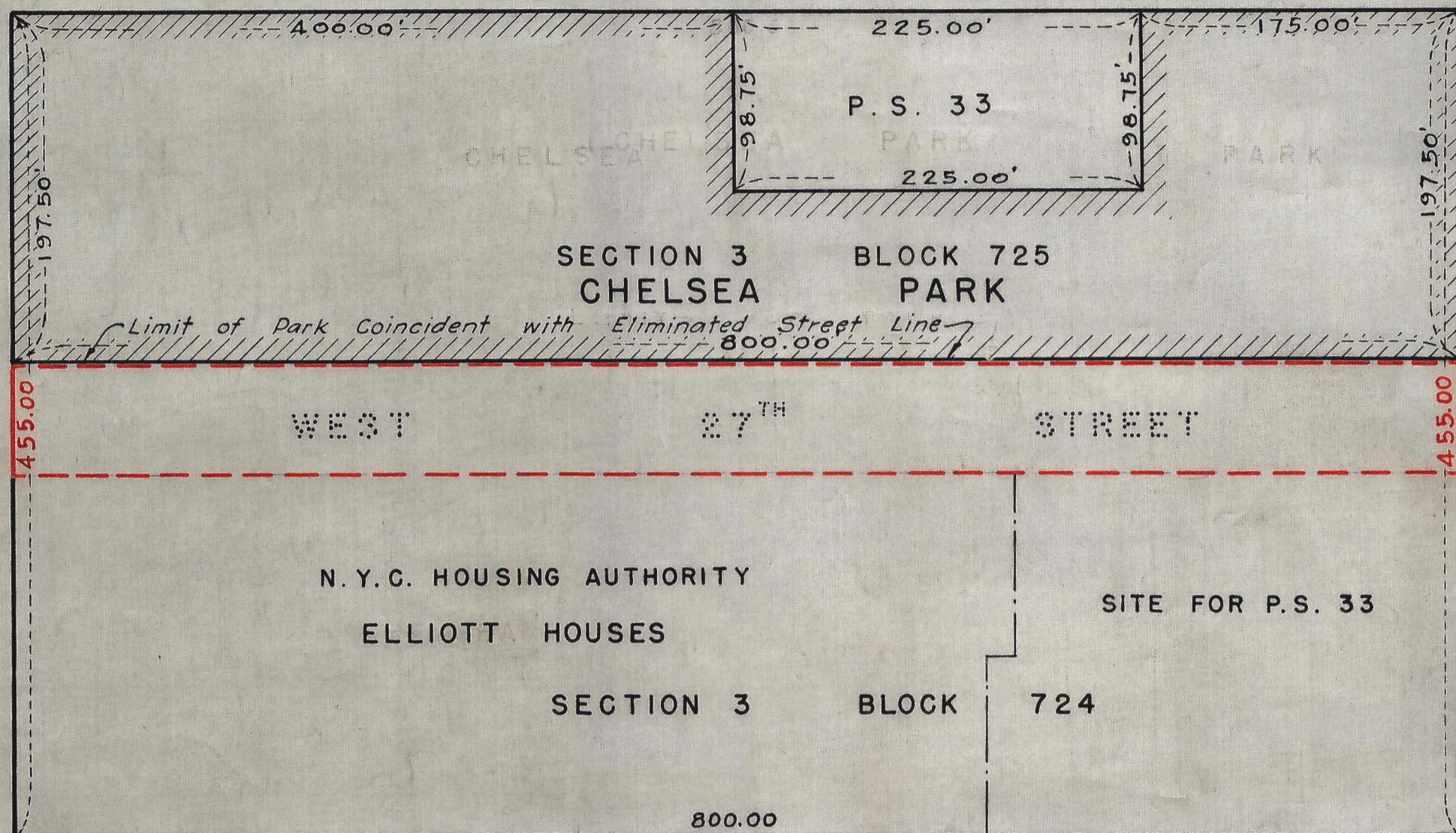

LEGEND

LINES AND DIMENSIONS OF STREETS PREVIOUSLY ESTABLISHED AND HEREBY RETAINED ARE SHOWN BY FULL BLACK LINES AND BLACK FIGURES.

LINES AND DIMENSIONS OF STREETS HEREBY ESTABLISHED ARE SHOWN BY FULL RED LINES AND RED FIGURES.

LINES OF STREETS PREVIOUSLY ESTABLISHED AND HEREBY DISCONTINUED ARE SHOWN BY DASHED RED LINES.

 PARK INDICATES PARK HERETOFORE ESTABLISHED.

I, HILDA G. SCHWARTZ SECRETARY OF THE BOARD OF ESTIMATE OF THE CITY OF NEW YORK DO HEREBY CERTIFY THAT THIS MAP IS ONE OF FOUR SIMILAR MAPS ADOPTED BY THE SAID BOARD OF ESTIMATE ON THE 28<sup>TH</sup> DAY OF MARCH 1946

DATED: NEW YORK April 24, 1946

*Hilda G. Schwartz*  
SECRETARY, BOARD OF ESTIMATE

CITY OF NEW YORK  
OFFICE OF THE PRESIDENT BOROUGH OF MANHATTAN  
DEPARTMENT OF BOROUGH WORKS  
MAP SHOWING  
A CHANGE IN THE STREET SYSTEM  
BY ELIMINATING THE LINES OF  
WEST 27<sup>TH</sup> STREET  
BETWEEN  
NINTH AVENUE AND TENTH AVENUE  
DATED: NOV. 27, 1945 SCALE 1" = 80'

*Seaman Williams Jr.*  
PRESIDENT, BOROUGH OF MANHATTAN

*Dean G. Edwards*  
CHIEF ENGINEER

*Charles W. Williams*  
COMMISSIONER OF BOROUGH WORKS

DRAWN BY *EMK*  
CHECKED BY *ES*

*William D. Holt*  
SECTION ENGINEER  
*J.C. Collyer*  
ENGINEER OF DESIGN

SECRETARY, BOARD OF ESTIMATE

B

ACC. No. 28696

Drawer 16