

ACC: 28602

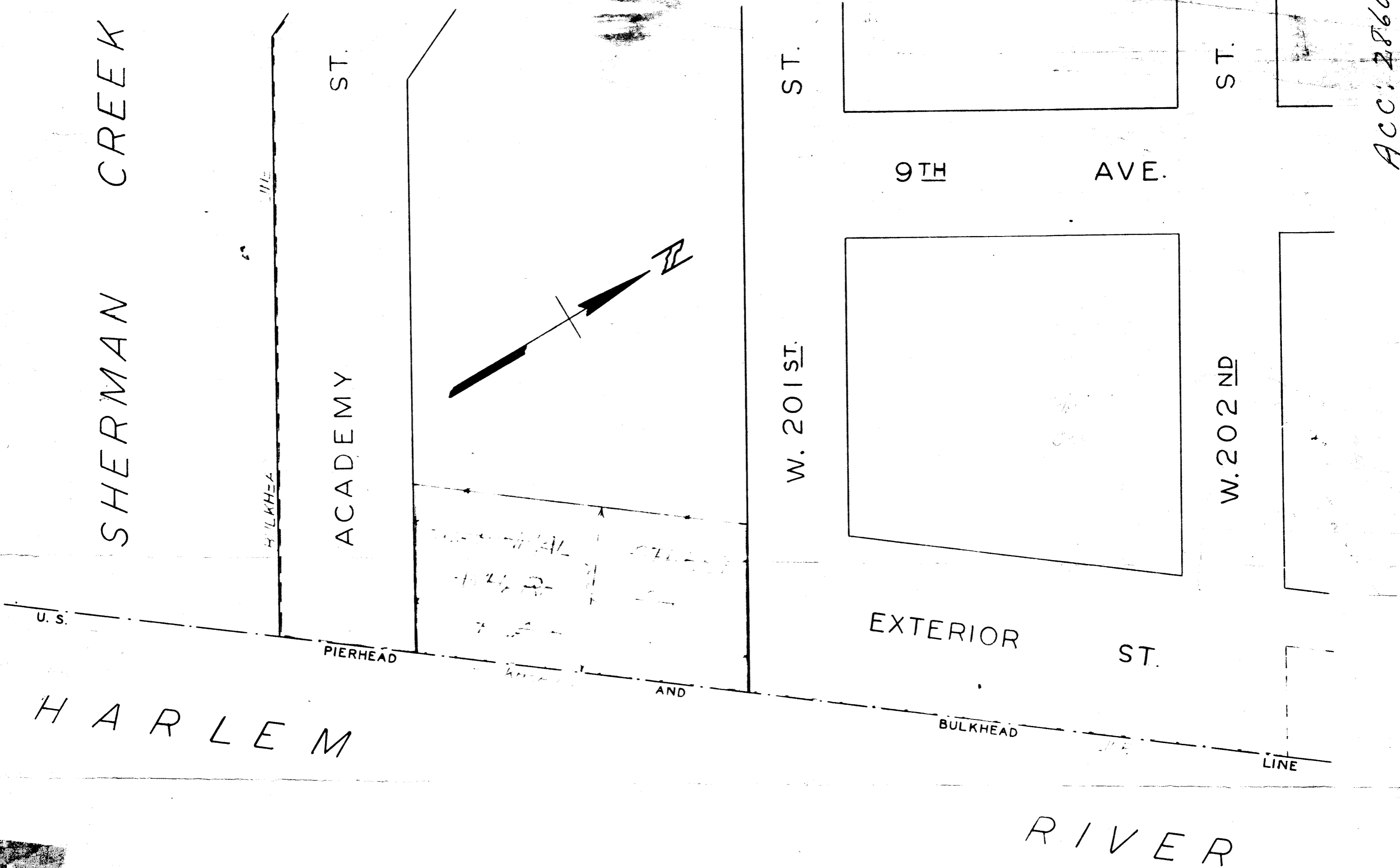

I, HILDA G. SCHWARTZ, SECRETARY OF THE BOARD OF ESTIMATE OF THE CITY OF NEW YORK DO HEREBY CERTIFY THAT THIS PLAN IS ONE OF FOUR SIMILAR PLANS DETERMINED UPON BY THE COMMISSIONER OF MARINE AND AVIATION AND APPROVED BY THE SAID BOARD OF ESTIMATE ON THE 19TH DAY OF FEB 1948 SUPERSEDING ALL PLANS HERETOFORE ADOPTED AND APPROVED AFFECTING THE AREA EMBRACED BY SAID PLAN, INSOFAR AS IT MAKES ANY CHANGES THEREIN.

SEE Acc No. 28601
B.P. 35X39

DATED: - MARCH 31, 1948

Hilda G. Schwartz
SECRETARY OF THE BOARD OF ESTIMATE

PLAN DETERMINED UPON BY THE COMMISSIONER OF MARINE AND AVIATION SHOWING A CHANGE IN THE PLAN FOR IMPROVING THE WATERFRONT AND HARBOR OF THE CITY OF NEW YORK HERETOFORE LAID OUT, BETWEEN ACADEMY STREET AND W. 201 STREET, HARLEM RIVER, BOROUGH OF MANHATTAN.

*Closing Harlem St
Wharf in Place
According to 201 St*

DATED Oct 16, 1945

COMMISSIONER OF MARINE AND AVIATION

ATTEST
Alfred J. ...
ACTING SECRETARY
DEPT. OF MARINE AND AVIATION

Alfred J. ...
ENGINEER IN CHARGE

NOTES: -
FORMER PLANS SHOWN IN GREEN
FORMER PLANS TO BE HEREBY ELIMINATED SHOWN IN RED

SCALE: 1" = 50'

(C)

2 sheets

No. 3586

Drawn 391

Acc. No. 28602