

MARGINAL STREET WHARF OR PLACE

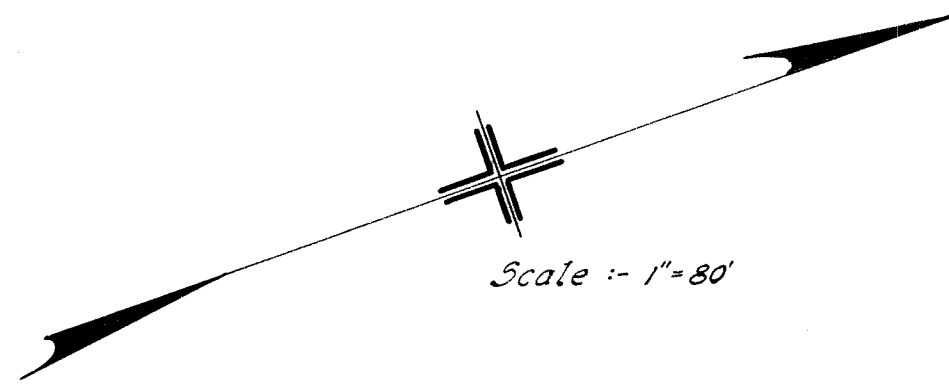
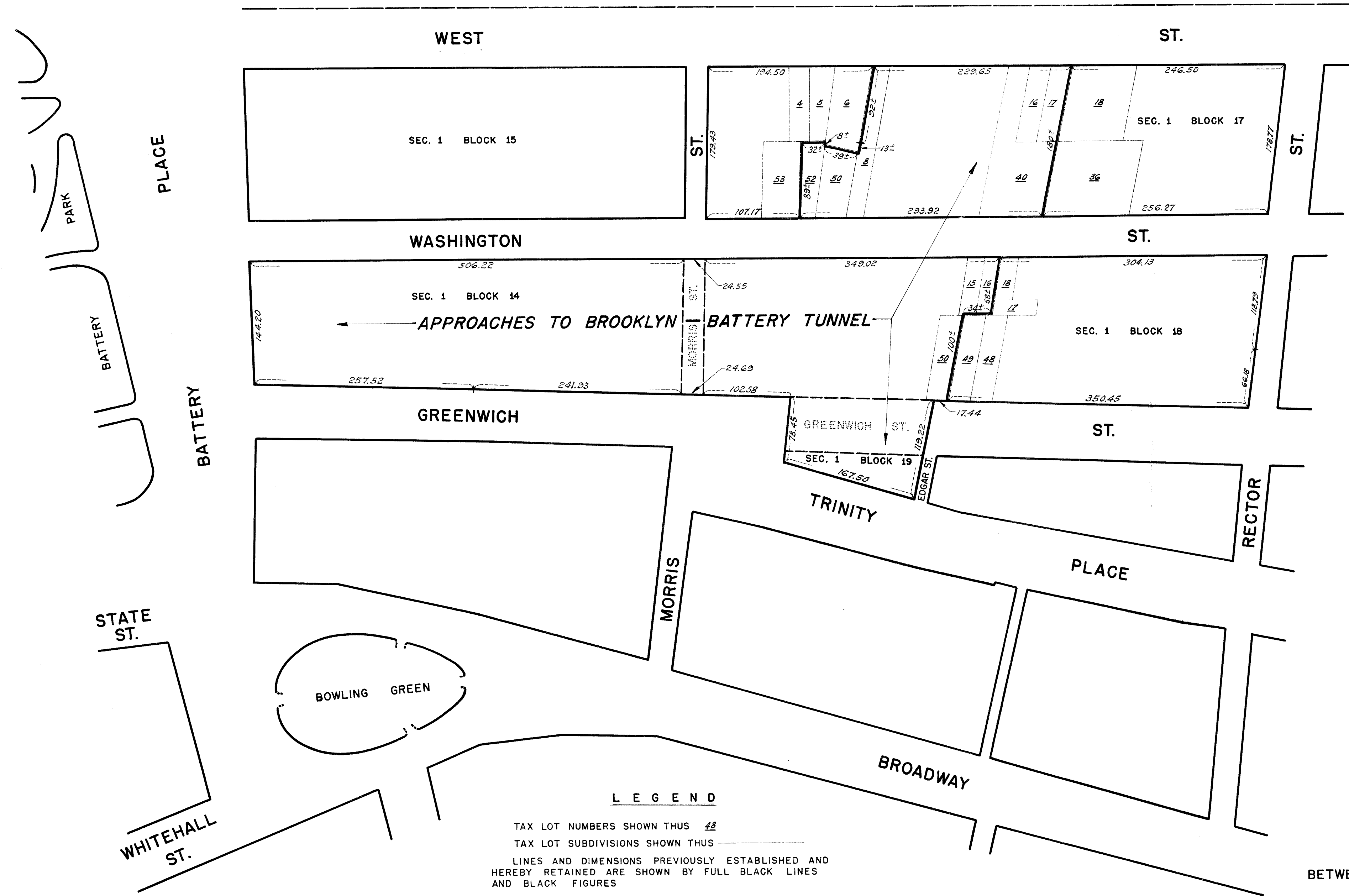

I, ANNA H. CLARK, SECRETARY OF THE BOARD OF ESTIMATE OF THE CITY OF NEW YORK DO HEREBY CERTIFY THAT THIS MAP IS ONE OF FOUR SIMILAR MAPS ADOPTED BY THE SAID BOARD OF ESTIMATE ON THE 31<sup>st</sup> DAY OF APRIL, 1941  
 DATED: NEW YORK JANUARY 26, 1942

*Anna H. Clark*  
 SECRETARY BOARD OF ESTIMATE

*This map amended or superseded by Map Acc. 25747*

CITY OF NEW YORK  
 OFFICE OF THE PRESIDENT BOROUGHS OF MANHATTAN  
 DEPARTMENT OF BOROUGHS WORKS  
 PLAN SHOWING A CHANGE IN THE CITY MAP BY LAYING OUT  
**MANHATTAN APPROACHES TO THE BROOKLYN-BATTERY TUNNEL**  
 BY ELIMINATING THE LINES OF GREENWICH STREET BETWEEN EDGAR STREET AND A POINT ABOUT 169 FEET SOUTHERLY THEREFROM AND OF MORRIS STREET BETWEEN WASHINGTON STREET AND GREENWICH STREET

DATED: SEPT. 30, 1940

*Wm. L. Barry*  
 PRESIDENT BOROUGHS OF MANHATTAN  
*J. J. Hammond*  
 CHIEF ENGINEER  
*W. D. Binns*  
 COMMISSIONER OF BOROUGHS WORKS

**LEGEND**

TAX LOT NUMBERS SHOWN THUS *48*  
 TAX LOT SUBDIVISIONS SHOWN THUS *---*  
 LINES AND DIMENSIONS PREVIOUSLY ESTABLISHED AND HEREBY RETAINED ARE SHOWN BY FULL BLACK LINES AND BLACK FIGURES  
 DIMENSIONS HEREBY ESTABLISHED ARE SHOWN BY RED FIGURES  
 LIMITS OF MANHATTAN APPROACHES TO BROOKLYN-BATTERY TUNNEL ARE SHOWN BY FULL RED LINES  
 LINES HEREBY DISCONTINUED ARE SHOWN BY DASHED RED LINES

DRAWN BY: J.V.S.  
 CHECKED BY: M.G.  
*W. J. Collins*  
 SECTION ENGINEER  
*J. C. Collins*  
 ENGINEER OF DESIGN

*Drawer 15*

*Filed in the Office of the Borough Engineer of Manhattan 4/9/42*  
 FILE NO. 57.2 ACC. NO. 2820