

AVE.

SECOND

GRAN 1921

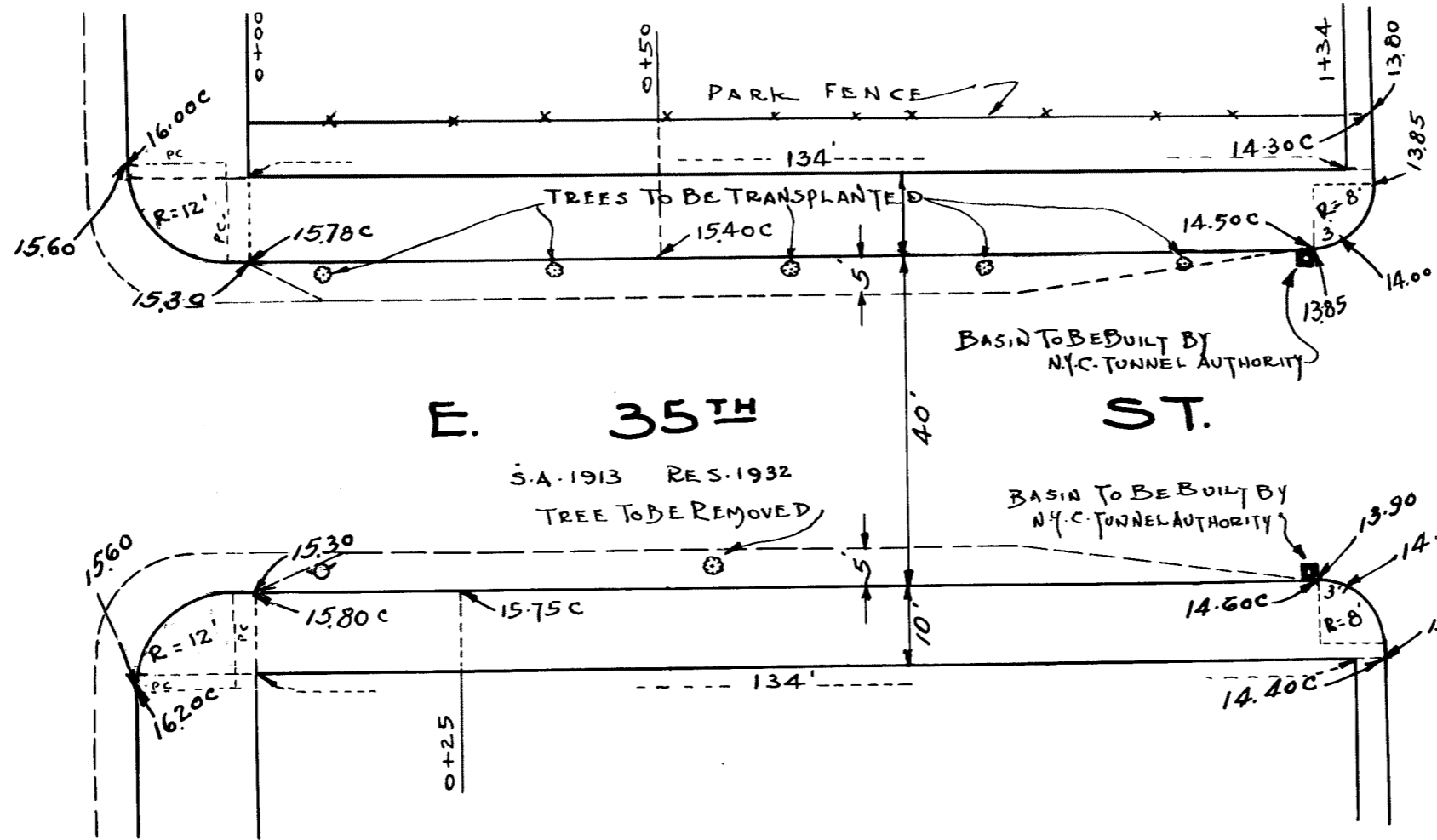

ENTRANCE
MIDTOWN
TUNNEL.

SOUTH
QUEENS

NOTES

PROPOSED CURB ELEVATION - SHOWN THUS... 14.5c
 PROPOSED GUTTER ELEVATION - SHOWN THUS... 13.50
 TREES SHOWN THUS... ⊙
 ELEVATIONS SHOWN ON THIS PLAN ARE REFERRED TO BOROUGH WORKS DATUM OF THE BOROUGH OF MANHATTAN WHICH IS 2.75 FEET ABOVE MEAN SEA LEVEL AT SANDY HOOK

Louis S. Furtwell
SECTION ENGINEER

DRAWN BY... H.E. LICHTMAN
CHECKED BY.....

CITY OF NEW YORK BOROUGH OF MANHATTAN
OFFICE OF THE PRESIDENT
DEPARTMENT OF BOROUGH WORKS

PLAN

SHOWING THE WIDENING OF
E. 35TH FROM 2ND AVE. EASTERLY
TO THE SOUTH ENTRANCE OF
THE QUEEN'S MIDTOWN TUNNEL

DATED - MAY 27, 1940
H. E. Lichtman
PRIN. ASST ENGINEER

J. H. ...
CHIEF ENGINEER

FILE No. 3-3

Acc. No. 27,993

Drawn 14