

NOTE:-

THE PROPERTY TO BE ACQUIRED FOR PARK PURPOSES IS THAT OUTLINED IN BLUE UPON THIS MAP, EXCEPTING THE LANDS WITHIN SAID BOUNDARY OWNED BY THE CITY OF NEW YORK AND ACQUIRED FOR ANY PURPOSE WHATSOEVER.

DEPARTMENT OF PARKS
CITY OF NEW YORK
PLAN SHOWING SITE PROPOSED
FOR
PUBLIC PARK
LOCATED AT
EAST 103RD ST. WEST OF EAST RIVER DRIVE
IN THE
BOROUGH OF MANHATTAN
CITY OF NEW YORK

THE AMOUNT OF VALUATION AT WHICH EACH PARCEL OF THE REAL PROPERTY ACQUIRED HAS BEEN ASSESSED FOR PURPOSES OF TAXATION ON CITY TAX ROLLS FOR EACH OF THE THREE YEARS PRECEDING THE DATE OF SUCH SELECTIONS IS AS FOLLOWS:

		ASSESSED VALUATION OF PROPERTY					
BLOCK No.	LOT No.	1935		1936		1937	
		UNIMPROVED	IMPROVED	UNIMPROVED	IMPROVED	UNIMPROVED	IMPROVED
1697	17	5,000	5,000	5,000	5,000	5,000	5,000
do.	18	5,000	5,000	5,000	5,000	5,000	5,000
do.	19	5,000	5,000	5,000	5,000	5,000	5,000
do.	20	5,000	5,000	5,000	5,000	5,000	5,000
do.	21	9,000	9,000	9,000	9,000	9,000	9,000
do.	22	4,500	4,500	4,500	4,500	4,500	4,500
do.	23	3,000	3,500	3,000	3,500	3,500	3,500
do.	24	3,000	3,000	3,000	3,000	3,000	3,000
do.	121	10,000	10,000	10,000	10,000	10,000	10,000
TOTAL		49,500	50,000	49,500	50,000	50,000	50,000

DATE JAN. 10, 1938

[Signature]
COMMISSIONER OF PARKS OF THE
CITY OF NEW YORK

RECORDED
INDEXED
AT EXETER ST. WEST OF EAST RIVER DRIVE
BOROUGH OF MANHATTAN

SCALE 1" = 30'

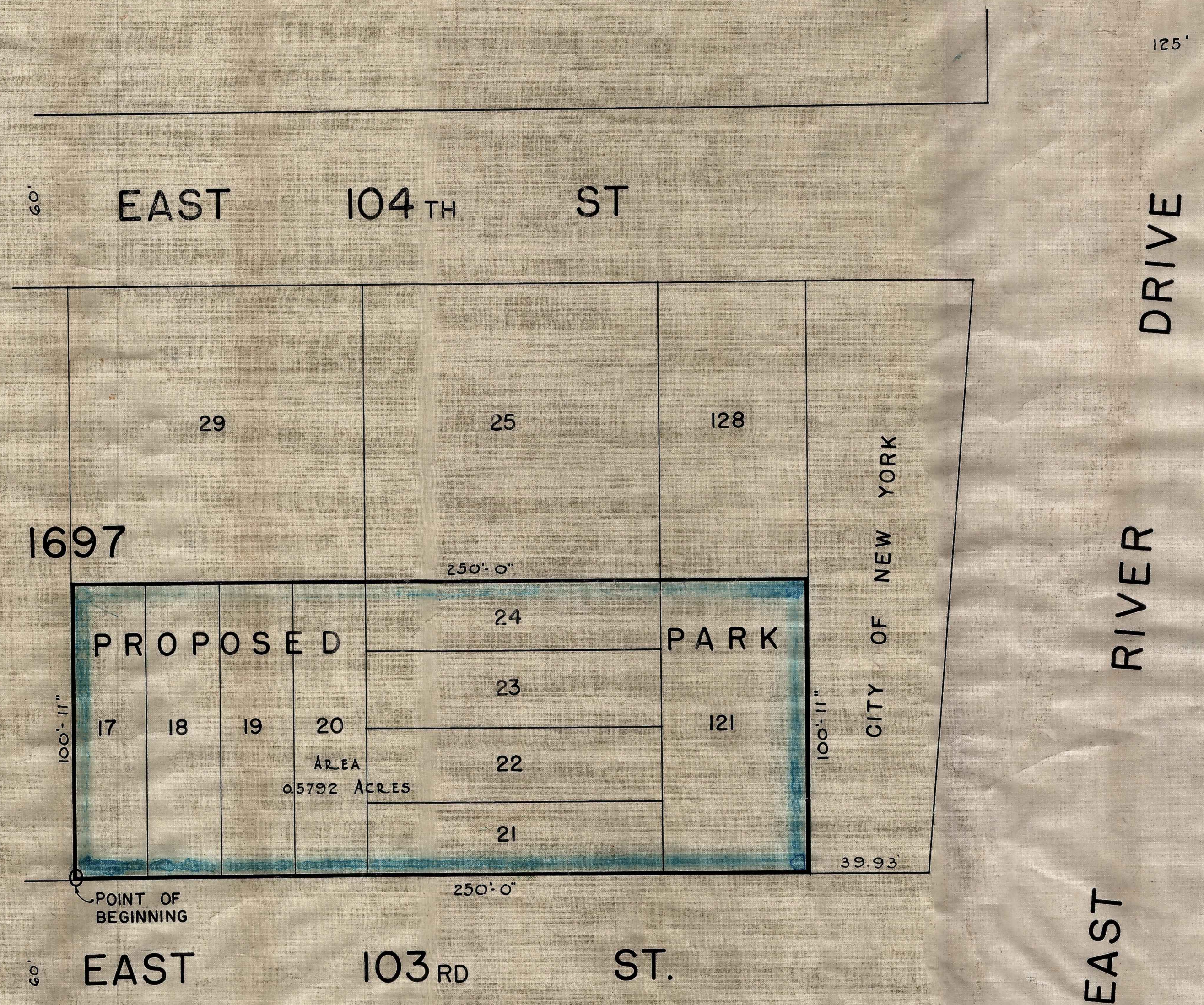

I, FRANCES LEHRICH, SECRETARY OF THE BOARD OF ESTIMATE OF THE CITY OF NEW YORK, DO HEREBY CERTIFY THAT THIS MAP IS ONE OF FOUR SIMILAR MAPS MADE AT THE DIRECTION OF AND ADOPTED BY THE SAID BOARD OF ESTIMATE ON THE 16th DAY OF JUNE, 1938. ENTITLED: "PLAN SHOWING SITE FOR PUBLIC PARK LOCATED AT EAST 103RD ST. WEST OF EAST RIVER DRIVE IN THE BOROUGH OF MANHATTAN, CITY OF NEW YORK" SUPERSEDING ALL MAPS HERETOFORE FILED AFFECTING THE AREA EMBRACED BY SAID MAP, IN SO FAR AS IT MAKES ANY CHANGES THEREIN. PREPARED FOR THE BOARD OF ESTIMATE UNDER AUTHORITY OF THE CHARTER OF THE CITY OF NEW YORK

DATED: NEW YORK FEBRUARY 12, 1940

Frances Lehigh
SECRETARY, BOARD OF ESTIMATE
at a.

FILE No. 10-2

ACC. No. 27952

Drawn 28

[Handwritten notes]