

Scale: 1"=50'

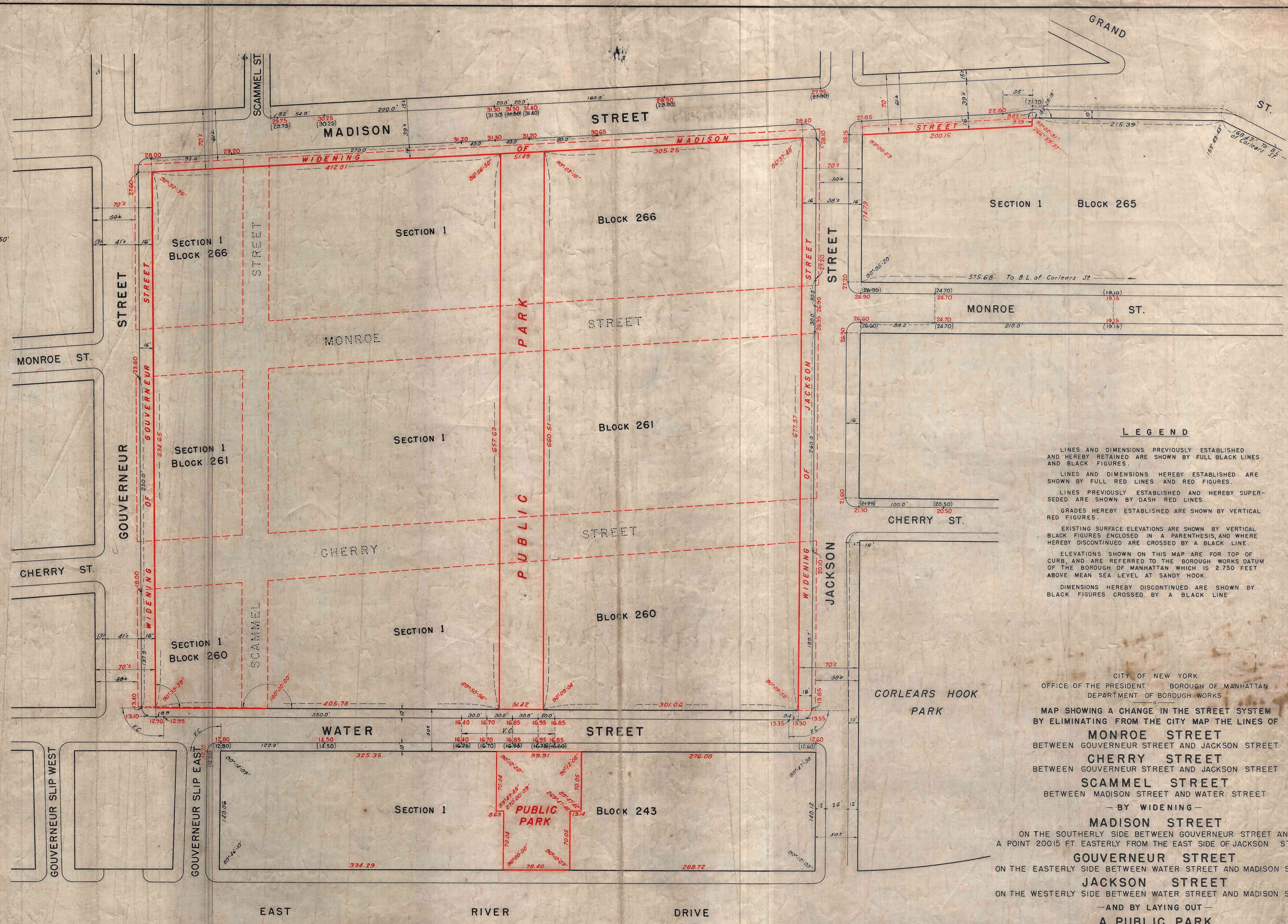

LEGEND

Lines and dimensions previously established and hereby retained are shown by full black lines and black figures.

Lines and dimensions hereby established are shown by full red lines and red figures.

Lines previously established and hereby super-seeded are shown by dash red lines.

Grades hereby established are shown by vertical red figures.

Existing surface elevations are shown by vertical black figures enclosed in a parenthesis, and where hereby discontinued are crossed by a black line.

Elevations shown on this map are for top of curb, and are referred to the borough works datum of the borough of Manhattan which is 2.750 feet above mean sea level at Sandy Hook.

Dimensions hereby discontinued are shown by black figures crossed by a black line.

CITY OF NEW YORK
OFFICE OF THE PRESIDENT BOROUGH OF MANHATTAN
DEPARTMENT OF BOROUGH WORKS

MAP SHOWING A CHANGE IN THE STREET SYSTEM
BY ELIMINATING FROM THE CITY MAP THE LINES OF
MONROE STREET
BETWEEN GOUVERNEUR STREET AND JACKSON STREET
CHERRY STREET
BETWEEN GOUVERNEUR STREET AND JACKSON STREET
SCAMMEL STREET
BETWEEN MADISON STREET AND WATER STREET
— BY WIDENING —
MADISON STREET
ON THE SOUTHERLY SIDE BETWEEN GOUVERNEUR STREET AND
A POINT 200.15 FT. EASTERLY FROM THE EAST SIDE OF JACKSON STREET
GOUVERNEUR STREET
ON THE EASTERLY SIDE BETWEEN WATER STREET AND MADISON STREET
JACKSON STREET
ON THE WESTERLY SIDE BETWEEN WATER STREET AND MADISON STREET
— AND BY LAYING OUT —
A PUBLIC PARK
WITHIN THE AREA BOUNDED BY GOUVERNEUR STREET,
MADISON STREET, JACKSON STREET AND EAST RIVER DRIVE
TOGETHER WITH ESTABLISHING GRADES IN THE AREA AFFECTED

DATED: APRIL 10, 1939

Stanley H. Lewis
PRESIDENT, BOROUGH OF MANHATTAN

J. P. Hammond
CHIEF ENGINEER

Harry O. Binger
COMMISSIONER OF BOROUGH WORKS

DRAWN BY: Sanchez
CHECKED BY: M. GOLDBERG

Montgomery
SECTION ENGINEER
Seaborn
ENGINEER OF DESIGN

I, FRANCES LEHRICH, SECRETARY OF THE
BOARD OF ESTIMATE OF THE CITY OF NEW YORK
DO HEREBY CERTIFY THAT THIS MAP IS ONE OF
FOUR SIMILAR MAPS ADOPTED BY THE SAID BOARD
OF ESTIMATE ON THE 14TH DAY OF Dec., 1939

DATED: NEW YORK, N.Y., APRIL 10, 1939

Frances Lehigh
SECRETARY, BOARD OF ESTIMATE