

ARCH OVER CANAL STREET

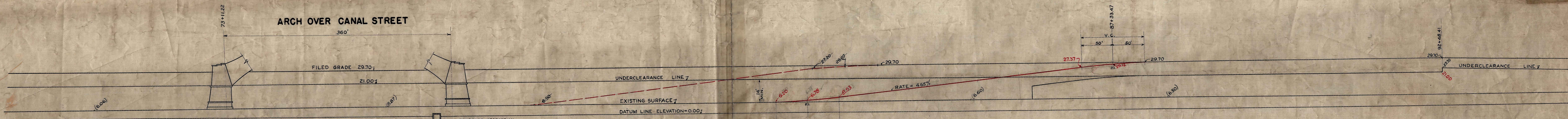

PROFILE
SCALE: VERTICAL 1"=20'
SCALE: HORIZONTAL 1"=50'

MARGINAL STREET

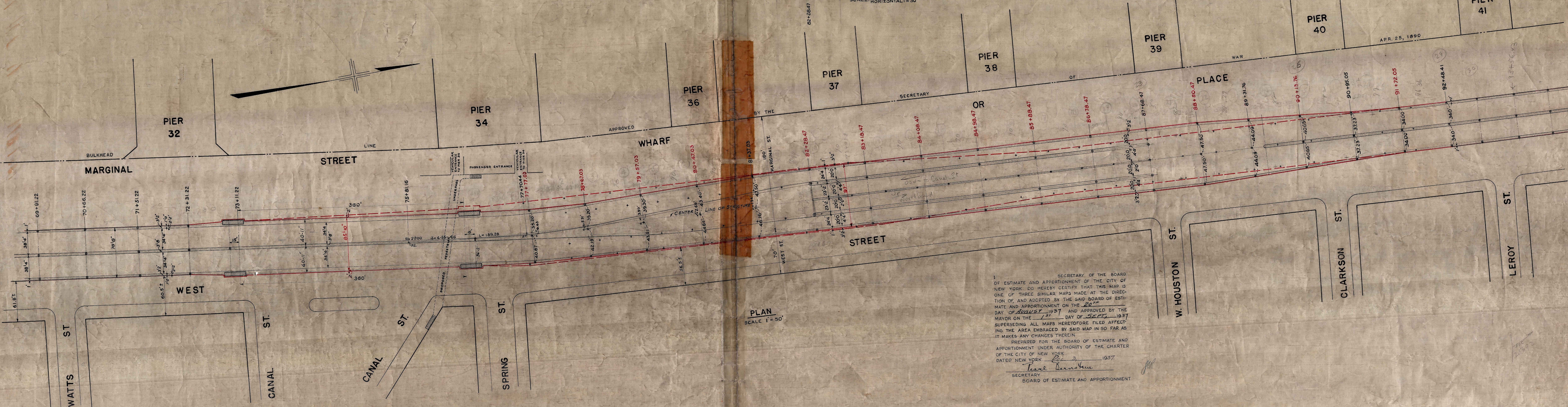

PLAN
SCALE 1"=50'

I, SECRETARY OF THE BOARD OF ESTIMATE AND APPORTIONMENT OF THE CITY OF NEW YORK, DO HEREBY CERTIFY THAT THIS MAP IS ONE OF THREE SIMILAR MAPS MADE AT THE DIRECTION OF AND ADOPTED BY THE SAID BOARD OF ESTIMATE AND APPORTIONMENT ON THE 20th DAY OF August 1937 AND APPROVED BY THE MAYOR ON THE 17th DAY OF September 1937 SUPERSEDING ALL MAPS HERETOFORE FILED AFFECTING THE AREA EMBRACED BY SAID MAP IN SO FAR AS IT MAKES ANY CHANGES THEREIN.
PREPARED FOR THE BOARD OF ESTIMATE AND APPORTIONMENT UNDER AUTHORITY OF THE CHARTER OF THE CITY OF NEW YORK, 1937.
DATED NEW YORK, April 27 1937.
Frank Bennett
SECRETARY
BOARD OF ESTIMATE AND APPORTIONMENT

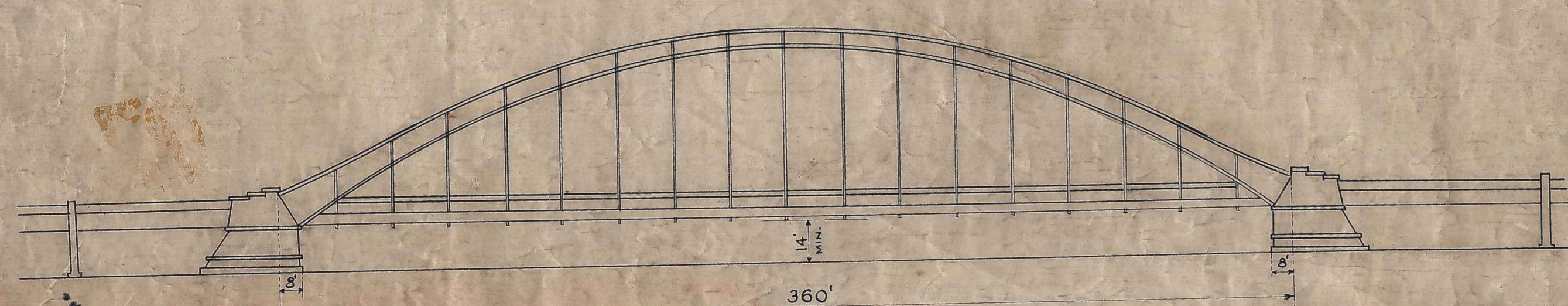

ELEVATION OF ARCH OVER CANAL STREET
SCALE: 1"=40'-0"

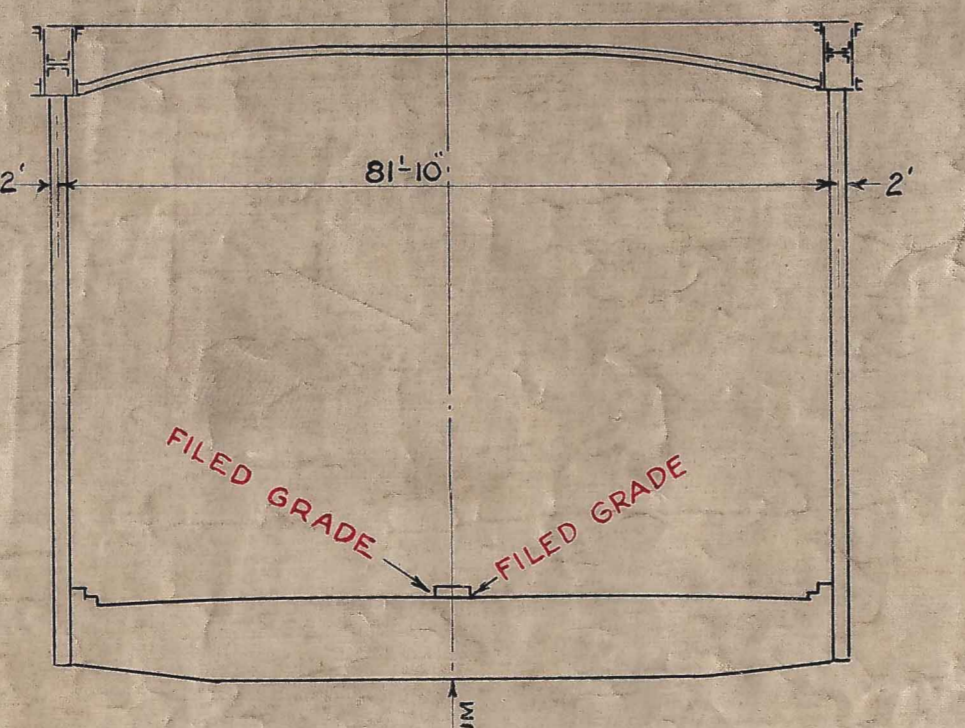

CROSS SECTION THROUGH CENTER OF ARCH OVER CANAL STREET
SCALE: 1"=20'-0"

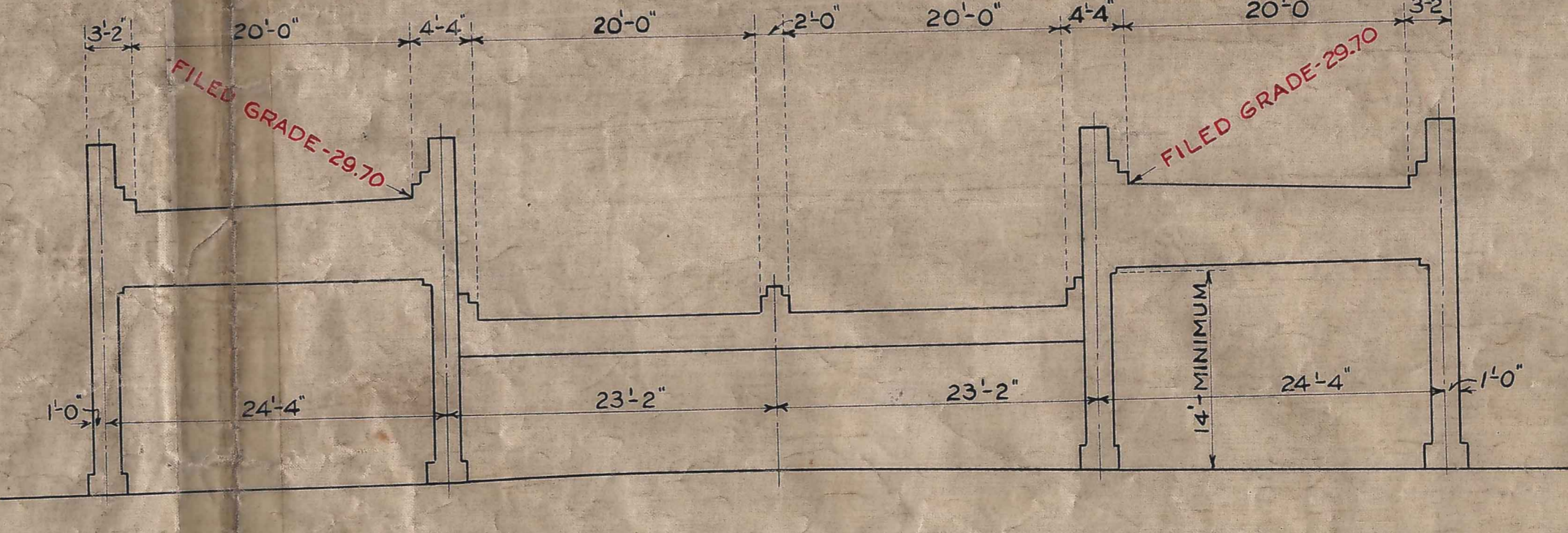

TYPICAL SECTION OF RAMP (STA. 82+28.47 TO 87+68.47) LOOKING NORTH
SCALE: 1"=10'-0"

LEGEND

LINES HEREBY DISCONTINUED ARC SHOWN BY DASH RED LINES
COLUMNS HEREBY ESTABLISHED ARE SHOWN BY A BLACK CROSS THUS +
COLUMNS HEREBY DISCONTINUED ARE SHOWN BY A BLACK CROSS THUS -
LINES AND DIMENSIONS HEREBY ESTABLISHED ARE SHOWN BY FULL RED LINES AND RED FIGURES.
LINES AND DIMENSIONS PREVIOUSLY ESTABLISHED AND HEREBY RETAINED ARE SHOWN BY FULL BLACK LINES AND BLACK FIGURES.
GRADES HEREBY ESTABLISHED ARE SHOWN BY VERTICAL RED FIGURES.
GRADES PREVIOUSLY ESTABLISHED AND HEREBY ABOLISHED ARE SHOWN BY VERTICAL BLACK FIGURES CROSSED BY A BLACK LINE.
GRADES PREVIOUSLY ESTABLISHED AND HEREBY RETAINED ARE SHOWN BY VERTICAL BLACK FIGURES.
EXISTING SURFACE ELEVATIONS ARE SHOWN BY VERTICAL BLACK FIGURES ENCLOSED IN A PARENTHESIS.
ELEVATIONS SHOWN ON THIS MAP ARE REFERRED TO THE PUBLIC WORKS DATUM OF THE BOROUGH OF MANHATTAN WHICH IS 2.75 FEET ABOVE MEAN SEA LEVEL AT SANDY HOOK
STATIONING ALONG THE CENTER LINE OF STRUCTURE.

CITY OF NEW YORK BOROUGH OF MANHATTAN
OFFICE OF THE PRESIDENT
DEPARTMENT OF PUBLIC WORKS
BUREAU OF SEWERS AND HIGHWAYS
AMENDED MAP OR PLAN
OF THE
ELEVATED PUBLIC HIGHWAY
ALONG THE WATER FRONT OF THE HUDSON RIVER
REVISING THE LINES, GRADES, AND COLUMN LOCATIONS
BETWEEN
WATTS STREET AND LEROY STREET
PURSUANT TO CHAPTER 484 OF THE LAWS OF 1926
AND CHAPTER 880 OF THE LAWS OF 1934
DATED APRIL 27, 1937 SCALE AS SHOWN

DRAWN BY: M.M.
CHECKED BY: M. GOLDBERG
W. H. Harrison
SECTION ENGINEER, CITY PLAN
W. H. Harrison
SECTION ENGINEER, STRUCTURES
W. H. Harrison
ENGINEER OF CONSTRUCTION
J. C. Collins
ENGINEER OF DESIGN

W. H. Harrison
CHIEF ENGINEER
W. H. Harrison
PRESIDENT, BOARD OF MANHATTAN
FILE NO. 42-2 ACC. NO. 27648