

E. 23RD ST.

LEXINGTON AVE.

BLOCK 878
SECTION 3

COLLEGE OF THE CITY OF NEW YORK
18 STORY BRICK & STONE

COLLEGE OF THE CITY OF NEW YORK
1 STORY STONE EXTENSION

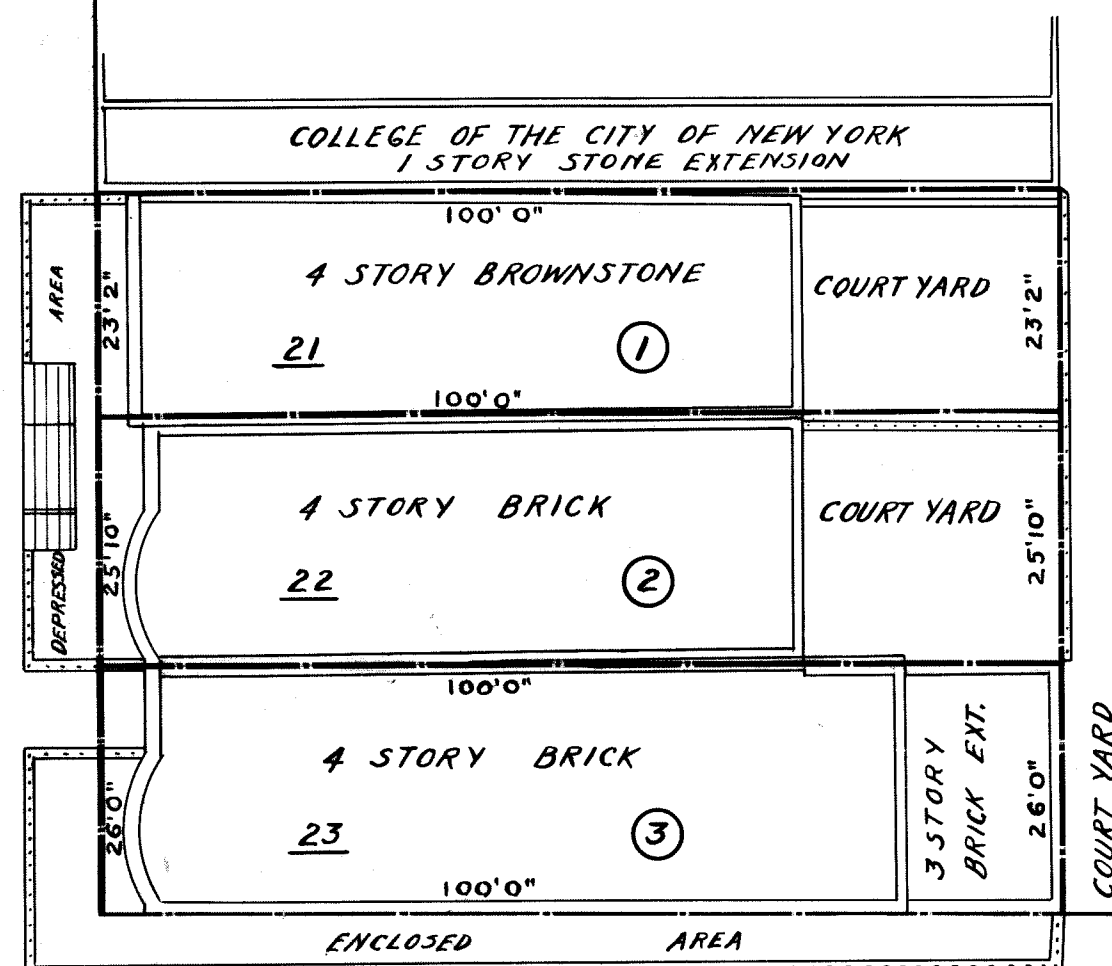

CHILDREN'S COURT
4 STORY LIMESTONE & GRANITE

E. 22ND ST.

PARCEL NO.	BLOCK NO.	LOT NO.	AREASQ.FT.	ASSESSED VALUATIONS						OWNER	REMARKS
				1935		1936		1937			
				LAND	IMPROVEMENT	LAND	IMPROVEMENT	LAND	IMPROVEMENT		
1	878	21	2316.7	41,000	12,000	41,000	12,000	41,000	12,000		
2	"	22	2583.3	44,000	6,000	44,000	6,000	44,000	6,000		
3	"	23	2600.0	69,500	13,000	69,500	13,000	69,500	13,000		

LEGEND

LOT LINES SHOWN THUS ———
 LOT NUMBERS SHOWN THUS ①
 PARCEL NUMBERS SHOWN THUS ②

CITY OF NEW YORK BOROUGH OF MANHATTAN
 OFFICE OF THE PRESIDENT
 DEPARTMENT OF PUBLIC WORKS
 BUREAU OF SEWERS AND HIGHWAYS

DAMAGE MAP

IN THE MATTER OF ACQUIRING TITLE TO THE PROPERTY REQUIRED FOR A
 COURT HOUSE FOR THE FAMILY COURT DIVISION OF
 THE DOMESTIC RELATIONS COURT

ON THE
 NORTH EAST CORNER OF LEXINGTON AVENUE AND E. 22ND ST.
 IN THE BOROUGH OF MANHATTAN
 CITY OF NEW YORK

JUSTICE OF THE SUPREME COURT

DATED: OCT. 19, 1937

SCALE: 1"=20'0"

W. C. ...
 CHIEF ENGINEER

Samuel ...
 PRESIDENT, BOROUGH OF MANHATTAN

FILE 2.2

Acc. 27626

8

13