

I, PETER J. MCGOWAN, SECRETARY OF THE BOARD OF ESTIMATE AND APPORTIONMENT OF THE CITY OF NEW YORK, DO HEREBY CERTIFY THAT THIS MAP IS ONE OF THREE SIMILAR MAPS MADE AT THE DIRECTION OF, AND ADOPTED, BY THE SAID BOARD OF ESTIMATE AND APPORTIONMENT ON THE 7TH DAY OF MARCH 1929, AND APPROVED BY THE MAYOR ON THE 18TH DAY OF APRIL 1929 SUPERSEDING ALL MAPS HERETOFORE FILED AFFECTING THE AREA EMBRACED BY SAID MAP IN SO FAR AS IT MAKES ANY CHANGES THEREIN.

PREPARED FOR THE BOARD OF ESTIMATE AND APPORTIONMENT UNDER AUTHORITY OF THE CHARTER OF THE CITY OF NEW YORK.
DATED, NEW YORK Aug. 13 1929

Peter J. McGowan
SECRETARY,
BOARD OF ESTIMATE AND APPORTIONMENT.

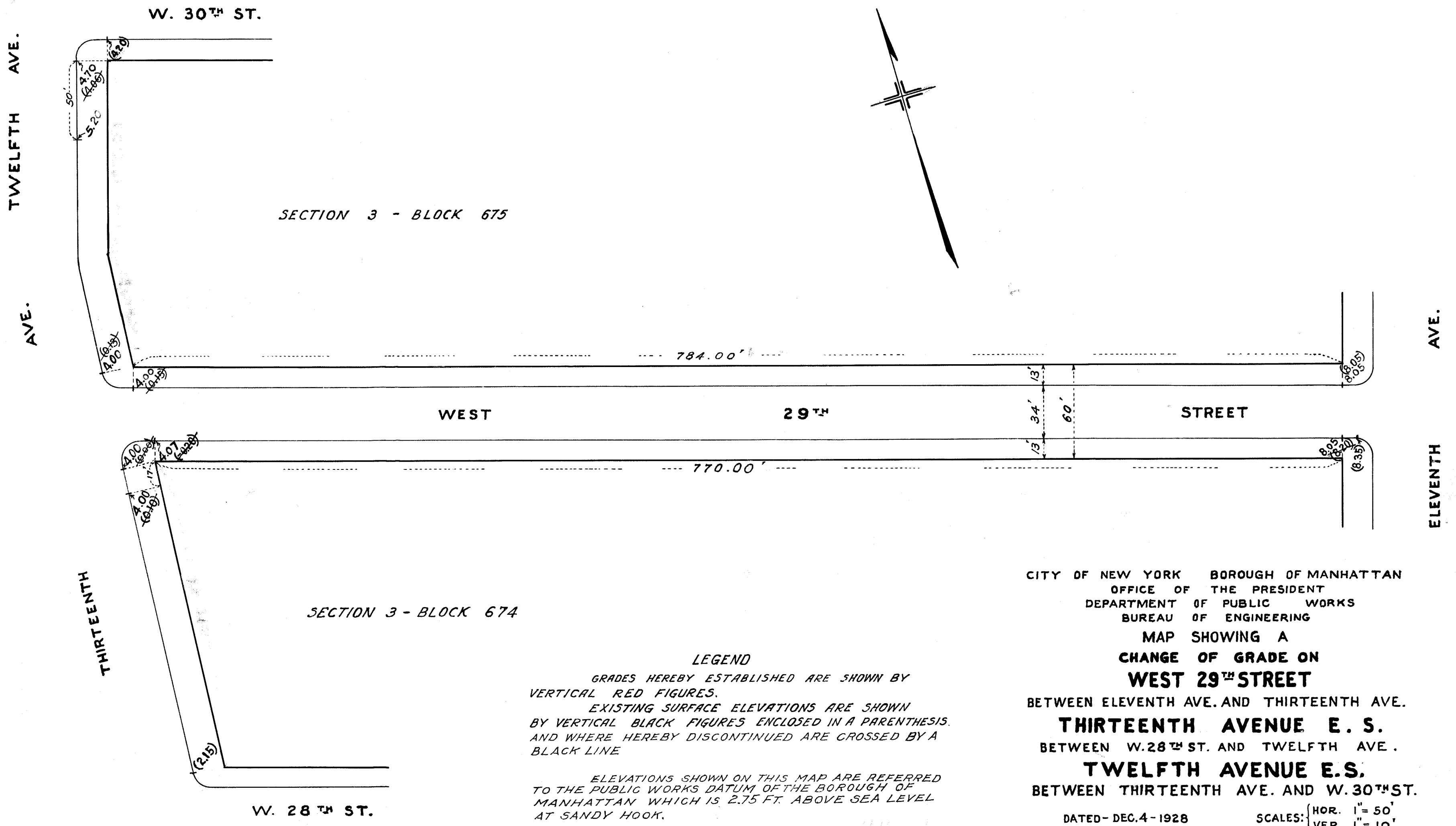
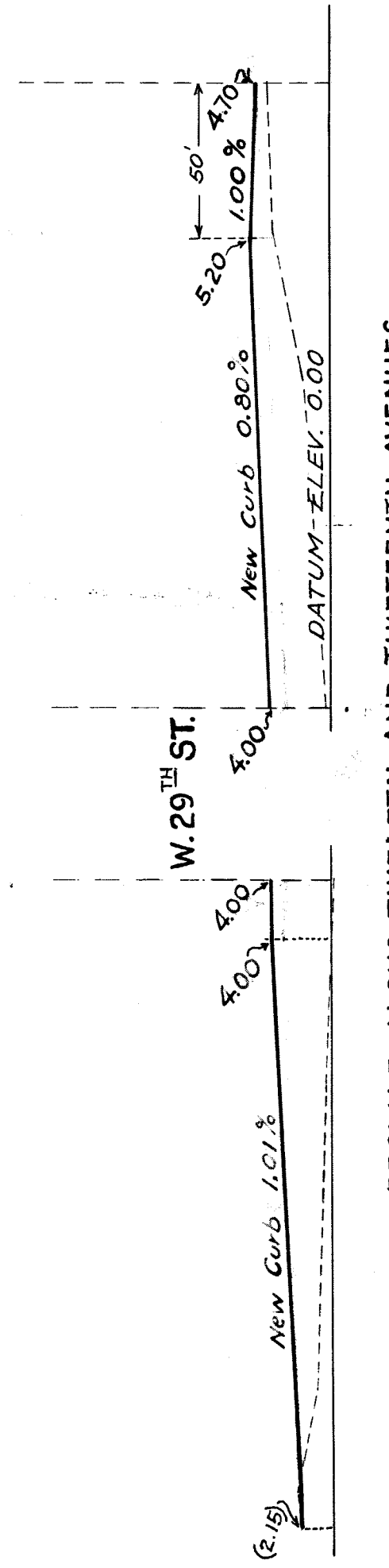
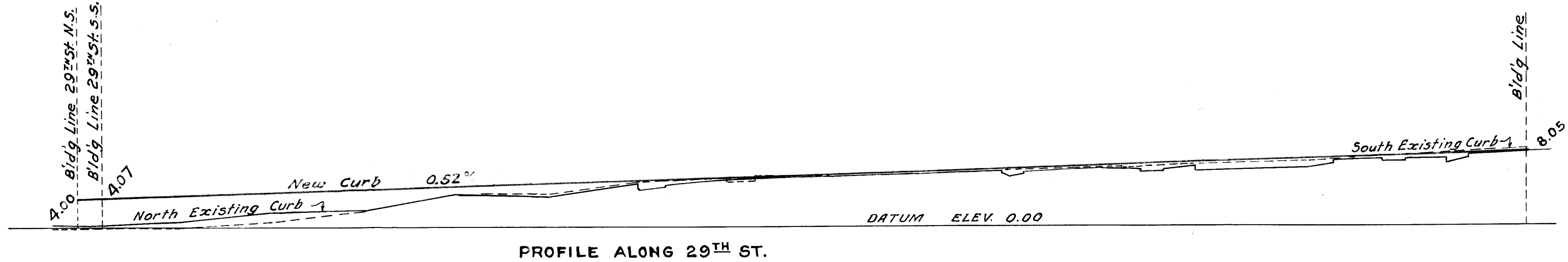

LEGEND
GRADES HEREBY ESTABLISHED ARE SHOWN BY VERTICAL RED FIGURES.
EXISTING SURFACE ELEVATIONS ARE SHOWN BY VERTICAL BLACK FIGURES ENCLOSED IN A PARENTHESIS, AND WHERE HEREBY DISCONTINUED ARE CROSSED BY A BLACK LINE.
ELEVATIONS SHOWN ON THIS MAP ARE REFERRED TO THE PUBLIC WORKS DATUM OF THE BOROUGH OF MANHATTAN WHICH IS 2.75 FT. ABOVE SEA LEVEL AT SANDY HOOK.

CITY OF NEW YORK BOROUGH OF MANHATTAN
OFFICE OF THE PRESIDENT
DEPARTMENT OF PUBLIC WORKS
BUREAU OF ENGINEERING
MAP SHOWING A
**CHANGE OF GRADE ON
WEST 29TH STREET**
BETWEEN ELEVENTH AVE. AND THIRTEENTH AVE.
THIRTEENTH AVENUE E. S.
BETWEEN W. 28TH ST. AND TWELFTH AVE.
TWELFTH AVENUE E. S.
BETWEEN THIRTEENTH AVE. AND W. 30TH ST.
DATED - DEC. 4 - 1928 SCALES: { HOR. 1" = 50'
VER. 1" = 10'

DRAWN BY: BALFOUR
CHECKED BY: MOFFATT

A. J. Reed
SECTION ENGINEER

J. C. Collyer
ENGINEER IN CHARGE, DIVISION OF DESIGN.

Charles E. ...
CHIEF ENGINEER
J. ...
PRES. BORO. OF MANHATTAN

FILE NO 2-2 ACC. NO 26204

Drawer 11