

NEW YORK CITY
BUREAU OF TOPOGRAPHY
6681

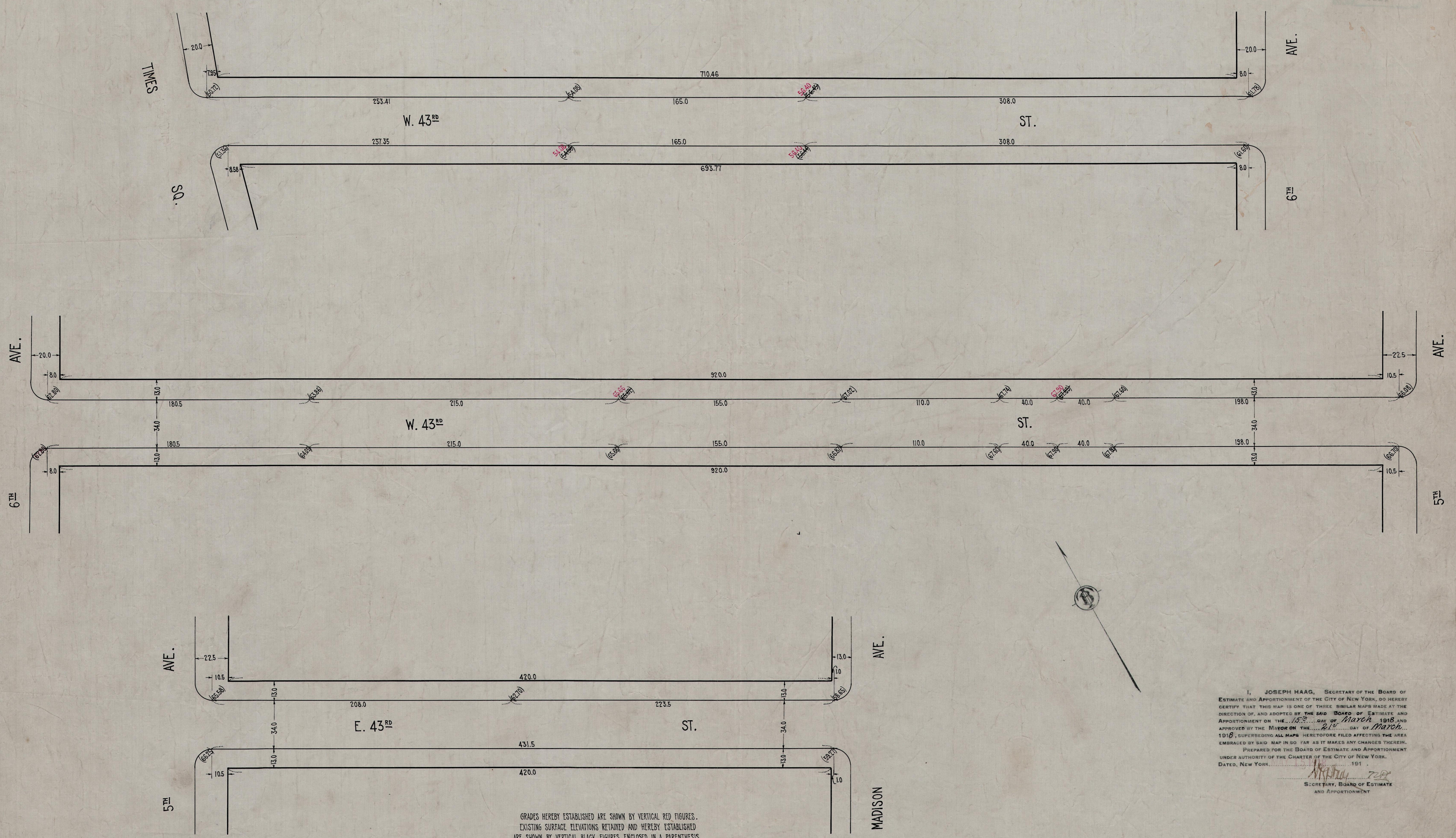

GRADES HEREBY ESTABLISHED ARE SHOWN BY VERTICAL RED FIGURES.
 EXISTING SURFACE ELEVATIONS RETAINED AND HEREBY ESTABLISHED
 ARE SHOWN BY VERTICAL BLACK FIGURES ENCLOSED IN A PARENTHESIS.
 EXISTING SURFACE ELEVATIONS HEREBY ABOLISHED ARE SHOWN BY VER-
 TICAL BLACK FIGURES ENCLOSED IN A PARENTHESIS AND CROSSED BY A
 BLACK LINE.

ELEVATIONS SHOWN ON THIS MAP ARE REFERRED TO THE
 PUBLIC WORKS DATUM OF THE BOROUGH OF MANHATTAN,
 WHICH IS 2.75 FEET ABOVE MEAN SEA LEVEL AT SANDY
 HOOK.

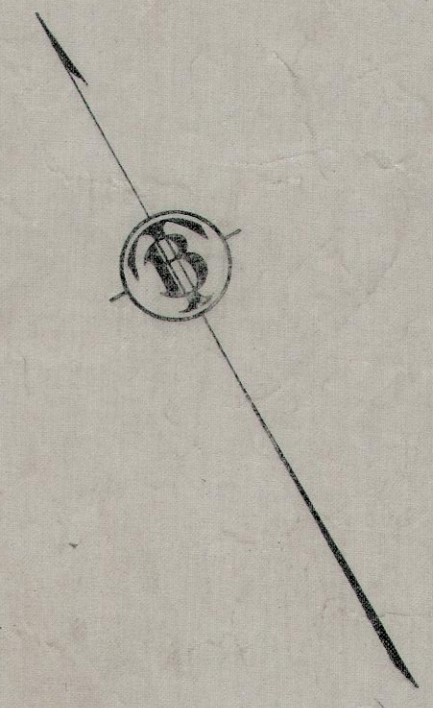

I, JOSEPH HAAG, SECRETARY OF THE BOARD OF
 ESTIMATE AND APPORTIONMENT OF THE CITY OF NEW YORK, DO HEREBY
 CERTIFY THAT THIS MAP IS ONE OF THREE SIMILAR MAPS MADE AT THE
 DIRECTION OF, AND ADOPTED BY THE SAID BOARD OF ESTIMATE AND
 APPORTIONMENT ON THE 15th DAY OF March 1918 AND
 APPROVED BY THE MAYOR ON THE 21st DAY OF March
 1918, SUPERSADING ALL MAPS HERETOFORE FILED AFFECTING THE AREA
 EMBRACED BY SAID MAP IN SO FAR AS IT MAKES ANY CHANGES THEREIN.
 PREPARED FOR THE BOARD OF ESTIMATE AND APPORTIONMENT
 UNDER AUTHORITY OF THE CHARTER OF THE CITY OF NEW YORK.
 DATED, NEW YORK, 1918

Joseph Haag
 SECRETARY, BOARD OF ESTIMATE
 AND APPORTIONMENT

CITY OF NEW YORK BOROUGH OF MANHATTAN
 OFFICE OF THE PRESIDENT
 BUREAU OF TOPOGRAPHY
CHANGE OF GRADE
43RD STREET
MADISON AVENUE TO TIMES SQ.

DATED SEPT. 27, 1917. SCALE 1" = 30 FT.

Charles H. Levy ASST. ENGINEER IN CHARGE
Frank H. Dowling PRESIDENT BOARD OF MANHATTAN

FILE NO. D 4. 21 Acc: No: 23261

DRAWN BY... H.K.
 CHECKED BY... A.L.
 EXAMINED BY...
Ho. Faebel
 ASSISTANT ENGINEER

RECEIVED FOR FILING
 MAY 20 1918
 G.L. FARRINGTON
 LIBRARIAN