

Drawn 34

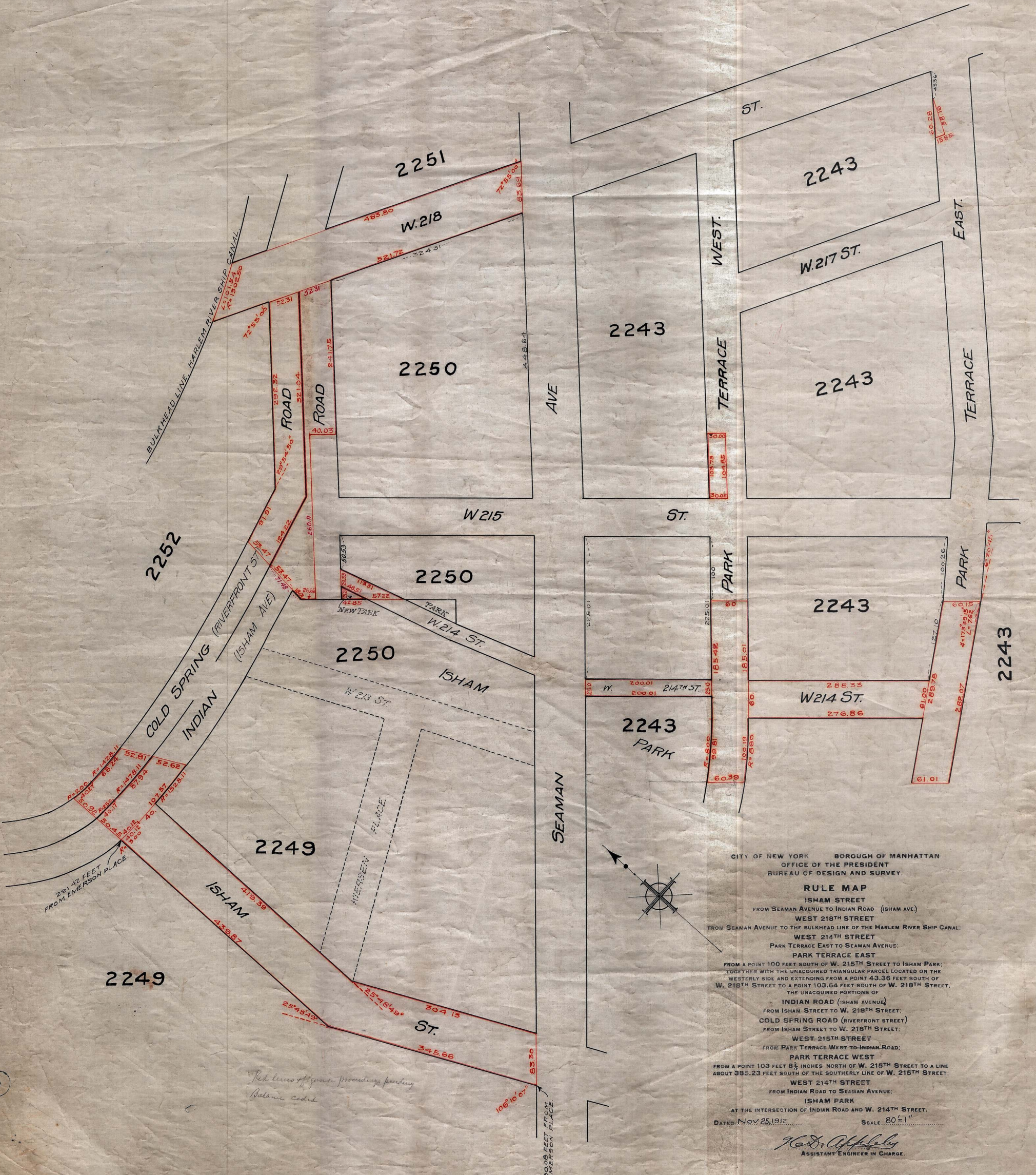

20.42 FEET
FROM EMERSON PLACE.

Red lines of former proceedings pending
Balance correct

500.00 FEET FROM
EMERSON PLACE

CITY OF NEW YORK BOROUGHS OF MANHATTAN
OFFICE OF THE PRESIDENT
BUREAU OF DESIGN AND SURVEY.

RULE MAP
ISHAM STREET
FROM SEAMAN AVENUE TO INDIAN ROAD (ISHAM AVE.)
WEST 218TH STREET
FROM SEAMAN AVENUE TO THE BULKHEAD LINE OF THE HARLEM RIVER SHIP CANAL;
WEST 214TH STREET
PARK TERRACE EAST TO SEAMAN AVENUE;
PARK TERRACE EAST
FROM A POINT 100 FEET SOUTH OF W. 215TH STREET TO ISHAM PARK;
TOGETHER WITH THE UNACQUIRED TRIANGULAR PARCEL LOCATED ON THE
WESTERLY SIDE AND EXTENDING FROM A POINT 43.36 FEET SOUTH OF
W. 218TH STREET TO A POINT 103.64 FEET SOUTH OF W. 218TH STREET,
THE UNACQUIRED PORTIONS OF
INDIAN ROAD (ISHAM AVENUE)
FROM ISHAM STREET TO W. 218TH STREET;
COLD SPRING ROAD (RIVERFRONT STREET)
FROM ISHAM STREET TO W. 218TH STREET;
WEST 215TH STREET
FROM PARK TERRACE WEST TO INDIAN ROAD;
PARK TERRACE WEST
FROM A POINT 103 FEET 8 1/2 INCHES NORTH OF W. 215TH STREET TO A LINE
ABOUT 385.23 FEET SOUTH OF THE SOUTHERLY LINE OF W. 215TH STREET;
WEST 214TH STREET
FROM INDIAN ROAD TO SEAMAN AVENUE;
ISHAM PARK
AT THE INTERSECTION OF INDIAN ROAD AND W. 214TH STREET.

DATED Nov 25, 1912. SCALE 80' = 1"

J. G. D. Applegate
ASSISTANT ENGINEER IN CHARGE.

File D59.21
X D 21.21

Acc. No. 20319.