

—Map or Plan of a—  
 —New Street,—  
 Commencing on the Northerly line  
 of Chambers Street, distant 426.7/100 feet  
 easterly from Broadway; and extending to  
 the Southerly line of Reade Street, distant 425.3/100 feet  
 easterly from Broadway.

Under Chapter 410, Laws 1882,  
 " Chapter 660, " 1893.

Jos. O. B. Weber  
 Ass. Eng. D. P. W.

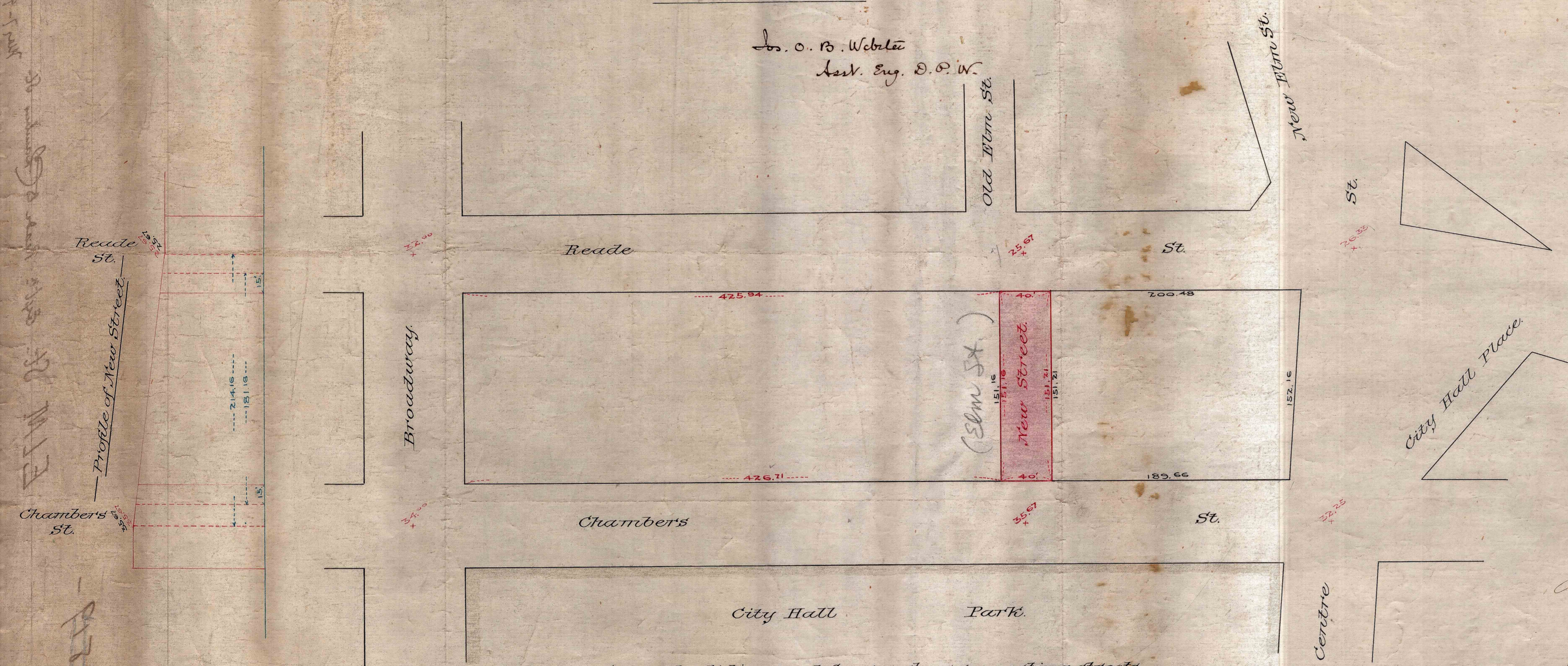

The Board of Street Opening and Improvement of the  
 City of New York, by and under authority of Chapter 660,  
 Laws of the State of New York passed May 9<sup>th</sup> 1893, does  
 hereby certify that this Map or Plan is one of three maps  
 or plans in all respects similar, which this Board has  
 caused to be made and has directed to be filed in the  
 manner provided by said Act, showing the New Street  
 to be known as commencing on the  
 northerly line of Chambers Street, distant 426.7/100 feet  
 easterly from Broadway, and extending to the  
 southerly line of Reade Street, distant 425.3/100 feet easterly  
 from Broadway; with grades fixed and established  
 for said Street and for connecting streets; in the 6<sup>th</sup>  
 Ward of the City of New York, as laid out and opened  
 by this Board on the 7<sup>th</sup> day of May 1897.

Note:—Street laid out, and Grades fixed and  
 established, colored Red.

*W. S. Strong* Mayor,  
*Alfred P. Koch* Comptroller,  
*Charles A. Collins* Com<sup>r</sup> of Public Works,  
*Samuel M. Sullivan* Pres<sup>t</sup> of Public Parks,  
*John J. ...* Pres<sup>t</sup> of Board of  
 Aldermen.

*L. B. Livingston* Secretary.

Note:—Black lines and figures, show connecting streets  
 and their established grades.  
 New Street laid out, and Grades fixed and estab-  
 lished, shown in Red lines and figures.  
 Elevations, above City Base.  
 Horizontal distances between grades, shown in Blue.